

plumbers choice

TRADE
ONLY

EASTER EGG HUNT

Good Luck
finding these
ones mate!

WIN*

TRADE
ONLY

TELL US HOW MANY EASTER EGGS
ARE IN THE CATALOGUE TO WIN*

489 Mountain Highway, Bayswater, VIC 3153

Email: info@plumberschoice.com.au • Ph: (03) 9720 8274

www.plumberschoice.com.au

EDITION
198
MAR - APR

Clinton's Editorial

The great Easter Egg Hunt!

Easter is a time that usually revolves around family, a well-earned break, and in many households a fiercely competitive Easter egg hunt. It's also a reminder that behind every plumbing business is more than just tools and job sites. There are families, overheads, and the constant balancing act of running a profitable trade business.

That's why Plumbers Choice has always remained proudly Trade Only. By supplying exclusively to plumbers, we help protect your margins, minimise unnecessary price competition, and ensure you're never competing with your own supplier. Simply put, we don't sell to your customers, because they're your customers.

And since Easter is all about family and every plumbing business has one behind it we've hidden eggs throughout this catalogue for the little one's to find. Count them up and enter the draw for your chance to win.

Simply email how many Trade Only eggs you think are hidden to marketing@plumberschoice.com.au and all the correct guesses will go into the draw to win a \$200 Toyworld voucher.

CLINTON THOMAS
GENERAL MANAGER, PLUMBERS CHOICE

plumbers
choice 



Shop
Trade Only
Anywhere
Anytime!

How to Order

Come in and see our knowledgeable staff at our Trade Outlets - Monday - Friday
489 Mountain Highway, Bayswater, VIC
4/200 Woodpark Road, Smithfield, NSW

Or shop Trade Only the way that suits you...



Your Personal Sales Rep
We're able to tailor our service to suit your needs.



Email your order to:
sales@plumberschoice.com.au



Call Sales
03 9720 8274
Our knowledgeable staff will take your order.



Order on our NEW App
Order Anytime, Anywhere

www.plumberschoice.com.au

PATENT PENDING

The most versatile pipe clip on the market

NEW



PythonClip

Code: 5541

- Suits any pipe up to 60mm
- With preloaded HEX screw & cable tie

100
BAG

FREE

Every bag comes with a FREE 1/4 INCH MAGNETIC NUT SETTER



For Timber & Metal Fixing



RED BACK

Nylon Thread Seal Cord



**New,
easier to
use palm
size**

- Suitable for Cold, Hot & Potable Water
- Approved for Natural Gas, Butane & LPG
- **Class 3** AGA 9184 G
- AS4623 - 2008
- **Temp Range: -10c to 150c**
- **Pressure Rating: 2000kPa**



50m
\$20.72
INC. GST
Code: 5632

150m
\$39.74
INC. GST
Code: 5633



BRASS COLOURED TEFLON TAPE

- Approved for water, natural gas and LPG
 - Max pressure gas 690kPa
 - Max pressure water 2000kPa
 - Temperature range -10°C to 135°C
 - 6.6m L x 12.7mm W
- Code 1548**

NEW



PERFECT COLOUR MATCH!

BRASS COVER PLATES



All Brassware complies with AS3688



Cover Plate Backing Foam
Code 4009



- Suits Cover Plates OD of 70mm
- Adhesive backing for sticking to Cover Plate

Rough Brass FLAT Coverplate

1/2" BSP
Code 4050
3/4" BSP
Code 4051

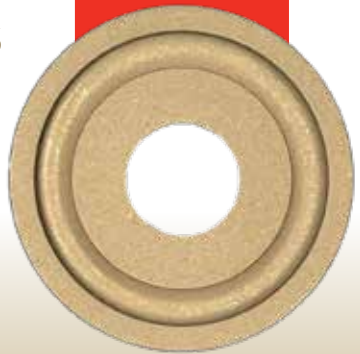

70mm



PER 1

Rough Brass for Corrugated 1/2" BSP
Code 4005

- Foam backing moulds to corrugate
- Rough brass finish to match hose bibs



Rough Brass Cover Plate

- Rough brass finish to match hose bibs

1/2" BSP Code 4001 **3/4" BSP** Code 4002



BRASS HOSE BIBS



HOSE BIB LEVER HANDLE 1/4 TURN FI

CODE	SIZE	PRICE (INC. GST)
3671	15mm	\$15.13
3672	20mm	\$18.60



HOSE BIB LEVER HANDLE 1/4 TURN MI

CODE	SIZE	PRICE (INC. GST)
3664	15mm	\$13.53
3667	20mm	\$16.65



HOSE BIB LEVER HANDLE DOUBLE OUTLET MI

CODE	SIZE	PRICE (INC. GST)
3669	15mm	\$27.02
3670	20mm	\$31.02



HOSE BIB T/HEAD MI

CODE	SIZE	PRICE (INC. GST)
3660	15mm	\$13.65
3661	20mm	\$14.85



HOSE BIB T/HEAD FI

CODE	SIZE	PRICE (INC. GST)
3662	15mm	\$13.65
3659	20mm	\$16.40



HOSE BIB T/HEAD BACK PLATED MI

CODE	SIZE	PRICE (INC. GST)
3663	15mm	\$17.57



HOSE BIB MI WITH VACUUM BREAKER

CODE	SIZE	PRICE (INC. GST)
3668	15mm	\$24.63



No more wrestling with PEX Coils

Messy coils of PEX? A thing of the past, on-site or in the ute!

- Protects pipe from cuts and abrasions
- Protects coils from UV damage
- Made from Rip Stop Vinyl

Suits coil up to 16mm x 100m or 20mm x 50m



Heavy duty zip



Sturdy carry handle

CODE:8008 **\$139³⁴** INC.GST



plumtool™

PEX PIPE BAG

BULK SPECIAL

PICK YOUR BONUS!



PURCHASE ANY BOX OF PEX CLIPS & RECEIVE...

WITH ANY BOX OF PEX CLIPS

CHOOSE YOUR **BONUS** plumtool™

CODE: 8011



500MM PVC PIPE SAW

OR

RAPID BORE BIT 25MM



CODE: 9152

OR



PEX PIPE CUTTER

CODE: 1510

VALID UNTIL 30TH APRIL 2026

CLIPS FOR EVERY APPLICATION!

TIMBER



DUALPEX Jay Type Timber Screw

Code	Size	Qty
5588	16 & 20mm	25



DUALPEX with Tab Twisted Nail

Code	Size	Qty
5549	16 & 20mm	100



DUALPEX Twisted Nail

Code	Size	Qty
7895	16 & 20mm	100



Saddle for Pex Timber Screw

Code	Size	Qty
4524	16mm	100
4525	20mm	100



Saddle for Pex with Tab Timber Screw

Code	Size	Qty
4532	16mm	100
4533	20mm	100



DUALPEX Timber Screw

Code	Size	Qty
5568	16 & 20mm	100



Saddle for Pex with Tab Timber Twist Nail

Code	Size	Qty
4530	16mm	100
4531	20mm	100



Saddle for Pex Timber Twisted Nail

Code	Size	Qty
4528	16mm	100
4529	20mm	100



Stud Clip Twisted Nail

Code	Size	Qty
5573	16mm	100
5574	20mm	100

STEEL



DUALPEX with Tab Self Drilling Screw

Code	Size	Qty
5575	16 & 20mm	100

ONE CLIP FITS 2 PIPE SIZES!

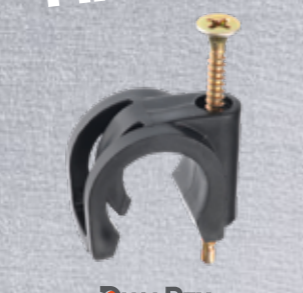

DUALPEX Self Drilling Screw

Code	Size	Qty
5558	16 & 20mm	100



Saddle for Pex Self Drilling Screw

Code	Size	Qty
4521	16mm	100
4522	20mm	100
4523	25mm	100



Stud Clip Self Drilling Screw

Code	Size	Qty
5571	16mm	100
5572	20mm	100



Saddle for Pex with Tab Self Drilling Screw

Code	Size	Qty
4526	16mm	100
4527	20mm	100

TIMBER + STEEL



DUALPEX Hex Head Duo Screw

Code	Size	Qty
5577	16 & 20mm	100



DUALPEX with Tab Hex Head Duo Screw

Code	Size	Qty
5578	16 & 20mm	100



DUALPEX Jay Type Hex Head Duo Screw

Code	Size	Qty
5589	16 & 20mm	25



DUALPEX Stud Clip Hex Head Duo Screw

Code	Size	Qty
5569	16 & 20mm	100



Quick Clip

Code	Size	Qty
7390	14-18mm	100
7391	20-25mm	100



Saddle for Pex Hex Head Duo Screw

Code	Size	Qty
9075	16mm	100
9076	20mm	100

FREE DRIVER BIT

Get your **FREE 1/4 INCH MAGNETIC NUT SETTER** with every Hex Head bag



MASONRY



DUALPEX with Tab Masonry Nail

Code	Size	Qty
5551	16 & 20mm	100



Saddle for Pex with Tab Masonry Nail

Code	Size	Qty
9057	16mm	100
9058	20mm	100



DUALPEX with Nylon Anchor Masonry Nail

Code	Size	Qty
7896	16 & 20mm	100



Saddle for Pex with Nylon Anchor Masonry Nail

Code	Size	Qty
7898	16mm	100
7899	20mm	100
7897	25mm	100



Saddle for Pex Masonry Nail

Code	Size	Qty
9056	25mm	100
9059	32mm	25



DUALPEX Yellow Masonry Nail

Code	Size	Qty
5530	25 & 32mm	25



Saddle for Pex Yellow Masonry Nail

Code	Size	Qty
9040	16mm	100
9041	20mm	100
9042	25mm	100
9043	32mm	25
9044	40mm	25



Saddle for Copper Masonry Nail

Code	Size	Qty
9030	1/2 Inch	100
9031	3/4 Inch	100



DualCopper Masonry Nail

Code	Size	Qty
9029	1/2 & 3/4 Inch	100



Saddle for Poly Pipe Masonry Nail

Code	Size	Qty
9050	25mm	25

EVERYDAY HEROES

Best sellers for a reason, grab yours today!



DUALPEX with Nail

16 & 20mm
Qty 100 • Code: 5559



Saddle for Pex with Nail

16mm
Qty 100 • Code: 9054
20mm
Qty 100 • Code: 9055

STEEL STUDWORK?

plumbers choice
HAS THE ANSWERS!



Red
Suits 34mm
Holes

CODE: 9241



Green
Suits 25mm
- 28mm Holes

CODE: 8241

NEW

Green Grommets - Suitable for those pre-punched holes

plumtool™

Multi-Fit Grommets

- Grommets work in varying thickness of studwork (0.42mm to 2mm)
- Complies to Australian Standards AS3500.1 12 Clause 5.5 2.2 Part C
- Available as bags of 100



Fastanog Block

Preloaded With Bugle Screw

- Made from tough Polypropylene
- 4 times faster

CODE: 1475



*Ditch the timber.
Get it done quicker.*

FASTANOG

- Zinc plated steel noggin
- Compulsory in termite areas
- Set back measurer



Mini Preloaded
with Bugle Screws
190mm - 330mm
Code: 1474



Preloaded
with Hex SD Screws
330mm - 600mm
Code: 1471



Unloaded
330mm - 600mm
Code: 1450



Steel Stud Drill

Also great in roofing work for overflows, etc



58mm
For drainage vents

CODE: 2001

34mm
Suits red grommets

CODE: 2000



*Punch through steel.
Job done super fast.*



plumtool™

Stud Punch

- 34mm hole
- Suits standard 0.5mm steel studs

CODE: 1914

PLUMBING SUPPLIES IN YOUR POCKET



Access 3,000+ products anytime, anywhere.

Order what you need in seconds. Whether you're on site, on the road, or planning ahead.



FREE Delivery
Order \$150+



Manage Your Account



Promotions & Specials

DOWNLOAD. LOGIN. START ORDERING TODAY!



Available on the iPhone
App Store

ANDROID APP ON
Google play

SupaFlex

POLYAMIDE WATER CONNECTORS

LEAD FREE

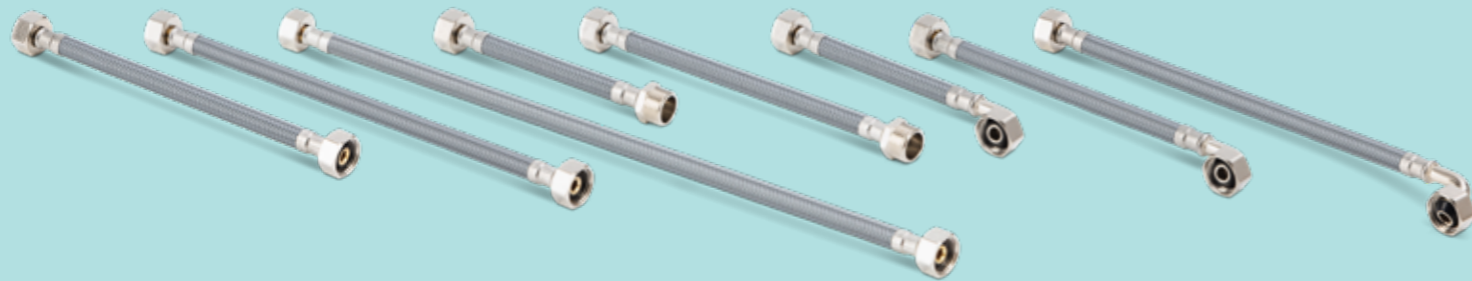

25
YEAR WARRANTY

Polyamide Braided outer hose for improved flexibility and superior resistance to rust and corrosion



Durable PEX inner core with 8mm bore to prevent bursts



Potable water safe with the inclusion of lead free brass nuts



**Pressure safe up to: 1500 kPa
Operating temp: 1-80°C**

POLYAMIDE WATER CONNECTORS

Length	Connection	Code Per 1	Code Box 25
225mm x 12mm	F&F	2660	2669
300mm x 12mm	F&F	2661	2670
450mm x 12mm	F&F	2662	2671
600mm x 12mm	F&F	2663	2672
225mm x 12mm	Bent Elbow	2666	2675
300mm x 12mm	Bent Elbow	2667	2676
450mm x 12mm	Bent Elbow	2668	2677
		Per Pair	Box 20
150mm x 12mm	M&F	2664	2673
225mm x 12mm	M&F	2665	2674



Stop Tap Loose Nut

- Fitquik swivel nut
- Ceramic disc



Stop Tap Loose Nut with Non Return Valve

- Fitquik swivel nut
- Ceramic disc



Stop Tap Loose Nut Tri Valve

- Dishwasher**
- Dishwasher installs made easy
- Reduces the chance of leaks



Stop Tap Modular 1/4 Turn

- Individually tested & watermarked
- Quality ceramic disc



Stop Tap Modular Tri Valve 1/4 Turn

- Ceramic disc



Stop Tap Mini

- Traditional mini stop with jumper valve

Stop Tap 1/4 Turn Lever Handle
Black

- Ceramic disc



Stop Tap 1/4 Turn PLV 350kPa

- 360° Swivel Outlet**
- PLV set at 350kPa



Stop Tap Tri Valve 1/4 Turn

- Ceramic disc
- Six fittings in one



Stop Tap 1/4 Turn

- Individually tested & watermarked
- Quality ceramic disc

ALL STOP TAPS LEAD FREE



ICCONS®

Meet ICCONS®

Roof & Wall All Stars

Fasteners that lead the field in speed and reliability!

ROOF-STARS®

Roof-Stars® are a self-drilling universal roofing screw with an EPDM sealing washer designed for fastening metal roof sheet to steel purlins, thin metal battens or timber battens, making it the 'all-star' of steel roof construction.



WALL-STARS®

Wall-Stars® are a self-drilling universal cladding screw with or without an EPDM sealing washer, designed for fastening cladding to steel purlins, thin metal battens or timber battens.

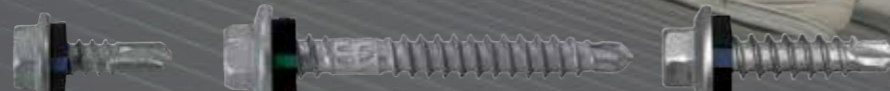

COLOUR

NOT PAINTED	
BASALT®	BA
BLUEGUM®	BG
CLASSIC CREAM™	CC
COTTAGE GREEN™	CG
DEEP OCEAN®	DO
DOVER WHITE™	DW
DUNE®	DU
EVENING HAZE®	EH
GULLY®	GU
IRONSTONE	IS
JASPER®	JA
MONUMENT®	MO
MANOR RED®	MR
NIGHT SKY®	NS
PAPERBARK®	PA
PALE EUCALYPT®	PE
SHALE GREY™	SG
SURF MIST®	SM
SOUTHERLY®	SO
WALLABY®	WA
WOODLAND GREY®	WG
WINDSPRAY®	WS

CODE

SELF DRILLING HEX HEAD	ROOFSTAR®			WALL-STARS®
16mm x 10G (QTY: 1000)	50mm x 13G (QTY: 1000)	65mm x 13G (QTY: 1000)	25mm x 12G (QTY: 500)	
1354	2700	2553	9504	
2203	2724	2537	2374	
2290	2734	2550	2241	
2229	2703	2547	1693	
2206	2704	2546	2357	
2208	2705	2536	2370	
2291	2735	2549	2243	
2209	2706	2545	2267	
2210	2707	2552	1891	
x	2726	2551	2376	
2231	2709	2539	1717	
2213	2710	2544	1708	
2216	2713	2530	1893	
2215	2712	2538	2003	
2217	2714	2535	2369	
2219	2715	2540	2358	
2218	2716	2543	2316	
2197	2719	2532	2365	
2223	2720	2531	1301	
2292	2736	2548	2244	
2225	2729	2541	2402	
2228	2723	2533	2372	
2227	2722	2534	2295	

The ICCONS® painted screw range is available in colours matched to popular COLORBOND® steel shades. Other screws and colours can be requested. Colour samples are for reference only. COLORBOND® and ® colour names are trademarks of BlueScope Steel Limited. ABN 16 000 011 058. All rights reserved.

FLEXY FLANGES

CUPBOARD PLATES

- For a professional finish inside the cupboard.
- Flexy Flange cupboard plate fits tight to pipe which makes it ant-proof.

1 Flexy Flange Fits 4 Sizes!



80mm

Suits 9-22mm pipe

Small

Pack Qty 10

\$24.22 INC. GST

Code: 8250

PATENTED

Copper 1/2" Rehau 16mm Sharkbite 20mm 1/2" BSP (22mm)

90mm

Suits 22-44mm pipe

Medium

Pack Qty 5

\$16.09 INC. GST

Code: 8252

PATENTED

Corrugated Copper Hose

105mm

Suits 40-60mm pipe

Large

Pack Qty 5

\$17.92 INC. GST

Code: 9968

PATENTED

40mm Pipe 40mm Socket 50mm Pipe 50mm Socket

115mm

170mm

Suits 40-60mm pipe

Rectangle

Pack Qty 5

\$23.83 INC. GST

Code: 2202

PATENTED

40mm Pipe 40mm Socket 50mm Pipe 50mm Socket

ALL PVC
COMPLIES
WITH
ASNZ1260

SPECIAL

PVC FITTINGS

MUST BE PURCHASED IN BAGS OF 10

ONLY
\$1.10
EACH
INC GST

 <p>WEATHERING APRON DWV Size 50mm CODE: 2633</p>	 <p>BEND PLAIN M/F DWV 45 Degree Bend Size 40mm CODE: 2815 Size 50mm CODE: 2817</p>	 <p>BEND PLAIN M/F DWV 88 Degree Bend Size 40mm CODE: 2816 Size 50mm CODE: 2818</p>	 <p>COUPLING PVC THREADED MI Size 40mm CODE: 2823 Size 50mm CODE: 2825</p>
 <p>TRAP ADAPTOR Size 32-40mm CODE: 2795</p>	 <p>BEND PLAIN F/F DWV 45 Degree Bend Size 40mm CODE 2806 Size 50mm CODE 2807</p>	 <p>BEND PLAIN F/F DWV 88 Degree Bend Size 40mm CODE: 2808 Size 50mm CODE: 2809</p>	 <p>COUPLING PVC THREADED FI Size 40mm CODE: 2822 Size 50mm CODE: 2824</p>
 <p>VENT COWL Size 50mm CODE 2829</p>	 <p>SOCKET DWV F/F Size 40mm CODE: 2810 Size 50mm CODE: 2812</p>		

Valid until 30th April 2026

GRAB YOUR PVC ACCESSORIES

INTERNAL PVC CUTTER ADJUSTABLE DEPTH

- Durable guide creates reliable straight cuts
- Laser etched depth markings
- Long lasting replaceable diamond blade
- Cuts all PVC above 40mm

SET YOUR CUTTING DEPTH



\$72.38
INC. GST

CODE: 1357



NEW

MONUMENT



AUTOCUT PIPE CUTTER

Ideal for confined spaces

40mm PVC
\$56.38
CODE 2644

50mm PVC
\$59.02
CODE 2645

SAMURAI



\$19.51
CODE 9632

RECIPROCATING SAW BLADE

- Specifically designed for cutting PVC pipe
- Cuts straight
- Made in Japan
- 210mm

plumtool™



\$70.69
CODE 5609

SOLVENT MATES APPLICATORS

- For use in joining PVC pipes and fittings
- No more harsh contact with chemicals

plumtool™

INTERNAL PIPE CUTTER WITH DIAMOND WHEEL

- Will cut pipe from 40mm up to 150mm
- Diamond wheel will not blunt on concrete or tiles

\$48.93
CODE 1347



Coverplate 1/2" faves

1/2 inch BSP cover plates to suit every need



67mm

NEW

**10mm Rise
1/2" BSP
Brushed Nickel**

Pack Qty 1 Code: 4007



**Flat
1/2" BSP
Chrome**

- Chrome plated suits mini stops
- Solid stainless steel

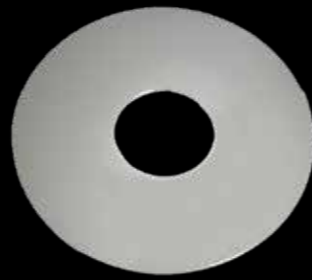

67mm

Pack Qty 1 Code: 4209

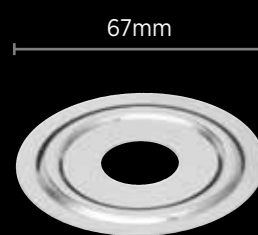

67mm

Flat 1/2" BSP

Pack Qty 50 Code 9154



67mm

10mm Rise 1/2" BSP

Pack Qty 50 Code 9153



72mm

16mm Rise 1/2" BSP

Pack Qty 10 Code 1652



72mm

22mm Rise 1/2" BSP

Pack Qty 10 Code 1653



65mm

34mm Rise 1/2" BSP

Pack Qty 1 Code 1649



**Flat 1/2" BSP
Black**

Pack Qty 1 Code 4018



**10mm Rise 1/2" BSP
Black**

Pack Qty 1 Code 4015



**10mm Rise 1/2" BSP
White Metal**

Pack Qty 1 Code 4013



**1/2" BSP
White Plastic**

Pack Qty 50 Code 1775



**Flat Adhesive
1/2" BSP White Plastic**

Pack Qty 10 Code 4909



**Flat Square
1/2" BSP
Black**

Pack Qty 1 Code 4025



**10mm Rise Square
1/2" BSP
Black**

Pack Qty 1 Code 4026



**Flat Square
1/2" BSP**

Pack Qty 10 Code 4011

**CHROME
PLATED
ABS PLASTIC**



**10mm Rise Square
1/2" BSP**

Pack Qty 2 Code 4010

**STAINLESS
STEEL**

Are you complying with

AS/NZS 3500.1 C1 9.7.2



COVER PLATE LABELS

PER 10

- Suit any 1/2", 5/8" or 3/4" Centre Cover Plate
- Self-Adhesive
- UV Stable
- Can be retrofitted

48mm Diameter



48mm

'Rainwater'
White on Green

CODE: 4901



**'Recycled Water
Do Not Drink'**

White on Lilac

CODE: 4904



'Rainwater'
Green on Clear

CODE: 4902



**'Rainwater
Do Not Drink'**

Green on Clear

CODE: 4903

STAINLESS PRINTED COVER PLATES

PER 1

- Suit Rainwater
- Stainless Steel
- UV Stable

67mm Diameter



67mm

'Rainwater'
White on Green

CODE: 4905



'Rainwater'
Green on Clear

CODE: 4907



**'Recycled Water Do
Not Drink'**

White on Lilac

CODE: 4906

WHITE PRINTED COVER PLATES

PER 10

- UV Stable

73mm Diameter



73mm

'Rainwater'
Green on White

CODE: 8562



**'Recycled Water
Do Not Drink'**

Lilac on White

CODE: 1579



DRAINAGE PLUGS

Inflatable Test Plugs

- 2.5m Hose with Schroeder Valve
- Can be used down an inspection shaft
- Fully deflate before removing from pipe
- Inflate with Plumtest Inflatable Test Plug Pump

40 MM	50 MM	100 MM	150 MM
\$105.05	\$114.27	\$139.92	\$186.56
9008	9006	2009	2009



\$162.35
2004



Test Plug Right Angled with Handles

- The only plug to use when testing at a right angled junction
- Keeps hands out of drains
- Cast Aluminium
- Patented

Test Plug Aluminium

- 2 convenient tie-off points
- A breeze to install



90 MM \$68.56 (8765)
100 MM \$56.01 (2149)

Inflatable Test Plug Pump

- Can't over-inflate
- Hand pump

\$95.61 (2104)



Now distributed by
MANTA
INNOVATIONS

LOOSE NUT

Right Angle Gas Ball Valve

MxF 15mm

- Eliminates extra fittings on installation
- Saves installation time
- Uses less space than a traditional installation
- AGA approved

Code: 8098



RIGHT ANGLE

Gas Ball Valve

MxF 15mm



Code: 8099



STACK-ABLE SORTING BIN

Ideal for sorting and organising small fittings

- Sorting bins can be stacked on top of each other or side by side
- Bins include 4 pegs for stacking



Can be divided into 2 with divider
420 x 370 x 175mm



Can be divided into 3 with dividers
420 x 370 x 175mm



Divide storing bins for extra storage options
\$3.30 INC. GST
CODE: 2692
*Divider only. Sorting bin not included.



FRAMING STIFFENER PLATE



Are you complying with AS 1684.2 2021?

When holes for waste pipes or vents are drilled through top or bottom timber plate it must be reinforced.

- Framing Stiffener Plate is made from quality **heavy gauge 1.55mm Galvanised Steel**
- The Framing Stiffener Plate can be fitted above the timber plate if required



CODE: 2738

FRAMING STIFFENER PLATE



Kit includes:

1 x Frame Stiffener Plate
12 x Type 17 35mm x 12G Z/Yellow Screws



CODE: 2739

FRAMING STIFFENER PLATE Retrofit



Can be fitted around existing pipework

Kit includes:

1 x Pair Frame Stiffener Plate Retrofit
12 x Type 17 35mm x 12G Z/Yellow Screws

LITTLE PLUMBERS PLAYGROUND



Spot the difference

Colour in + design your own



Design your own Easter Egg

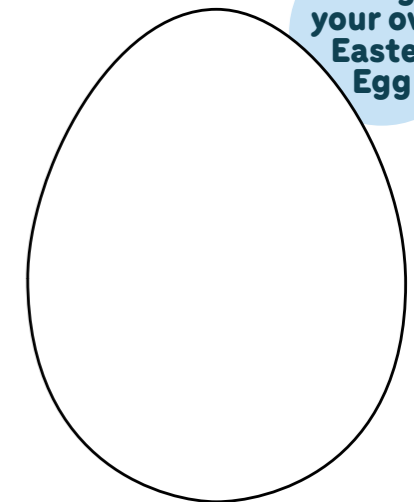

tip of the month

To get involved send us an email info@plumberschoice.com.au

Every featured story receives **\$200 Store Credit**



Use the black tool that comes with the Plumbers Choice mixers to undo and tighten your stand off brackets and hangers.

Courtesy of Tyson Henderson, Henderson Plumbing

Thanks mate, we'll be sending you \$200 store credit

LUGGED ELBOW EXTENDERS



Lugged Elbow Extender Kit **CODE: 1786**
 • Franz tap • Brush • Allen Key • 4 Extenders

Finally a solution for extending brass threads

the problem...

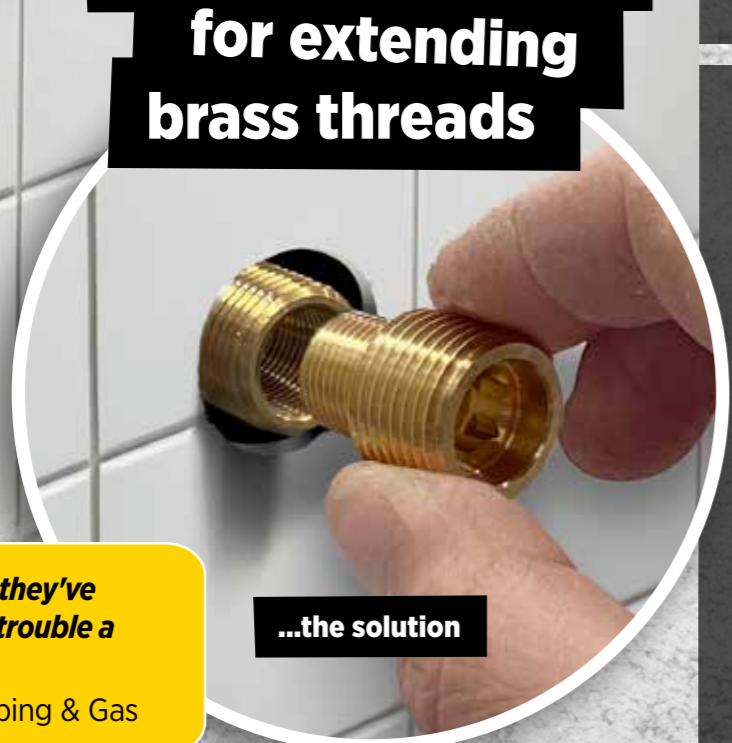

...the solution

These are great, they've gotten us out of trouble a couple of times!
 Dave - Vic Plumbing & Gas



6 Pack Lugged Elbow Extenders **CODE: 1787**

- Using the provided tap, cut a thread inside the lugged elbow, taking care to make the thread straight
- Use the brush to remove all loose brass from inside the lugged elbow
- Apply Wonderjuice or similar to thread of adapter
- Tighten extender into lugged elbow with allen key

WONDER JUICE



UNLIKE OTHERS WONDER JUICE LID WON'T POPOFF

New generation product for sealing and locking brass and steel threads. Wonder Juice can be used as a replacement for teflon and hemp.

- No more leaks
- Rated up to 3000 kPa
- Sets hard, so it will never work loose
- Heat range -50C to 150C
- Environmentally friendly/non-flammable
- SGS approved for drinking water and air lines
- AGA approved for use on NG, LPG, TG & LLPG

Code: 9234 **\$17.86 per tube**



SCREW CAP



TRUSTED BRAND

ROOF & GUTTER SILICONE



- Bostik Quality
- Ideal for sealing sheet metal, roofing & guttering
- Potable water approved AS4020-1999
- Neutral Cure
- Non-Corrosive

**BOX
QTY
20**

GREY
300ml



Code: 9953

BLACK
300ml



Code: 9812

TRANSLUCENT
300ml



Code: 9926

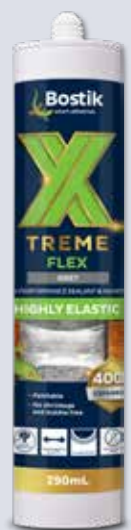

SILICONE - XTREME

- UV resistant, absorbs acoustic and mechanical vibrations
- Highly flexible with up to 400% elongation
- Sticks and seals all common building materials, even in the wet
- Interior & exterior use

GREY
290ml



Code: 8225

**BOX
12**

WHITE
290ml



Code: 9845

**BOX
12**

BLACK
290ml



Code: 8226

**BOX
12**



TURN UP TOOLS - JOB DONE!

plumtool™

**THE FASTEST
TURN UP TOOL
FOR TRAY DECK
ROOFING!**



CODE: 6420

\$222⁷⁵
INC. GST

MULTI HEAD WHALE TOOL

- Turn up 5 corrugations all at once. 2 turn up operations per sheet
- 2 handle sockets for different roof pitches
- Inc. 550mm handle



WHALE TOOL

- Fast, lightweight tool for weathering corrugated sheets
- Heavy duty



CODE: 6421

\$78¹⁷
INC. GST

HINGED TURN UP TOOL

- The fastest turn up tool for tray deck roofing
- Hinged design opens wide for fast application
- The perfect height turn up every time

125mm

CODE: 2151

\$149³¹
INC. GST



150mm
DECK



185mm

CODE: 9864

\$168⁰⁴
INC. GST

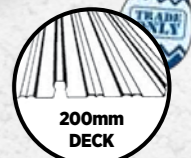

200mm
DECK

TURN UP TOOL

7pc KIT



Kit Contains:

- 4 Interchangeable heads
- Turn up & turn down attachment for 150mm decks
- Turn up & turn down attachment for 200mm decks
- 2 x 550mm handles
- 1 x 250mm handle
- PVC storage container

CODE: 1754

\$297⁴⁴
INC. GST



200mm
DECK



150mm
DECK

downpipe fixing can be tricky, but we have the answers

Hebel Anchor

Spiral-shaped ribs cut a positive fit in hebel



- The spiral-shaped outer ribs cut a positive fit in the soft building material
- Pre-drill with a 8mm drill bit
- Adapted for wood, self-tapping and chipboard screws of 4.0 to 5.0 diameter

8mm
\$71.50 INC. GST
CODE 1295
BAG QTY: 50

Styrowedge

Great for fixing downpipes to foam walls

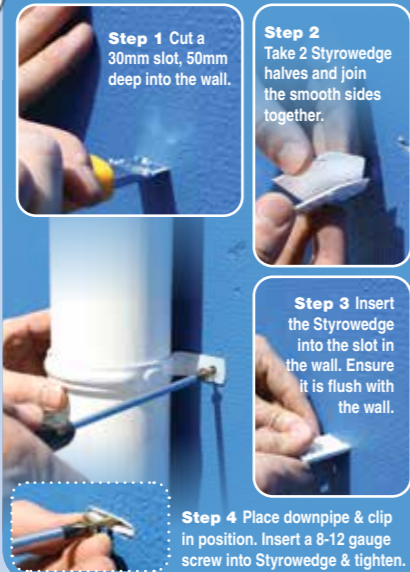
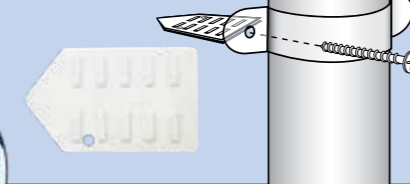

Step 1 Cut a 30mm slot, 50mm deep into the wall.

Step 2 Take 2 Styrowedge halves and join the smooth sides together.

Step 3 Insert the Styrowedge into the slot in the wall. Ensure it is flush with the wall.

Step 4 Place downpipe & clip in position. Insert a 8-12 gauge screw into Styrowedge & tighten.

\$58.42 INC. GST
CODE 1222
BAG QTY: 50

Styroscrew

A screw type fastening for polystyrene walls

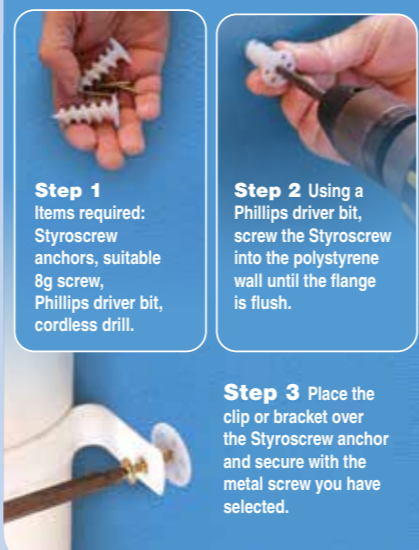
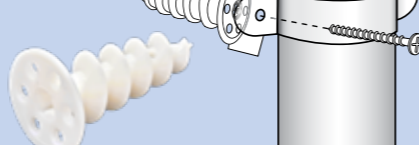

Step 1 Items required: Styroscrew anchors, suitable 8g screw, Phillips driver bit, cordless drill.

Step 2 Using a Phillips driver bit, screw the Styroscrew into the polystyrene wall until the flange is flush.

Step 3 Place the clip or bracket over the Styroscrew anchor and secure with the metal screw you have selected.

\$70.29 INC. GST
CODE 1223
BAG QTY: 50



Start 2026 stronger with Master Plumbers.



Free Standards Access



Exclusive Discounts



Free Expert Advice



CPD & Training Support



Apprentice Hire Rebates



Member Only Events

master plumbers
Expert. Committed. Professional.



Make 2026 your best year yet. Scan now.

Find Your Local Master Plumbers at masterplumbersanz.com/members



TAP INS



Removable Phillips Head Screw

- UV Stabilised WILL NOT PERISH
- Decero coated nail WON'T RUST
- Passes 1000^{hr} salt spray test

Black Nylon Tap Ins with Removable Screw

5mm x 40mm • Qty 100 | Code 1180



Metal Tap Ins Mushroom Head

Code	Size	Qty
9387	5mm x 25mm	100
1967	6.5mm x 25mm	100
1968	6.5mm x 32mm	100
1705	6.5mm x 40mm	100



Nylon Tap Ins Round Head

Code	Size	Qty
9978	5mm x 25mm	100
9907	5mm x 25mm	500
9179	5mm x 40mm	100
9973	5mm x 40mm	500
9567	6.5mm x 25mm	100
2262	6.5mm x 40mm	100



Nylon Tap Ins - Black

• Round Head • For outdoor use

- UV Stabilised WILL NOT PERISH
- Decero coated nail WILL NOT RUST
- Passes 1000^{hr} salt spray test

Code	Size	Qty
9524	5mm x 25mm	500
1187	5mm x 40mm	500

SPECIAL



TEMPERING VALVES



\$49
INC GST

TEMPERING VALVE STANDARD 15mm AVG

• Suitable for hot water systems
CODE: 6810



\$70
INC GST

TEMPERING VALVE HIGH PERFORMANCE 15mm AVG

• Suitable for solar and instantaneous hot water systems
CODE: 6811

Valid until 30th April 2026

PAN HOLE COVER

Simple way to fill holes in toilet pans

Code: 4115

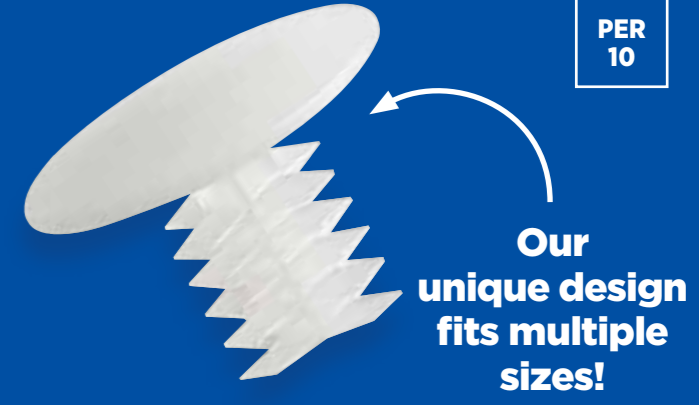

Patent Pending

100
PIECE

Cistern washer kit

Far more cost effective than carded washers

Contains 11 types of the most common washers

- 7 x 9603 Cistern Washer Doulton Top Hat Old Style Ballcock
- 4 x Cistern Washer Brent New Style
- 3 x Cistern Washers Replacement Fluidmaster (242)
- 5 x Cistern Washer Gebrit Seating Silicone
- 7 x Cistern Washer Doulton Top Hat New Style Ballcock
- 25 x Float Valve Washers 1/2 Inch
- 5 x Cistern Washer Doulton Concave Suction
- 7 x Cistern Washer 'K' Seating
- 15 x Cistern Washer Caroma Seating Red Silicone
- 7 x Cistern Washer Doulton Seating
- 18 x Cistern Washer Caroma New Style Ballcock #2



\$210.55
INC.GST
Code: 6687

COPPER & BRASS

PRESS FITTINGS

Flame-free

Permanent V-Profile press join

All fittings comply with Australian Standards AS3688

All Press Fittings are LEAD FREE



25 YEAR WARRANTY*

Against defects and manufacturing faults in CuPress fittings.

*when installed in accordance with national, state and local plumbing codes by a licensed plumber. Please contact Brasshards for a copy of our full warranty document.



BRASSHARDS

EST. 1967



PLUMBING SUPPLIES SPECIALIST

all prices include GST

GAS FITTINGS



Press Gas Coupling

Code	Size
8639	15mm
8640	20mm
8641	25mm



Press Gas Slip Repair Coupling

Code	Size
8642	15mm
8643	20mm
8644	25mm



Press Gas Elbow f/f 90°

Code	Size
8645	15mm x 90
8646	20mm x 90
8647	25mm x 90



Press Gas Elbow f/f 45°

Code	Size
8697	15mm x 45
8648	20mm x 45
8649	25mm x 45



Press Gas Reducing Coupling f/f

Code	Size
8650	20mm x 15mm
8651	25mm x 20mm



Press Gas Reducer m/f

Code	Size
8652	20mm x 15mm
8653	25mm x 20mm



Press Gas Tee

Code	Size
8654	15mm
8655	20mm
8656	25mm



Press Gas Tee Reducing

Code	Size
8657	20 x 20 x 15
8659	25 x 25 x 20



Press Gas End Cap

Code	Size
8660	15mm
8661	20mm
8662	25mm



Press Gas Elbow Lugged

Code	Size
8663	15mm x 15FI
8664	20mm x 20FI



Press Gas Elbow Lugged

Code	Size
8665	15mm x 15MI

EXCLUSIVE TO PLUMBERS CHOICE



Blockhead Press Gas Elbow Lugged (90mm)

15mm x 15MI
Code: 8698



Press Gas Elbow m/f

Code	Size
8770	15mm
8771	20mm



Press Gas Adaptor MI

Code	Size
8666	15mm x 15MI
8667	20mm x 20MI
8668	25mm x 25MI



Press Gas Adaptor FI

Code	Size
8669	15mm x 15FI
8670	20mm x 20FI
8671	25mm x 25FI

EXCLUSIVE TO PLUMBERS CHOICE



Press Gas Slip Tee

Code	Size
8693	20mm

WATER FITTINGS



Press Water Coupling

Code	Size
8601	15mm
8602	20mm
8603	25mm



Press Water Slip Repair Coupling

Code	Size
8604	15mm
8605	20mm
8606	25mm



Press Water Elbow f/f 90°

Code	Size
8607	15mm x 90
8608	20mm x 90
8609	25mm x 90



Press Water Elbow f/f 45°

Code	Size
8610	15mm x 45
8611	20mm x 45
8612	25mm x 45



Press Water Elbow m/f 90°

Code	Size
8681	15mm
8682	20mm



Press Water Reducing Coupling f/f

Code	Size
8613	20mm x 15mm
8614	25mm x 20mm
8542	18mm x 15mm
8543	20mm x 18mm



Press Water Reducer m/f

Code	Size
8615	20mm x 15mm
8616	25mm x 20mm



Press Water End Cap

Code	Size
8623	15mm
8624	20mm
8625	25mm



Press Water Adaptor FI

Code	Size
8636	15mm x 15FI
8637	20mm x 20FI
8638	25mm x 25FI



Press Water Adaptor MI

Code	Size
8633	15mm x 15MI
8680	15mm x 20MI
8691	20mm x 15MI
8634	20mm x 20MI
8635	25mm x 25MI



Press Water Tee Reducing

Code	Size
8620	20 x 20 x 15
8621	25 x 25 x 15
8622	25 x 25 x 20
8683	20 x 15 x 15
8684	20 x 15 x 20



Press Water Tee

Code	Size
8617	15mm
8618	20mm
8619	25mm

EXCLUSIVE TO PLUMBERS CHOICE

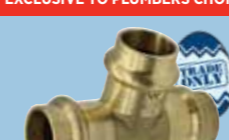

Press Water Slip Tee

Code	Size
8692	15mm
8690	20mm
8694	20 x 20 x 15



Press Water Elbow Lugged

Code	Size
8626	15mm x 15FI
8598	20mm x 15FI
8627	20mm x 20FI



Press Water Elbow Lugged

Code	Size
8628	15mm x 15MI



Blockhead Press Water Elbow Lugged (90mm)

15mm x 15MI
Code: 8699



Press Water Union Loose Nut (Flat seat)

Code	Size
8685	15mm x 15mm Press
8679	20mm x 20mm Press



Press Water Union Loose Nut Compression

Code	Size
8696	15mm x 15mm Press
8689	20mm x 20mm Press



Press Water Elbow MI

Code	Size
8631	15mm x 15MI
8632	20mm x 20MI



Press Water Elbow UNION

Code	Size
8687	15mm x 1/2"
8688	20mm x 3/4"



Press Water Elbow FI

Code	Size
8629	15mm x 15FI
8630	20mm x 20FI

Press Water Elbow Lugged 15mm x 15 MI Preloaded

- Preloaded with 30mm x 8g Phillips Head Chipboard Screws
- 25 year warranty*
- Permanent V-Profile press join profile
- Flame-free
- Complies with Australian Standards AS3688



15mm x 15MI
Preloaded (95mm)
Code: 7584

BRISTOL

Holds up to 150kg

Roof Safety Step

Easy 3 Step Installation • Provides increased safety

2406



Safer permanent access to rooftop

Permanent

Safety Brackets & Step

Leave in place for permanent safe access

- 2 x Powder Coated Stainless Steel Brackets
- 450mm Step, Powder Coated Aluminium Square Tube
- Fastenings included

2405



Reusable

Safety Bracket Pair

Provides safe access when installing roof

- 2 x Powder Coated Stainless Steel Brackets
- Fastenings included
- Suggested Timber size of 90 x 35mm (not included)

CHECK OUT OUR NEW CLEARANCE PAGE

CRACKING DEALS WHILE STOCKS LAST!

ITEMS ADDED REGULARLY



59mm

HOLE SAW TUNGSTEN

\$33

SAVE \$18.23

CODE: 8525
INC.GST



KINETIC WATER RAM - BASIC KIT

\$900

SAVE \$365

CODE: 2011
INC.GST



25-25-25mm

POLY RURAL TEE

\$19.46

SAVE \$11.69

CODE: 7106



15mm

TOP ASSEMBLIES RECESSED C/P

\$13.94

SAVE \$3.77

CODE: 7500
INC.GST



50mm

PRESS GAS SLIP REPAIR COUPLING

\$28.05

SAVE \$13.85

CODE: 7957
INC.GST



DUO VALVE LOOSE NUT TO COPPER OLIVE

\$11.00

SAVE \$11.94

CODE: 6862
INC.GST

AND MANY, MANY MORE....

WWW.PLUMBERSCHOICE.COM.AU/CLEARANCE

CLEARANCE SALE CLEARANCE SALE CLEARANCE SALE CLEARANCE SALE



zip clip

HANGING BRACKET

NEW

Zip it from 20mm to 100mm DWV

Rust proof and UV stabilised

Swivel head for quick alignment

450mm long shank

Product Code: 2828

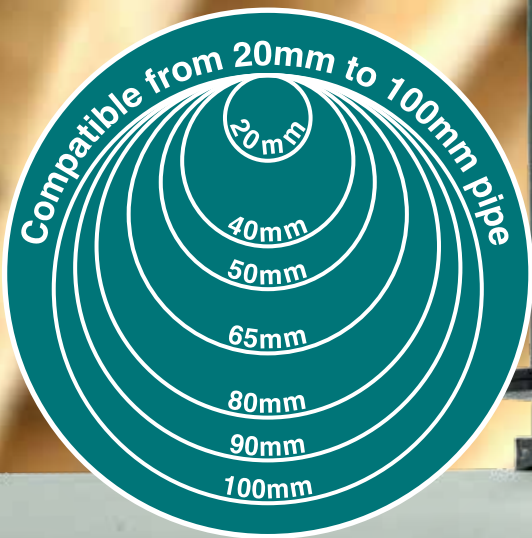

"Absolute game changer for drainage in confined spaces. Saves time, money and are incredible for anything for 20-100mm."

Simon Davis - Simmo's Plumbing & Coring

