

plumbers choice

TRADE
ONLY



489 Mountain Highway, Bayswater, VIC 3153

Email: info@plumberschoice.com.au • Ph: (03) 9720 8274

www.plumberschoice.com.au



Future little plumbers!

Thank you to each and every future little plumber who entered our cover competition. We were overwhelmed with the number of entries received, and it's great to see that the future of our industry is going to be in good hands.

So many future little plumbers understand the need for a Trade Only industry; we saw entries showing DIYers blowing themselves up, plumbers losing work to builders or handymen, plumbers fixing gas leaks caused by the public. It's extremely promising to see the future little plumbers understanding why we need a Trade Only industry and how it benefits plumbers today and future plumbers, tomorrow.

Special shoutout to our winner, 10 year old Scarlett, a future little plumber for MEK Plumbing in Victoria. Scarlett has drawn the Plumbers Choice shop, where our 25 years plus push for a Trade Only Industry continues.

CLINTON THOMAS
DIRECTOR, PLUMBERS CHOICE

plumbers
choice

Shop
Trade Only
Anywhere
Anytime!

How to Order

Come in and see our knowledgeable staff at our Trade Outlets - Monday - Friday
489 Mountain Highway, Bayswater, VIC
4/200 Woodpark Road, Smithfield, NSW

Or shop Trade Only the way that suits you...



Your Personal
Sales Rep



Order
on our
NEW
App



Email your
order to:
sales@plumberschoice.com.au



Call Sales
03 9720 8274

www.plumberschoice.com.au

WINNING COVER

SCARLETT.K
10 YR OLD - VIC

This future Little Plumber has WON a \$250 Toyworld voucher and a \$250 Plumbers Choice voucher for MEK Plumbing.

\$250 Toyworld Gift Card
\$250 plumbers choice Gift Card

HONORABLE MENTIONS



FUTURE
LITTLE
PLUMBERS

RED BACK

Nylon Thread Seal Cord



**New,
easier to
use palm
size**



- Suitable for Cold, Hot & Potable Water
- Approved for Natural Gas, Butane & LPG
- **Class 3** AGA 9184 G
- AS4623 - 2008
- **Temp Range: -10c to 150c**
- **Pressure Rating: 2000kPa**

50m
\$20.72
INC. GST
Code: 5632

150m
\$39.74
INC. GST
Code: 5633

AGA



The Ultimate
Safety Solution
for Plumbers

SAVE LIVES, SAVE MONEY

with Master Plumbers Safety Systems



Customised Work Health & Safety manual
+ SWMS for your business — available nationwide



Full setup, training and ongoing expert
support, tailored to your state



First year annual subscription
included



50% off for Master Plumbers
Members (VIC)



T&C's Apply.

Access this benefit and more by
joining Master Plumbers
Visit plumber.com.au to learn more.



masterplumbers
Expert. Committed. Professional.



plumtool™

HEX BIT HOLDER

with Carabiner

Keep all your Hex Bit Drives
handy and in reach

- Quick release
- Suitable for all 1/4 Hex Shank bits
- Aluminium alloy construction
- x 5 Clips and carabiner included

\$23.32

CODE: 6101



CLICK IN!
CLICK OUT!

**QUICK
RELEASE**



plumtool™

SDS BIT HOLDER

3 on Carabiner

- Quick release
- Aluminium alloy construction
- Clip & carabiner included
- Keep all your SDS Bits
handy and in reach

CODE: 6100

\$24⁷⁵

INC. GST

NEW



CLICK IN!
CLICK OUT!

**QUICK
RELEASE**



SPECIAL

PRESSURE REDUCTION VALVES



PRV BALL VALVE

- Combination 20mm PRV & isolation ball valve
- Controls the incoming water pressure to no more than 500kPa as per AS3500
- Superior flow capacity, 170 litres/min as per AS1357.2
- Stainless Steel Seat

CODE: 3600

\$46

INC GST

\$50

INC GST

PRV 20mm RA X PRESS PRESET 500KPA

- 20mm (3/4 inch) BSP female press

CODE: 3613

\$44

INC GST

PRV RIGHT ANGLE AVG

- 20mm (3/4 inch) BSP female by copper olive compression

CODE: 3602

\$44

INC GST

PRV RIGHT ANGLE AVG

- 20mm (3/4 inch) BSP female by flared compression

CODE: 3609

\$44

INC GST

PRV 20mm 250-605 KPA

- 20mm (3/4 inch) BSP F&F

CODE: 3603

PRV 25mm 250-605 KPA

- 25mm (1 inch) BSP F&F

CODE: 3612

\$104⁵⁰

INC GST

ALL feature

- Preset 500kPa
- Stainless Steel Seat



Valid until 30th June 2025

SINK REPAIR KIT

**135
PIECES**

\$157.37

INC. GST

CODE 1795

135 PIECE

10 x Sieve Washers Laundry/Dishwasher
10 x Nut & Tail Washer 20mm
5 x Butterfly Hose Clamp Handle Stainless 20mm - 32mm
10 x Kitchen Waste Basket Washer Universal

20 x Trap Rubber Square Washer 40mm
20 x Trap Rubber Square Washer 50mm
10 x Pop Up Wastes Washer 32mm
10 x Pop Up Wastes Washer 40mm

10 x Trap Rubber Single Taper Washer 40mm
10 x Trap Rubber Single Taper Washer 50mm
10 x Trap Rubber Double Taper Washer 40mm
10 x Trap Rubber Double Taper Washer 50mm

CISTERN WASHER KIT

**100
PIECES**

Contains
11 types of the
most common
washers

\$145.19

INC. GST

CODE 6687

100 PIECE

• 7 x 9603 Cistern Washer Doulton Top Hat Old Style Ballcock
• 7 x Cistern Washer Doulton Top Hat New Style Ballcock
• 7 x Cistern Washer Doulton Seating

• 5 x Cistern Washer Doulton Concave Suction
• 3 x Cistern Washers Replacement Fluidmaster (242)
• 4 x Cistern Washer Brent New Style
• 5 x Cistern Washer Gebrit Seating Silicone

• 7 x Cistern Washer 'K' Seating
• 15 x Cistern Washer Caroma Seating Red Silicone
• 18 x Cistern Washer Caroma New Style Ballcock #2
• 25 x Float Valve Washers 1/2 Inch

OUR NEW MOBILE APP

DOWNLOAD. LOGIN. START ORDERING TODAY!

Available on the iPhone App Store | Android APP ON Google play

Order Templates

Have specific items you order regularly? Want to set up kits for certain jobs?

Our order templates make it easy...Simply add all the items to the cart and use the 'Save Order Template' button at checkout to create your template.

Request a Quote

Something doesn't look right? Want a Rep to look it over?

Request a personalised quote directly from the checkout page before placing your order. Simply click a button and our team will swiftly provide you with a tailored quote.

Manage Your Account

Pay your account, look up a previous order, check the status of an order, get an updated quote. Whatever you need to do, its now quick and easy, in the palm of your hand.

Favourites

Typically buy the same gear? Have things you regularly use?

You can now mark items as a 'favourite' item, then head to the Favourite Items page to access them all in one convenient location. No more scrolling endlessly to find your regularly purchased supplies.

Promotions & Specials

Be the first to know about our Promotions & Specials from the palm of your hand.

Check out our new Clearance page to see some cracking deals!

LOOSE NUT

Right Angle Gas ball valve

MxF 15mm

- Eliminates extra fittings on installation
- Saves installation time
- Uses less space than a traditional install
- AGA approved

JAK

Code: 8098

AGA

MANTA INNOVATIONS

RIGHT ANGLE GAS BALL VALVE

MxF 15mm

Fewer fittings required on installation

JAK

Code: 8099

AGA

MANTA INNOVATIONS

NEW

BRASS COLOURED TEFLON TAPE

- Approved for water, natural gas and LPG
- Max pressure gas 690 Kpa
- Max pressure water 2000 KPa
- Temperature range -10°C to 135°C
- 6.6m in length x 12.7mm wide



Thread Seal Tape – Brass
Code 1548



PERFECT COLOUR MATCH!



Cover Plate Backing Foam
Code 4009

- Suits Cover Plates OD of 70mm
- Adhesive backing for sticking to Cover Plate



Rough Brass for Corrugated 1/2" BSP
Code 4005

- Foam backing moulds to any position on corrugate,
- Rough brass finish to match hose bibs. Professional finish

PER 1



Rough Brass Cover Plate

- Rough brass finish to match hose bibs

1/2" BSP 3/4" BSP
Code 4001 Code 4002



BRASS COVER PLATES



All Brassware complies with AS3688

BRASS HOSE BIBS



HOSE BIB LEVER HANDLE 1/4 TURN FI

CODE	SIZE	PRICE (INC GST)
3671	15mm	\$15.13
3672	20mm	\$18.60



HOSE BIB LEVER HANDLE 1/4 TURN MI

CODE	SIZE	PRICE (INC GST)
3664	15mm	\$13.53
3667	20mm	\$16.65



HOSE BIB LEVER HANDLE DOUBLE OUTLET MI

CODE	SIZE	PRICE (INC GST)
3669	15mm	\$27.02
3670	20mm	\$31.02



HOSE BIB T/HEAD MI

CODE	SIZE	PRICE (INC GST)
3660	15mm	\$13.65
3661	20mm	\$14.85



HOSE BIB T/HEAD FI

CODE	SIZE	PRICE (INC GST)
3662	15mm	\$13.65
3659	20mm	\$16.40



HOSE BIB T/HEAD BACK PLATED MI

CODE	SIZE	PRICE (INC GST)
3663	15mm	\$17.57



HOSE BIB MI WITH VACUUM BREAKER

CODE	SIZE	PRICE (INC GST)
3668	15mm	\$24.63

JAY TYPE

TIMBER SCREW

For 16-20mm Pex Pipe

- Saves time and money by only having to stock one clip
- Use on trusses and under bearers
- The original Kody design

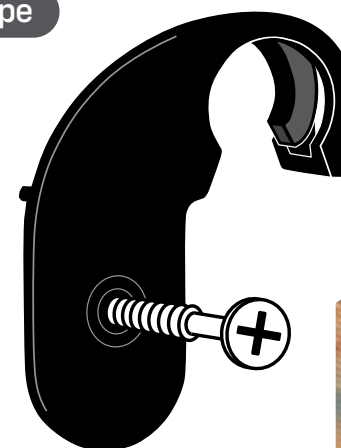

PATENTED

BAG QTY 25

16 - 20mm | Code: 5588

\$13.48



DUALPEX

AQUARIUS DISTRIBUTION

2IN1

ONE CLIP FITS TWO PIPE SIZES!

STUD CLIP

HEX SD SCREW

For 16-20mm Pex Pipe

- Saves time and money by only having to stock one clip
- Use on Steel Studs
- 1/4" Hex Driver Bit included in bag

FREE DRIVER BIT

Receive a **FREE 1/4 INCH MAGNETIC NUT SETTER** with every Hex Head bag

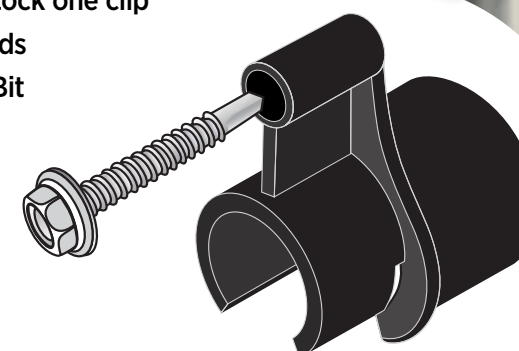

PATENTED

BAG QTY 100

16 - 20mm | Code: 5569

\$42.36



WOMBAT

Australian Designed

Brass Shroud prevents spreading and splitting

Tough NP3 compound which is heat resistant and hard wearing

Passes 100,000 cycle test

Complies with AS3718

Protective Brass Shroud

Unique NP3 Compound

10 Pack
Code: 8810

100 Pack
Code: 8811



PATENTED



PLUMTOOL BREECH STRAIGHTENER

- For straightening tap breeches prior to fit-off
- Reverse tool to straighten 1/2 B.S.P. lugged elbows
- Patented

Code: 2395 **\$66.86** INC. GST



PLUMTOOL TAP FLANGE REMOVER

- Use with your hand to increase grip x 3
- Grips any shaped flange
- Use very carefully with round jaw multi-grips to remove stubborn flanges
- Be sure to grab the rubber on the flap area

Code: 8539 **\$19.58** INC. GST



PLUMTOOL LONG NOSE PLIERS

- 270mm long, twice the reach of standard pliers
- Will remove tap washers from even the deepest breeches
- Thin profile to fit into tap bodies

Code: 1667 **\$47.75** INC. GST



PLUMTOOL FRANZ NUT SPINDLE CLEANER

- For cleaning threads on standard tap spindles
- Much cleaner and easier to use than a wire brush.

Code: 9854 **\$47.69** INC. GST



PLUMTOOL FRANZ BONNET CLEANER T HANDLE

- For cleaning and straightening the internal thread of tap spindles

Code: 2006 **\$38.86** INC. GST



RED BACK TAP LUBRICANT 45g

- Approved for potable water
- Working range of between -10°C and 150°C

Code: 8886 **\$12.10** INC. GST



BODY WASHERS RED FIBRE EZ CLEAN

- For standard taps
- Thin washer for installation of bells
- 23mm ID x 28 OD

Bag of 50 **\$15.44** INC. GST
Code: 9449



O RINGS NO. 8.5

- For standard tap repairs
- Number 8.5

Bag of 100 **\$15.15** INC. GST
Code: 9164



TAP RESEATER - FACE & EDGE CUTTER

- Removes sharp edges on seats so valves will not stick or tear

\$91.81 INC. GST
Code: 2359



HYDROSEAL TAP RESEATER

- Genuine Hydroseal product

\$63.18 INC. GST
Code: 2005



HYDROSEAL CUTTER 1/2 INCH TUNGSTEN

- Replacement cutting head for tap reseater

\$97.78 INC. GST
Code: 2499



PLUMTOOL SPINDLE ACCESS DRILL

- Cuts tiles to allow access to tap body
- Diamond core drill will cut even the hardest of porcelain tiles
- Nylon bush prevents damage to the spindle
- Patented

Code: 1916 **\$205.05** INC. GST



PLUMTOOL TUBE SPANNER KIT

- Will not round out under stress
- Kit Contains:
Hex 20mm x 21mm,
Hex 22mm x 23mm,
Hex 29mm x Square 24mm,
Hex 25mm & Hex 28mm,
Turning Bar 230mm
- Made in Germany

Code: 2513 **\$202.92** INC. GST



PLUMTOOL TAP HANDLE PULLER

- Unique shroud stops slipping
- Holes in arms allow for removal of ezy clean handles
- A must for maintenance plumbers

Code: 1758 **\$76.78** INC. GST

NEED TO CUT PVC?

40mm PVC

\$56.38

INC. GST
CODE 2644



MONUMENT AUTOCUT PIPE CUTTER

QUICK AND CLEAN CUT

- Quality UK Designed & Made
- Light Weight
- Spare blades available
- Spare blade suits both Cutters

**GREAT
FOR 40MM
& 50MM
POLY**

50mm PVC

\$59.02

INC. GST
CODE 2645



BULK SPECIAL

Valid until 30th June 2025



SAMURAI RECIPROCATING SAW BLADE

CUT IS FREE OF BURRS

- Specifically designed for cutting PVC pipe
- Cuts straight
- Made in Japan
- 210mm

\$19.51

INC. GST
CODE 9632



Per 10
\$150

CODE 9632

PLUMTOOL INTERNAL PIPE CUTTER

WITH DIAMOND WHEEL

- Will cut pipe from 40mm up to 150mm
- Diamond wheel will not blunt on concrete or tiles

\$48.93

INC. GST
CODE 1347



\$20.66

INC. GST
CODE 9670

CABLE SAW

**HANDY TOOL FOR CUTTING PVC PIPE
IN DIFFICULT TO REACH PLACES**



\$74.56

INC. GST
CODE 8011

PLUMTOOL PVC DRAINERS' PIPE SAW

**UNIQUE TEETH DESIGN
WILL NOT SHATTER PIPE**

- 500mm
- Comes with deburrer
- Blade length 420mm
- Specifically for cutting PVC pipe



PLUMTOOL PROCUT 100MM PVC CUTTER

**AUTOMATICALLY CLAMPS
TO PREVENT MOVEMENT
DURING CUTTING**

- Can be used freehand, attached to a vice or clamp
- Rugged design with replaceable heavy duty cutting blades
- To suit 100mm DWV. Inserts available for other sizes



\$528

INC. GST
CODE 7670

SPECIAL

TEMPERING VALVES

\$49.50

INC GST



YELLOW CAP TEMPERING VALVE STANDARD 15mm

- Suitable for storage hot water systems
- Insulation included
- 2 year warranty
- Conforms AS4032.2 LIC No. 20137

CODE: 6810

\$69.30

INC GST



ORANGE CAP TEMPERING VALVE HIGH PERFORMANCE 15mm

- Suitable for solar and instantaneous hot water systems
- Insulation included
- High performance
- 2 year warranty
- Conforms AS4032.2 LIC No. 20137

CODE: 6811

Valid until 30th June 2025

AVG
Australian Valve Group

W
WaterMark

Bostik
smart adhesives



TRUSTED BRAND

ROOF & GUTTER SILICONE



- Bostik Quality
- Ideal for sealing sheet metal, roofing & guttering
- Potable water approved AS4020-1999
- Neutral Cure
- Non-Corrosive

BOX
QTY
20

GREY
300ml



Code: 9953

BLACK
300ml



Code: 9812

TRANSLUCENT
300ml



Code: 9926



SILICONE - XTREME

- UV resistant, absorbs acoustic and mechanical vibrations
- Highly flexible with up to 400% elongation
- Sticks and seals all common building materials, even in the wet
- Interior & exterior use

GREY
290ml



Code: 8225

BOX
12

WHITE
290ml



Code: 9845

BOX
12

BLACK
290ml



Code: 8226

BOX
12



SEAL 'N' BOND CRYSTAL

- Phthalate-free, tin-free & solvent free
- High UV resistance
- Multi-functional sealant & adhesive
- Internal & external use

CLEAR 290ml



Code: 8224

BOX
12

Fluidmaster Pro Series® Most Powerful Flush System



PRO SERIES® CISTERN with Link & Seat

- Low Level Flush Pipe
- 4.5/3L Dual Flush Technology
- Simple Flush Volume Conversion to 6/3L or 9/4.5L
- UV Resistant - Certified
- Plastic Cistern with Bottom Inlet
- Saves Water
- Cistern - 391mm H x 420mm D x 133mm W

INC GST | CODE 2089



CODE: 2099

Pro Series Cistern Inlet Valve

- Ultra quiet
- Fast refill
- Reduces water hammer
- 5 Year Warranty

CODE: 2040

Brass Stem Cistern Inlet Valve

- Heavy duty brass thread will not cross thread
- Ultra quiet
- Fast refill
- Reduces water hammer



APPROVED DRAIN LAGGING

- Approved drain lagging where pipes pass through concrete
- Australian Draining Standards 3500 Part 2.2 Clause 3.8.2b states - "Drains laid through footings shall be installed with an annular space of not less than 25mm filled with a liner of flexible material"

100mm x 600mm \$8.60
150mm x 600mm \$10.11
[All prices are per half]

Code: 9244
Code: 1902

*All prices include GST



DOES
YOUR
JOB
COMPLY?

FAST
AND SIMPLE
SOLUTION!



1. Take 2 pieces of Styrolag and place around pipe



2. Fit two halves together, secure first end with duct tape



3. Secure other end with duct tape. Job completed.



For use on pipework
passing through
concrete footings

DOES YOUR JOB COMPLY?



MADE
FROM
RECYCLED
MATERIALS

ECO
FRIENDLY
PACKAGING

DRAINLAG BLACK

Code: 8720

- 100mm x 10 Metre Roll
- Closed Cell
- Non-Absorbent
- Simple to apply to pipe and or fittings
- Complies with the following standards:

AS3500 3.8.2 (b)

"Shall be installed with not less than 25mm annular space"

AS 1345-1995 (Table 1)

Colour Identification for
Sewerage & Organic waste: Black

AS2870 5.5.4 (a)

"Closed cell polyethylene lagging shall be used around all drainage pipes through external footings"

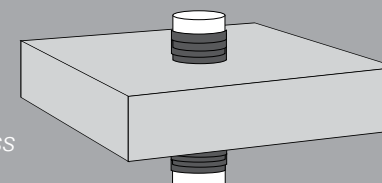

PRICES SLASHED
SAVE 50%
was \$15.48 now \$7

PRICES INC. GST

DON'T GET CAUGHT OUT!

Drainlag complies with AS1345-1995 (Table 1) indicating that pipes containing sewage and organic waste should be marked black.

"For the professional plumber"

DISHWASHER COVER PLATES

- Leave a neat finish in the cupboard
- Keeps pests out
- Fits over the solenoid valve

Code: 1792



MULTI PURPOSE COVER PLATE

Suitable for Washing Machines & Dishwashers

- Leave a neat finish in the cupboard
- Keeps pests out
- Fits hot & cold hoses, power cord, Optional outlet hose cap

Code: 1796



LITTLE PLUMBERS PLAYGROUND

Crossword

CLUES

Across

- This is where excess water goes to prevent flooding.
- When water escapes from a pipe, it is often referred to as _____.
- A flexible tube used for watering plants.
- To connect two sections, you need a _____ to join them.
- To fill a glass, you turn on the _____.

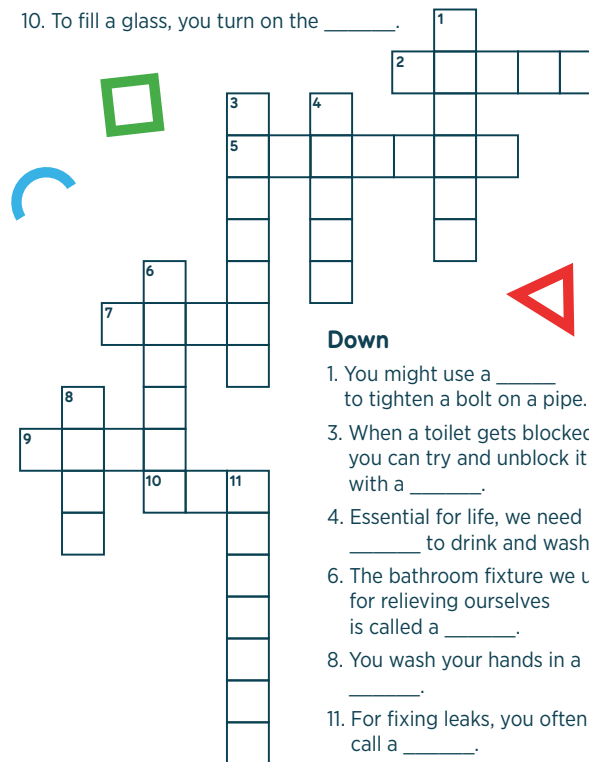

Down

- You might use a _____ to tighten a bolt on a pipe.
- When a toilet gets blocked you can try and unblock it with a _____.
- Essential for life, we need _____ to drink and wash.
- The bathroom fixture we use for relieving ourselves is called a _____.
- You wash your hands in a _____.
- For fixing leaks, you often call a _____.

Can you help Jacko get to the Job?

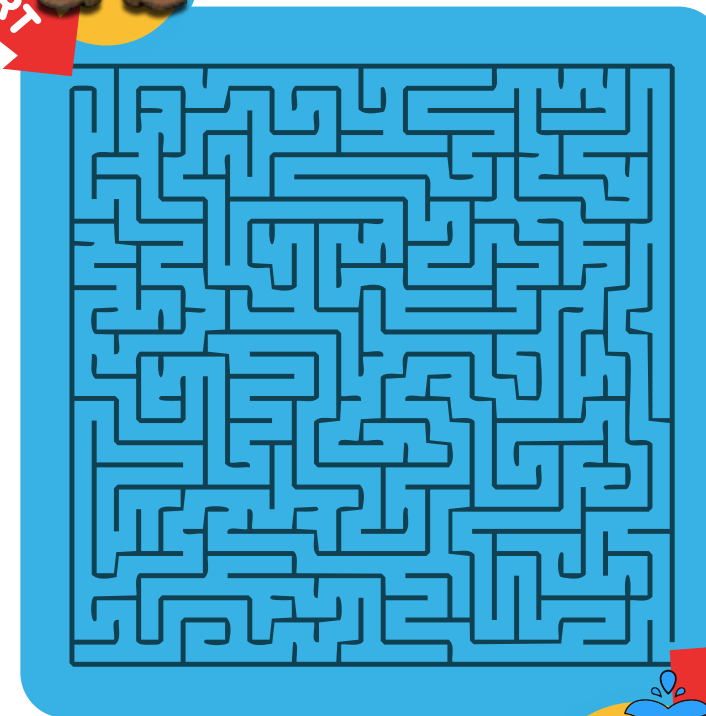

ANSWERS: 1. Wrench 2. Drain 3. Plunger 4. Water 5. Leaking 6. Toilet 7. Hose 8. Sink 9. Pipe 10. Tap 11. Plumber

tip of the month

To get involved send us an email
info@plumberschoice.com.au

Every featured story receives

\$200
Store Credit



Use a spindle remover to install nipples into hot water heaters, you can screw them in as far as they need to go. Also works perfectly for changing the anode.

Courtesy of
Tom - Storm Plumbing and Gas

Thanks mate, we'll be sending you \$200 store credit

SAFEST GAS CONNECTOR ON THE MARKET

EXTENDO
GAS CONNECTOR

**F+F
NOW
AVAILABLE**



New Extendo

Traditional

Extendability



Extendable

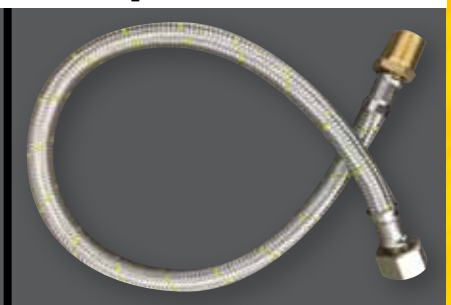

Fixed length

Capacity (Flow)



3.5 times the capacity
of traditional gas hoses

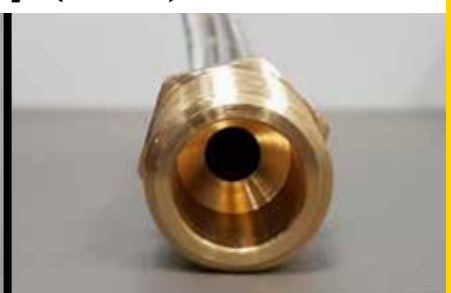

Reduced internal bore,
restricting gas flow

Flame Resistance



Superior flame & heat resistance



Rubber core is easily ignited

EXTENDABLE FROM **650mm** UP TO **1200mm**

- ✓ Saves Space, **ONE** Connector does it all!
- ✓ Flame resistant stainless steel
- ✓ 12mm internal bore for better gas flow
- ✓ AGA Approved 8633G
- ✓ 1/2" M+F
- ✓ 1/2" F+F



Box of 10

\$246.79
INC. GST

1/2" M+F

Code: 6176

1/2" F+F

Code: 6178

HANDY TIP:
Attach brass tee to either end to create a handle

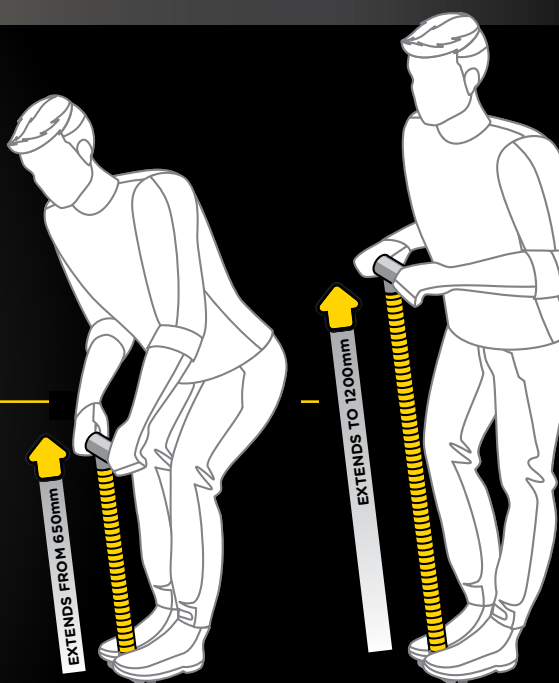

COPPER & BRASS

PRESS FITTINGS

Flame-free
Permanent V-Profile
press join
All fittings comply
with Australian
Standards AS3688

25 YEAR WARRANTY*

Against defects and
manufacturing faults in
CuPress fittings.

*when installed in accordance with national, state
and local plumbing codes by a licensed plumber.
Please contact Brasshards for a copy of our full
warranty document.



PLUMBING SUPPLIES SPECIALIST

all prices include GST

GAS FITTINGS



Press Gas Coupling

Code	Size
8639	15mm
8640	20mm
8641	25mm



Press Gas Slip Repair Coupling

Code	Size
8642	15mm
8643	20mm
8644	25mm



Press Gas Elbow f/f 90°

Code	Size
8645	15mm x 90
8646	20mm x 90
8647	25mm x 90



Press Gas Elbow f/f 45°

Code	Size
8697	15mm x 45
8648	20mm x 45
8649	25mm x 45



Press Gas Reducing Coupling f/f

Code	Size
8650	20mm x 15mm
8651	25mm x 20mm



Press Gas Reducer m/f

Code	Size
8652	20mm x 15mm
8653	25mm x 20mm



Press Gas Tee

Code	Size
8654	15mm
8655	20mm
8656	25mm



Press Gas Tee Reducing

Code	Size
8657	20 x 20 x 15
8659	25 x 25 x 20



Press Gas End Cap

Code	Size
8660	15mm
8661	20mm
8662	25mm



Press Gas Elbow Lugged

Code	Size
8663	15mm x 15FI
8664	20mm x 20FI



Press Gas Elbow Lugged

Code	Size
8665	15mm x 15MI



Blockhead Press Gas Elbow Lugged (90mm)

15mm x 15MI
Code: 8698



Press Gas Elbow m/f

Code	Size
8770	15mm
8771	20mm



Press Gas Adaptor MI

Code	Size
8666	15mm x 15MI
8667	20mm x 20MI
8668	25mm x 25MI



Press Gas Adaptor FI

Code	Size
8669	15mm x 15FI
8670	20mm x 20FI
8671	25mm x 25FI



Press Gas Slip Tee

Code	Size
8693	20mm

WATER FITTINGS



Press Water Coupling

Code	Size
8601	15mm
8602	20mm
8603	25mm



Press Water Slip Repair Coupling

Code	Size
8604	15mm
8605	20mm
8606	25mm



Press Water Elbow f/f 90°

Code	Size
8607	15mm x 90
8608	20mm x 90
8609	25mm x 90



Press Water Elbow f/f 45°

Code	Size
8610	15mm x 45
8611	20mm x 45
8612	25mm x 45



Press Water Elbow m/f 90°

Code	Size
8681	15mm
8682	20mm



Press Water Reducing Coupling f/f

Code	Size
8613	20mm x 15mm
8614	25mm x 20mm
8542	18mm x 15mm
8543	20mm x 18mm



Press Water Reducer m/f

Code	Size
8615	20mm x 15mm
8616	25mm x 20mm



Press Water End Cap

Code	Size
8623	15mm
8624	20mm
8625	25mm



Press Water Adaptor FI

Code	Size
8636	15mm x 15FI
8637	20mm x 20FI
8638	25mm x 25FI



Press Water Adaptor MI

Code	Size
8633	15mm x 15MI
8680	15mm x 20MI
8691	20mm x 15MI
8634	20mm x 20MI
8635	25mm x 25MI



Press Water Tee Reducing

Code	Size
8620	20 x 20 x 15
8621	25 x 25 x 15
8622	25 x 25 x 20
8683	20 x 15 x 15
8684	20 x 15 x 20



Press Water Tee

Code	Size
8617	15mm
8618	20mm
8619	25mm



Press Water Slip Tee

Code	Size
8692	15mm
8690	20mm
8694	20 x 20 x 15



Press Water Elbow Lugged

Code	Size
8626	15mm x 15FI
8598	20mm x 15FI
8627	20mm x 20FI



Press Water Elbow Lugged

Code	Size
8628	15mm x 15MI



Blockhead Press Water Elbow Lugged (90mm)

15mm x 15MI
Code: 8699



Press Water Union Loose Nut (Flat seat)

Code	Size
8685	15mm x 15mm Press
8679	20mm x 20mm Press



Press Water Union Loose Nut Compression

Code	Size
8696	15mm x 15mm Press
8689	20mm x 20mm Press



Press Water Elbow MI

Code	Size
8631	15mm x 15MI
8632	20mm x 20MI



Press Water Elbow UNION

Code	Size
8687	15mm x 1/2"
8688	20mm x 3/4"



Press Water Elbow FI

Code	Size
8629	15mm x 15FI
8630	20mm x 20FI

Press Water Elbow Lugged 15mm x 15 MI Preloaded

- Preloaded with 30mm x 8g Phillips head Chipboard Screws
- 25 year warranty*
- Permanent V-Profile press join profile
- Flame-free
- Complies with Australian Standards AS3688



15mm x 15MI
Preloaded (95mm)
Code: 7584

CALL US FOR PRICING

HIGH TEMP PRESS FITTINGS

- Peak temperature rating of 200°C
- Permanent V-Profile press join profile
- Flame free
- 25 year warranty
- Complies with Australian Standards AS3688



Press High Temperature Coupling

15mm 8030 20mm 8031



Press High Temperature 90° Elbow

15mm 8032 20mm 8033



Press High Temperature Tee

15mm 8034 20mm 8035



High Temperature Stop End

15mm 8036 20mm 8037



Press High Temperature Slip Coupling

15mm 8039 20mm 8040



Press High Temperature Reducer F&F

20mm x 15mm 8038

SPECIAL

STUBBIE TEST CAP



BULK PRICE

BAG OF 100
ONLY \$99



- Easier to install cabinets
- Can be removed with screw driver or shifter
- Safer high visibility
- Available in a bag of 100

\$1.55 each
INC. GST
Code: 4803



TEST CAP 1/2 INCH

- Size 1/2 inch
- Female
- Fast cap for testing at rough in stage

\$1.76 each
INC. GST
Code: 5051



TEST PLUG DUO GREY

- Duo plug and cap combination
- For testing hot and cold water installations
- One product does both plug and test cap

\$2.77 each
INC. GST
Code: 5052



TEST CAP DRAINABLE

- Small removable plug for easy drainage of water line
- Eliminates spilling inside wall cavity

\$3.74 each
INC. GST
Code: 5053



BRASSHARDS
EST. 1967



| PLUMBING SUPPLIES SPECIALIST |



SecuraNut fixing

Locks on
and won't
loosen

40% MORE GRIP!



Metal Bolt Fixing



Polyamide Pex Tails

EXCLUSIVE TO PLUMBERS CHOICE



Metal bolt fixing
kit featuring
NEW
SecuraNut

▲ BASIN MIXER SWIVEL

- Wels 4* 7.5 LPM
- Rated to 1500kPa
- Metal bolt fixing kit featuring new SecuraNut
- 40mm cartridge
- Supplied with polyamide pex tails
- 25 year warranty on all parts
- 5 year warranty on labour

120mm | CODE: 2835



Metal bolt fixing
kit featuring
NEW
SecuraNut

▲ SINK MIXER SWIVEL

- Wels 4* 7.5 LPM
- Rated to 1500kPa
- Metal bolt fixing kit featuring new SecuraNut
- 40mm cartridge
- Supplied with polyamide pex tails
- 25 year warranty on all parts
- 5 year warranty on labour

225mm | CODE: 2830



Metal bolt fixing
kit featuring
NEW
SecuraNut

▲ BASIN MIXER FIXED

- Wels 4* 7.5 LPM
- Rated to 1500kPa
- Metal bolt fixing kit featuring new SecuraNut
- 40mm cartridge
- Supplied with polyamide pex tails
- 25 year warranty on all parts
- 5 year warranty on labour

120mm | CODE: 2866

CHECK OUT OUR NEW CLEARANCE PAGE

CRACKING DEALS

WHILE
STOCKS
LAST!

ITEMS
ADDED
REGULARLY



TRAP COMBO
S & P 40MM
CHROME KIT

\$82.50

SAVE \$60.27

CODE: 2790

INC. GST



THERMOCOUPLE
600MM
UNIVERSAL

\$10

SAVE \$11.74

CODE: 8005

INC. GST



50MM

PRESS GAS
SLIP REPAIR
COUPLING

\$28.05

SAVE \$13.85

CODE: 7957

INC. GST



PLUMTOOL
GLUTOTE TO
SUIT 500ML

\$33

SAVE \$23.06

CODE: 1695

INC. GST



TRIO VALVE
20MM WITH
FILTER C X C

\$66

SAVE \$22

CODE: 6853

INC. GST



450mm

QUICK STICK
HANGING
BRACKET

\$4.73

SAVE \$3.15

CODE: 2828

INC. GST

AND MANY, MANY MORE....

WWW.PLUMBERSCHOICE.COM.AU/CLEARANCE

CLEARANCE SALE CLEARANCE SALE CLEARANCE SALE CLEARANCE SALE

plumtest

SMOKE PEN

9837

Ideal for testing the slightest air movement & gas spillage

- Specified for carbon monoxide testing
- HVAC air movement or leakage checks
- Comes with 6 smoke wicks
- Ideal for testing smoke alarms
- Refill packs of wicks available
- Non-toxic, slow burning, smoke emitter

6 WICKS

10% OFF
\$81.62
SAVE \$9.82



plumtest

MANOMETER

Designed to meet all requirements of the professional plumber

- Aluminium case
- Durable cover protects calibrations
- 300mm manometer for appliance testing
- 800mm manometer for line testing
- Magnet is riveted to the back of the 300mm manometer case to allow the manometer to be attached to an appliance
- Comes with rubber connecting hose

1870
300mm
\$122.90
SAVE \$13.65

1743
800mm
\$153.15
SAVE \$17.02

10% OFF



plumtest

TMV TEST KIT

Suitable for use on all types & styles of Thermostatic Mixing Valves (TMV)

- Flow cup, Thermometer with probe, Pressure gauge to suit 1/2 inch & 3/4 inch BSP,
- Comes factory set

10% OFF
\$960.04
SAVE \$106.30

9017



10% OFF



plumtest

DIGITAL MANOMETER KIT

4512

Suitable for appliance & line testing 0-15 kPa

- Within 1% accuracy
- 3 year warranty
- Supplied in a sturdy steel case
- Inc. hand bellows, hose & testing tee

10% OFF
\$559.41
SAVE \$62.16



plumtest

DRY MANOMETER 10 kPa KIT

1905

Fast accurate way to test gas fitting lines

- Fits directly onto the gas stand pipe
- No more leaky hoses or water loss
- No batteries required
- Can be calibrated by plumber
- Supplied in a sturdy steel case
- Inc. hand bellows

10% OFF
\$504.14
SAVE \$56.01



EOFY SALE
\$499
SAVE \$199.43

plumtest

COMBO DIGITAL GAS TEST

1826

- For testing gas lines & appliances
- Easy use click on connectors
- Digital gauge, Testing tee, Hand bellows, 700mm rubber hose
- Operating Range 0 kPa to 30 kPa
- Suits Meters with 25mm thread



Great product, easy to use. Precise with no fluctuation of pressure. Does exactly what you want!

Matt Lovric



EOFY SPECIALS

10% OFF OUR PLUMTEST RANGE

Trap Black Combo HDPE S&P 50mm

• High temperature

Code: 2847

new

weird & wonderful traps

new

Flexidinger Bath Brass/ Chrome 40mm x 350mm

- For varying angles and gradients where space below taps & baths is limited
- Flexible tube suitable for solvent welding

Code: 2730

Flexidinger Cap Lining Elbow

- For varying angles and gradients where space below taps & baths is limited
- Flexible tube suitable for solvent welding

Code: 2733

Box Trap & Vanity Space Saver 40mm

- Min. exterior dimensions maximises shelf space
- Can be flat against the rear of the cabinet

Code: 2779

Vanity Space Saver 40mm

- The low profile keeps the space saver tucked up close to the top of the vanity unit

Code: 2778

Combination Trap Short

40mm Code: 2844 | 50mm Code: 2845

Trap Combo S & P with AAV

- Built-in air admittance valve
- Approved for installations up to 60°C
- 20mm overflow connection needs to be drilled out if required

40mm Code: 2785 | 50mm Code: 2786

Trap Waterless Horizontal 40mm

- Loose Nut
- Ideal for disabled basins
- Screws onto any 40mm plug & waste

Code: 2787

Trap Micro 40mm

- Loose Nut
- Ideal for disabled basins
- Screws onto any 40mm plug & waste
- Easily adapted to suit 32mm

Code: 2792

Solvent Welded Trap

- Compact glue trap
- S shape (vertical) and traditional gully
- Compact design

40mm Code: 2770 | 50mm Code: 2771

Trap Waterless 40mm

- Prevents odours escaping
- Tested and approved WMKT20062

Code: 2788

Trap Waterless 50mm

- Prevents odours escaping
- Tested and approved WMKT20062

Code: 2789

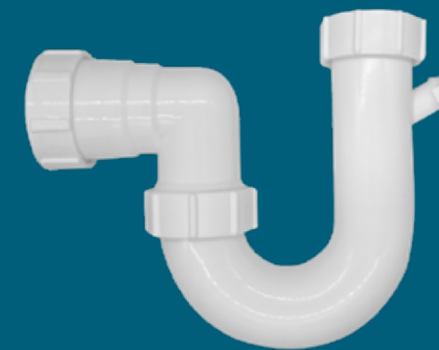

Trap P

- All PVC complies with ASNZ1260
- Removable plugs in nipples

40mm Code: 2799
50mm Code: 2798

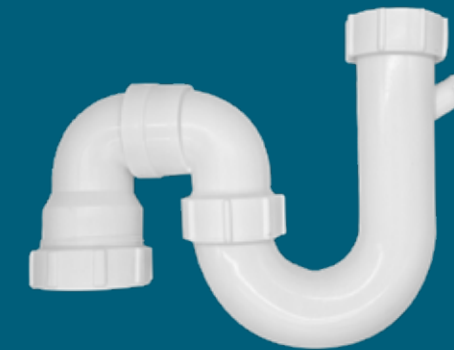

Trap Combo S & P

- All PVC complies with ASNZ1260
- Removable plugs in nipples

40mm Code: 2802
50mm Code: 2803



Trap P Short Leg

- All PVC complies with ASNZ1260

40mm Code: 2796
50mm Code: 2797

standard & common traps



Trap Extension Solvent Weld

- All PVC complies with ASNZ1260

40mm x 200mm Code: 2782
50mm x 200mm Code: 2783



Trap Adaptor

- All PVC complies with ASNZ1260
- Ideal for reducing a trap to suit a 32mm basin waste

32-40mm Code: 2795



Trap Extension Double Nipples (Overflows)

- All PVC complies with ASNZ1260

50mm x 60mm Code: 2784



Trap Extension

- All PVC complies with ASNZ1260

40mm x 25mm Code: 2780
50mm x 25mm Code: 2781

PAN HOLE COVER

Simple way
to fill holes
in toilet
pans

Code: 4115

PER
10

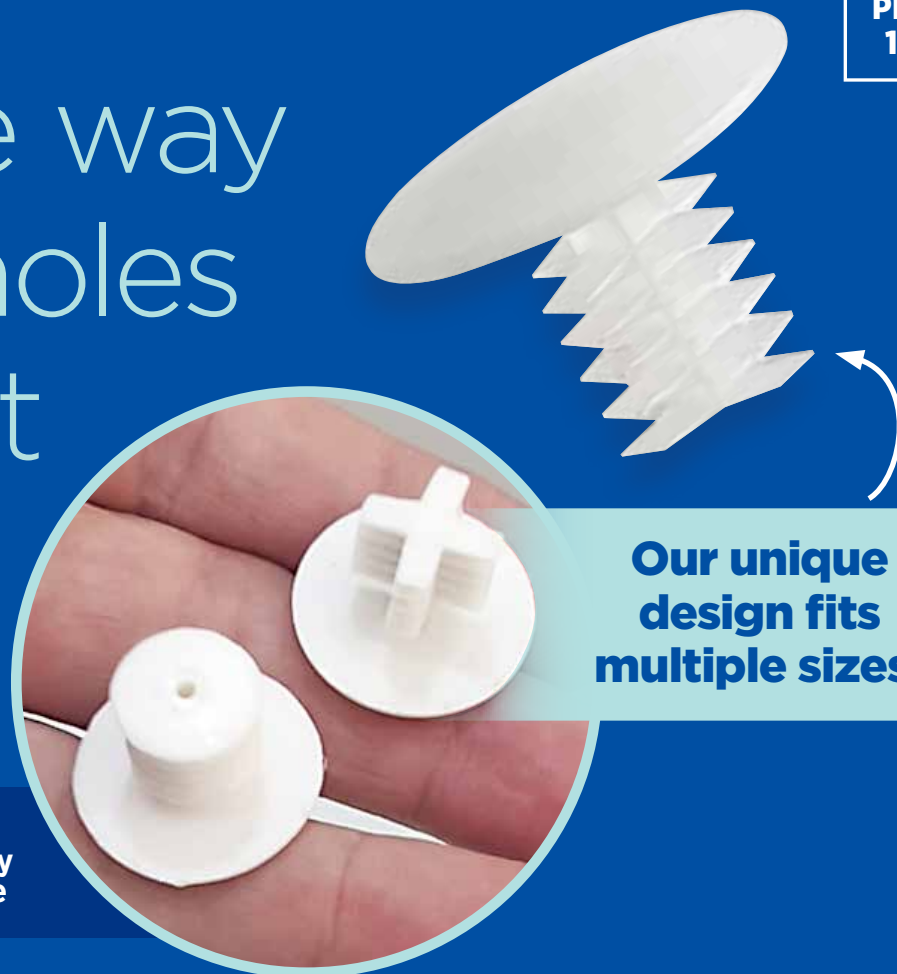

**Our unique
design fits
multiple sizes!**

Other
brands only
fit one size



**Easy
to
install**

**Fits
multiple
hole
sizes**



COMPLETE
COVER PLATES

Patent Pending

\$30K IN PRIZES TO BE WON

NOTHING BEATS A QUICKIE!

AVG Quickie® Kits save plumbers time and hassle — so we're making that extra time even sweeter! Four lucky winners will score a fantastic prize to enjoy their well-earned downtime.



**TACKLE
WORLD**

\$4,000
1-31 May 2025

**BARBEQUES
GALORE**

\$6,000
1-30 June 2025

JB HI-FI

\$8,000
1-31 July 2025

**FLIGHT
CENTRE**
Experience our experience

\$12,000
1-31 Aug 2025



HOW TO ENTER: Purchase eligible AVG Quickie® Kits and peel back the sticker to reveal your unique code, then enter online during the prize period of your choice.

To claim prize, Plumber's Licence and proof of purchase will need to be validated. All winners will be announced on AVG's Facebook page, follow us at: www.facebook.com/AVGAustralianValveGroup



AVG
Australian Valve Group

A WATTS Brand

*Eligible AVG Quickie® Kits: 8311, 8307, 8309, 8310, 8308, 8312. Visit this website for full competition terms and conditions: www.avgquickiecomp.com.au. Authorised under trade permit numbers: NSW TPL No. TP/04089. ACT May promotion TP 25/00047, June promotion TP 25/00048, July promotion TP 25/00049, August promotion TP 25/00051. SA Permit No. June promotion T25/21, July promotion T25/19, August promotion T25/43.

ONE CLIP TO RULE THEM ALL

SUITS BOTH TIMBER & STEEL



TIMBER FRAME



METAL FRAME

HEX
HEAD
DUO
SCREW



DUALPEX
JAY TYPE HEX
HEAD DUO
SCREW



- Fits 16mm - 20mm Pex pipe
- Avoid install on awkward angles

Bag Qty 25
Code: 5589

DUALPEX
STUD CLIP
HEX HEAD
DUO SCREW



- Fits 16mm - 20mm Pex pipe
- Plastic tongue moves outward to fit two size pipes

Bag Qty 100
Code: 5569

SADDLE FOR
PEX HEX HEAD
DUO SCREW



- Fits 20mm Pex pipe
- Suits Metal or Timber Frames

Bag Qty 100
Code: 9076

SADDLE FOR
PEX HEX HEAD
DUO SCREW



- Fits 16mm Pex pipe
- Suits Metal or Timber Frames

Bag Qty 100
Code: 9075

DUALPEX
HEX HEAD
DUO SCREW

Same clip for timber & steel

- One clip fits 2 sizes - fits 16mm and 20mm Pex pipe
- Plastic tongue on clip moves outward to fit different size pipes

Bag Qty 100
16 - 20mm
Code: 5577



Bag Qty 100
16 - 20mm
Code: 5578



FREE

**DRIVER
BIT**



Every bag comes with a **FREE**
1/4 INCH MAGNETIC NUT SETTER