

plumbers choice

**TRADE
ONLY**

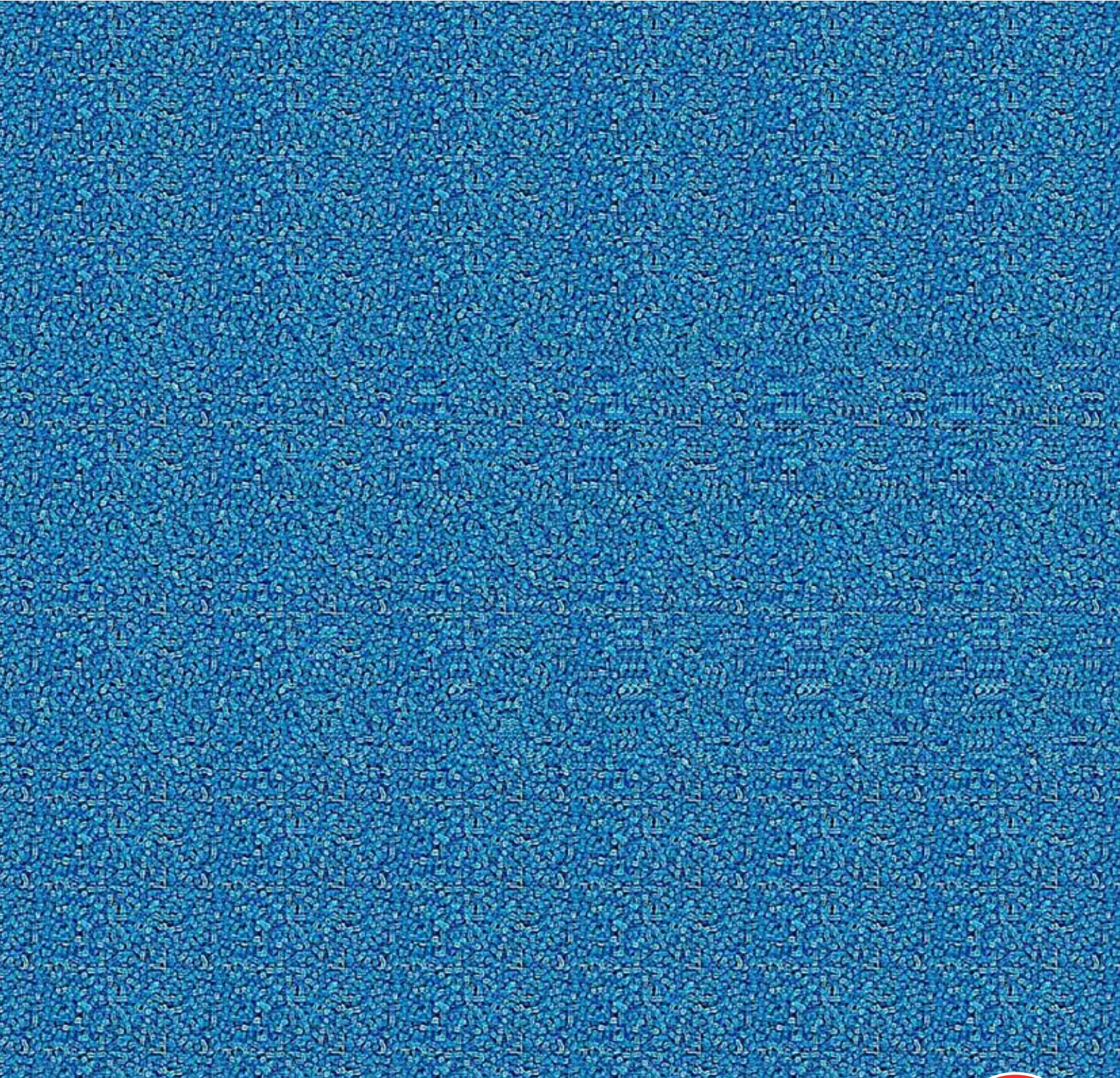

489 Mountain Highway, Bayswater, VIC 3153
Email: info@plumberschoice.com.au • Ph: (03) 9720 8274

www.plumberschoice.com.au



Luke's Editorial



Plumbers Choice first opened its doors in 1996. Back then many plumbers didn't understand the Trade Only concepts they couldn't see the benefit to both themselves and the industry as a whole, that supporting Trade Only not only protected the community but also their own livelihoods.

Back in the '90's when we started the Trade Only message, Magic Eye books were new and exciting. If you focused on the image enough you would see the hidden image emerge. Our front cover of this Edition is not only a nostalgic representation of when we started but it also represents how many of you can now clearly see the benefits of Trade Only.

We want to thank all you plumbers who support Trade Only. We were the original Trade Only Plumbing Supplier in Australia but with your support for the cause we have now seen other Merchants becoming Trade Only which is great for you, and the industry itself!

LUKE BOLTON
DIRECTOR, PLUMBERS CHOICE

plumbers
choice TRADE ONLY

Can you see it? →



HOW TO ORDER



Online - 24 hours
www.plumberschoice.com.au



Email - 24 hours
sales@plumberschoice.com.au



Phone - Business Hours
(03) 9720 8274
Our knowledgeable staff will take your order.



At our Trade Outlets
Monday - Friday
489 Mountain Highway, Bayswater, VIC 3153
4/200 Woodpark Road, Smithfield, NSW 2164



Personal Sales Rep
Your personal Sales Representative is able to tailor our service to suit your needs.



**Shop
Trade Only
from the palm
of your
hand!**

YOU SPOKE, WE LISTENED!

To continue to make things easier for you to support Trade Only, we've made a few additions to www.plumberschoice.com.au



ORDER TEMPLATES

Save Order Templates

You can now save custom Order Templates.

With just one click, add all the items from your Order Template to your shopping cart. Perfect for fit off packs, hottie kits or end of month stock top ups.



FAVOURITES

Favourite Items

Access to your favourite and most used items on the one page.

No more scrolling through to add the same items you buy every order. Now add them all from the convenience of one page.



QUOTES

Request a Quote

Want some gear quoted?

Haven't had some items priced up by your Sales Rep yet? Well, from the cart page you can now order or request a quote on the gear in your shopping cart.

Don't have an online account yet?

Head to www.plumberschoice.com.au/register/ and sign up today. Order any time from the convenience of your phone or laptop.



TIP OF
THE
MONTH



We'll tip
YOU
when you tip
US!



Every featured story receives a
\$200 Store Credit

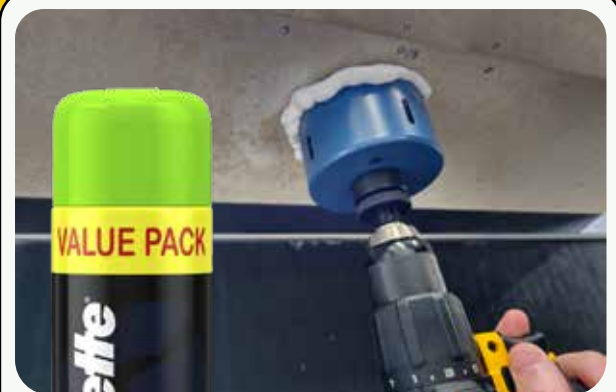

Use shaving cream when using a hole saw on cement sheet. It absorbs all the dust and debris as you cut.

Courtesy of
Guido - GPA Plumbing

Thanks mate, we'll be sending you \$200 store credit

To get involved send us an email info@plumberschoice.com.au

DISHWASHER COVER PLATES

- Leaves a neat finish in the cupboard
- Keeps pests out
- Fits over the solenoid valve

Code: 1792



MULTI-PURPOSE COVER PLATE

Suitable for Washing Machines & Dishwashers

- Leaves a neat finish in the cupboard
- Covers a hole in the cupboard up to 120mm x 115mm
- Keeps pests out
- Fits hot & cold hoses, power cord. Optional outlet hose cap

Code: 1796

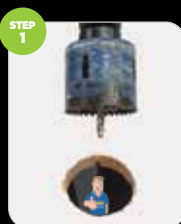

STAINLESS STEEL

67mm



**Flat
1/2" BSP**

Pack Qty 50
Code 9154

67mm



**10mm Rise
1/2" BSP**

Pack Qty 50
Code 9153

72mm



**16mm Rise
1/2" BSP**

Pack Qty 10
Code 1652

72mm



**22mm Rise
1/2" BSP**

Pack Qty 10
Code 1653

65mm



**34mm Rise
1/2" BSP**

Pack Qty 10
Code 1649

67mm



**10mm Rise
3/4" BSP**

Pack Qty 10
Code 1276

67mm



**Flat
1/2" Copper**

Pack Qty 50
Code 9539

67mm



**10mm Rise
1/2" Copper**

Pack Qty 50
Code 1238

70mm



**Flat
3/4" Copper**

Pack Qty 1
Code 9045

70mm



**10mm Rise
3/4" Copper**

Pack Qty 1
Code 1226

70mm

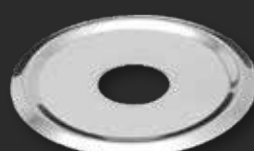

**Flat
1" Copper**

Pack Qty 1
Code 9046

97mm



**Flat
1 & 1/4" Copper**

Pack Qty 1
Code 9047

97mm



**Flat
1 & 1/2" Copper**

Pack Qty 1
Code 9048

97mm



**Flat
2" Copper**

Pack Qty 1
Code 9049

70mm



STAINLESS
STEEL

**Flat Square
1/2" BSP**

Pack Qty 10 Code 4011

70mm



CHROME
PLATED
ABS PLASTIC

**10mm Rise Square
1/2" BSP
Chrome Plated**

Pack Qty 2 Code 4010

BRASS COVER PLATES



All Brassware complies with AS3688



**Rough Brass
1/2 Inch BSP**
Code 4001



- Rough brass finish to match hose bibs
- Professional finish



**Rough Brass
3/4 Inch BSP**
Code 4002



- Rough brass finish to match hose bibs
- Professional finish



**Rough Brass for
Corrugated 1/2" BSP**
Code 4005

- Foam backing moulds to any position on corrugate,
- Rough brass finish to match hose bibs. Professional finish



**Cover Plate
Backing Foam**
Code 4009



- Suits Cover Plates OD of 70mm
- Adhesive backing for sticking to Cover Plate

BRASS HOSE BIBS



**HOSE BIB LEVER HANDLE
1/4 TURN FI**

CODE	SIZE	PRICE (INC GST)
3671	15mm	\$15.13
3672	20mm	\$15.13



**HOSE BIB LEVER HANDLE
1/4 TURN MI**

CODE	SIZE	PRICE (INC GST)
3664	15mm	\$13.53
3667	20mm	\$13.53



**HOSE BIB LEVER HANDLE
DOUBLE OUTLET MI**

CODE	SIZE	PRICE (INC GST)
3669	15mm	\$27.02
3670	20mm	\$31.02



**HOSE BIB
T/HEAD MI**

CODE	SIZE	PRICE (INC GST)
3660	15mm	\$14.85
3661	20mm	\$13.65



**HOSE BIB
T/HEAD FI**

CODE	SIZE	PRICE (INC GST)
3662	15mm	\$14.85
3659	20mm	\$16.40



**HOSE BIB T/HEAD BACK
PLATED MI**

CODE	SIZE	PRICE (INC GST)
3663	15mm	\$17.57



**HOSE BIB MI WITH VACUUM
BREAKER**

CODE	SIZE	PRICE (INC GST)
3668	15mm	\$24.63



TRUSTED BRAND

HIGH PERFORMANCE FLEXIBLE MS SEALANT AND ADHESIVE

GREY Code: 8225 • **WHITE** Code: 9845 • **BLACK** Code: 8226



- UV resistant, absorbs acoustic and mechanical vibrations
- Highly flexible with up to 400% elongation
- Sticks and seals all common building materials, even in the wet
- Contains zero solvents and is non-bubbling
- +/-25% cyclic expansion and low VOC
- Interior and exterior use



BOSTIKTRADE



BOSTIKTRADE



BOSTIKAUSTRALIA

bostik.com



ROOF & GUTTER SILICONE



TRANSLUCENT 300g



- Bostik Quality
- Ideal for sealing sheet metal, roofing & guttering
- Potable water approved AS4020-1999
- Neutral Cure
- Non-Corrosive

**BOX
20**

Code: 9926

GREY 300g



- Bostik Quality
- Ideal for sealing sheet metal, roofing & guttering
- Potable water approved AS4020-1999
- Neutral Cure
- Non-Corrosive

**BOX
20**

Code: 9953

BLACK 300g



- Bostik Quality
- Ideal for sealing sheet metal, roofing & guttering
- Potable water approved AS4020-1999
- Neutral Cure
- Non-Corrosive

**BOX
20**

Code: 9812

BULK SPECIAL

plumtool™



**PICK YOUR
BONUS!**

**PURCHASE ANY BOX OF
PEX CLIPS & RECEIVE**

**PLUMTOOL
PVC PIPE
SAW**

WITH DEBURRER
500mm

Code: 8011

OR

**PLUMTOOL
RAPID
BORE BIT**
25mm

Code: 9152

VALUED AT
\$70.33

VALUED AT
\$40.51

Valid until 31st August 2022



SORTING BIN STACK ABLE

LARGE

\$25.41
INC. GST

Can be divided
into 3 with
Divider

Code: 2690



420 x 370 x 170mm

MEDIUM

\$17.27
INC. GST

Can be divided
into 2 with
Divider

Code: 2686



210 x 370 x 175mm

DIVIDER

\$3.30
INC. GST

Used to divide
storing bins to
create extra
storage

Code: 2692



**Divider only.
Sorting bin not included.*

- Ideal for sorting and organising small fittings
- Sorting bins can be stacked on top of each other or side by side
- Bins include 4 pegs for stacking



APPROVED DRAIN LAGGING

- Approved drain lagging where pipes pass through concrete
- Australian Draining Standards 3500 Part 2.2 Clause 3.8.2b states - "Drains laid through footings shall be installed with an annular space of not less than 25mm filled with a liner of flexible material"

50mm x 600mm	\$8.42	Code: 9901
100mm x 600mm	\$8.60	Code: 9244
150mm x 600mm	\$10.11	Code: 1902

[All prices are per half]

*All prices include GST



**DOES
YOUR
JOB
COMPLY?**

*Fast
and Simple
Solution!*



1. Take 2 pieces of Styrolag and place around pipe



2. Fit two halves together, secure first end with duct tape



3. Secure other end with duct tape. Job completed.

Drainla

*For use on pipework
passing through
concrete footings*

DOES YOUR JOB COMPLY?



DRAINLAG BLACK

Code: 8720

- 100mm x 10 Metre Roll
- Closed Cell
- Non-Absorbant
- Simple to apply to pipe and or fittings
- Complies with the following standards:

AS3500 3.8.2 (b)

"Shall be installed with not less than 25mm annular space"

AS 1345-1995 (Table 1)

Colour Identification for
Sewerage & Organic waste: Black

AS2870 5.5.4 (a)

"Closed cell polyethylene lagging shall be used around all drainage pipes through external footings"

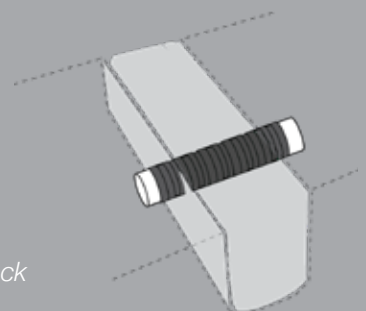
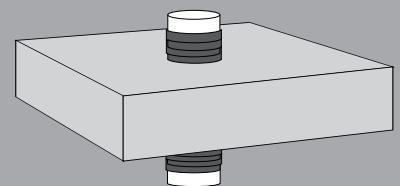

DON'T GET CAUGHT OUT!

Drainlag complies with AS1345-1995 (Table 1) indicating that pipes containing sewerage and organic waste should be marked black.

CHS CHRIS HUNTER
SALES

THE HANDY KIT FOR STRAIGHTENING AND CLEANING THREADS

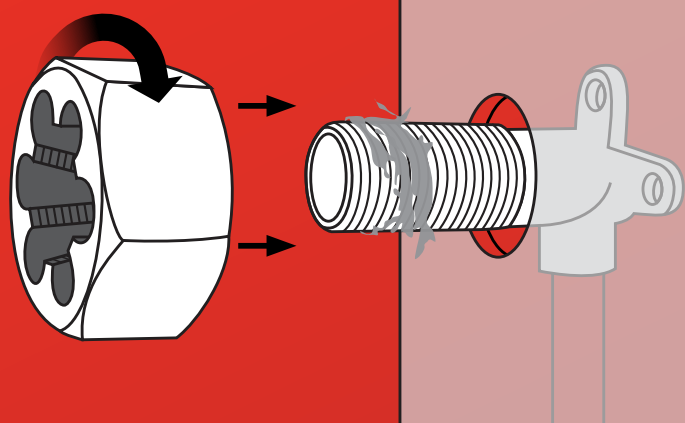

FRANZ TAP & DIE KIT

- Fixing crossed threads
- Cleaning out tap bonnet

Kit contains:

- 1/2 inch BSP Franz nut
- 1/2 inch BSP Franz tap
- 3/4 inch BSP Franz nut
- 3/4 inch BSP Franz tap
- Franz Spindle Cleaner
- Franz Nut 10mm Rod
- Franz Bonnet Cleaner T Handle

\$253.34

CODE: 2101

plumtool™



**FRANZ NUT
1/2' BSP**

1132



**FRANZ NUT
3/4' BSP**

9159



**FRANZ NUT
SPINDLE CLEANER**

9854



**FRANZ NUT
10MM ROD**

9858

BUY THE ONE YOU NEED

plumtool™



**FRANZ BONNET
CLEANER
'T' HANDLE**

2006



**FRANZ TAP
1/2' BSP**

1148



**FRANZ TAP
3/4' BSP**

2515

NEED TO CUT PVC?



CABLE SAW

**HANDY TOOL FOR
CUTTING PVC
PIPE IN DIFFICULT
TO REACH PLACES**



\$18.78

INC. GST
CODE 9670



PIPE CUTTER AUTOCUT

MONUMENT

**QUICK & CLEAN
CUT**

- Quality UK Designed & Made
- Light Weight
- Spare blades available
- Spare blade suits both Cutters

40mm PVC

\$56.38

INC. GST
CODE 2644

50mm PVC

\$59.02

INC. GST
CODE 2645

PVC PIPE SAW PLUMTOOL



**UNIQUE TEETH
DESIGN
WILL NOT
SHATTER PIPE**

- 500mm
- Specifically for cutting PVC pipe
- Comes with deburrer
- Will not shatter pipe
- Blade length 420mm

\$70.33

INC. GST
CODE 8011



RECIPROCATING SAW BLADE SAMURAI



CUT IS FREE OF BURRS

- Specifically designed for cutting PVC pipe
- Cuts straight
- Made in Japan
- 210mm

\$19.51

INC. GST
CODE 9632



SAMURAI
RECIPROCATING
SAW BLADE #9632



IDEAL
FOR
CONFINED
SPACES

INTERNAL PIPE CUTTER PLUMTOOL WITH DIAMOND WHEEL

\$46.16

INC. GST
CODE 1347

- Will cut pipe from 40mm up to 150mm
- Fits into a battery drill for easy use
- Diamond wheel will not blunt on concrete or tiles



HACK SAW

BAHCO

THE MOST COMMON HACK SAW ON THE MARKET

- Swedish design and quality
- Very high blade tension for straight and accurate cuts



\$59.44

INC. GST
CODE 9917

LENOX HACK SAW BLADE

- Made in the USA
- 24 TPI x 300mm

\$4.41

INC. GST
CODE 9167



STEEL STUDWORK?

plumbers choice

HAS THE ANSWERS!



\$599³⁷
INC. GST
Code: 1914

STUD PUNCH

- For the plumber in a hurry!
- Designed for cutting holes in steel stud work
- Cuts holes super fast

plumtool™



BAG
100

\$427⁴
INC. GST
Code: 9241

plumtool™

MULTI-FIT GROMMET

Works in varying thicknesses of studwork (thickness 0.42mm to 2mm)

Complies to Australian Standards AS3500.12 Clause 5.5 2.2 Part C



**34MM
AND
58MM**

STEEL STUD DRILL

- Also great in roofing work for overflows, etc
- 34mm to suit yellow grommets
- 58mm for drainage vents

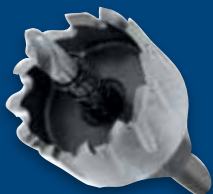

34mm

\$70⁵⁵
INC. GST
Code: 2000



58mm

\$152⁰⁹
INC. GST
Code: 2001



STUD CLIPS WITH SD SCREW

- Works in any size hole

BAG
100



16mm

\$30⁵³
INC. GST
Code: 5571

**16MM
AND
20MM**



20mm

\$32⁴³
INC. GST
Code: 5572

EACH HEX HEAD BAG COMES WITH A **FREE** DRIVER BIT

NEW



BAG QTY
100

**PEX SADDLES
HEX HEAD SD SCREW**

• 16mm
Code: 9075 **\$35.48**



BAG QTY
100

**PEX SADDLES
HEX HEAD SD SCREW**

• 20mm
Code: 9076 **\$36.42**

DUALPEX

BAG QTY
100



**DUALPEX
HEX HEAD SD SCREW**

• 16mm to 20mm
Code: 5577 **\$39.87**

DUALPEX

BAG QTY
100



WITH
TAB

**DUALPEX W/TAB
HEX HEAD SD SCREW**

• 16mm to 20mm
Code: 5578 **\$42.70**



**ONE
CLIP FITS
16MM - 20MM
PEX PIPE**

DUALPEX

BAG
100



\$33.34
INC. GST
Code: 5558

**DUALPEX CLIP
SD SCREW**

BAG
100



With
Tab

\$41.11
INC. GST
Code: 5575

**DUALPEX CLIP
SD SCREW
WITH TAB**

BAG
100



With
Tab

16mm
Code: 4526 **\$34.83**
20mm
Code: 4527 **\$38.55**

**PEX SADDLES
SD SCREW
WITH TAB**

PRELOADED

WITH HEX
SD SCREWS

Code: 1471



330mm - 600mm

UNLOADED

Code: 1450



330mm - 600mm

**MINI
PRELOADED**

WITH BUGLE
SCREWS

Code: 1474



190mm - 330mm

FASTANOG

- Faster than timber noggins
- Compulsory in termite areas
- Set back measurer



preloaded
set back
measurer

**SLIDE TO
ADJUST
LENGTH**



SPECIAL

PVC FITTINGS



**COUPLING PVC
THREADED MI**

Size 40mm Code 2823
Size 50mm Code 2825



TRAP ADAPTOR

Size 32-40mm Code 2795



**COUPLING PVC
THREADED FI**

Size 40mm Code 2822
Size 50mm Code 2824



BEND PLAIN F/F DWV

88 Degree Bend

Size 40mm Code 2808
Size 50mm Code 2809



SOCKET DWV F/F

Size 40mm Code 2810
Size 50mm Code 2812



VENT COWL

Size 50mm Code 2829



BEND PLAIN F/F DWV

45 Degree Bend

Size 40mm Code 2806
Size 50mm Code 2807

Valid until 31st August 2023

WEIRD AND WONDERFUL traps



Flexidinger Bath Brass/Chrome 40mm x 350mm

- For varying angles and gradients where space below taps & baths is limited
- Flexible tube is suitable for solvent welding

Code: 2730



Flexidinger Cap Lining Elbow

- For varying angles and gradients where space below taps & baths is limited
- Flexible tube is suitable for solvent welding

Code: 2733



Box Trap & Vanity Space Saver 40mm

- Minimal exterior dimensions maximises shelf space
- Can be positioned flat against the rear of the cabinet
- Fewer dust traps

Code: 2779



Vanity Space Saver 40mm

- The low profile keeps the space saver tucked up close to the top of the vanity unit maximising space and giving a more professional finish

Code: 2778



Trap Combo S & P with AAV 50mm

- Built-in air admittance valve
- Approved for installations up to 60°C
- 20mm overflow connection needs to be drilled out if required

Code: 2786



Trap Waterless Horizontal 40mm

- Loose Nut
- Ideal for disabled basins
- Screws onto any 40mm plug & waste

Code: 2787



Trap Micro 40mm

- Loose Nut
- Ideal for disabled basins
- Screws onto any 40mm plug & waste. Easily adapted to suit 32mm.

Code: 2792



Trap Combo S & P with AAV 40mm

- Built-in air admittance valve
- Approved for installations up to 60°C
- 20mm overflow connection needs to be drilled out if required

Code: 2785



Trap Waterless 40mm

- Prevents odours escaping
- Tested and approved WMKT20062

Code: 2788



Trap Waterless 50mm

- Prevents odours escaping
- Tested and approved WMKT20062

Code: 2789

WC installs or repairs?



Pan Cone Black With Skirt

40mm **Code: 9971**
50mm **Code: 9972**

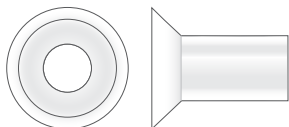

Pan Savers

- protect pans from damage and cracking

Code: 1983

**BOX
100**

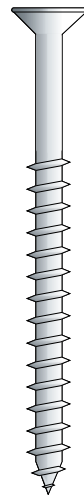

Pan Screws S/S 12G

- Non-corrosive, will not go green
- 25mm make great dummy screws
- The biggest range
- Per 100

25mm	12G	Code: 9622
50mm	12G	Code: 9186
65mm	12G	Code: 2505
75mm	12G	Code: 1400



Wax Pan Seal

- Repair leaky toilets without removing the pan
- Forms a watertight, gastight, and odour-proof seal
- moulded to shape and ready to use
- Remains flexible, adjusts to expansion, contraction and settling

Code: 1882



Fluidmaster®



CODE 2095

Side Entry Cistern Inlet Valve

1/2" Plastic Thread

- Quick release system for easy maintenance
- Compact design
- Anti-syphon
- Quiet fill



CODE 2096

Side Entry Cistern Inlet Valve

3/8" Brass Thread

- Quick release system for easy maintenance
- Compact design
- Anti-syphon
- Quiet fill

CODE: 1997

Universal Dual Flush Cable Valve

- Genuine Fluidmaster product
- Beware of imitations
- Top, front or side fitted flush buttons



CODE: 2131

Universal Dual Flush Outlet Valve

- Fixes leaking toilets and saves water
- Full and half flush
- Easy adjustment
- Includes standard 38mm dual flush buttons
- Other button sizes available





Cistern Washer Kit 100 Piece

- Contains 11 types of the most common washers
- Never run out of cistern washers again

Code: 6687

KIT CONTAINS

- 7 x 9603 Cistern Washer Doulton Top Hat Old Style Ballcock
- 4 x Cistern Washer Brent New Style
- 3 x Cistern Washers Replacement Fluidmaster (242)
- 5 x Cistern Washer Gebrit Seating Silicone
- 7 x Cistern Washer Doulton Top Hat New Style Ballcock
- 25 x Float Valve Washers 1/2 Inch
- 5 x Cistern Washer Doulton Concave Suction
- 7 x Cistern Washer 'K' Seating
- 15 x Cistern Washer Caroma Seating Red Silicone
- 7 x Cistern Washer Doulton Seating
- 18 x Cistern Washer Caroma New Style Ballcock #2



Toggle Springs For Cistern S/S

- Stainless steel bolt & washer
- Will not rust
- 3/16 Inch x 75mm
- Zinc plated toggle
- Designed to give maximum holding power in cavity walls

Code: 3157

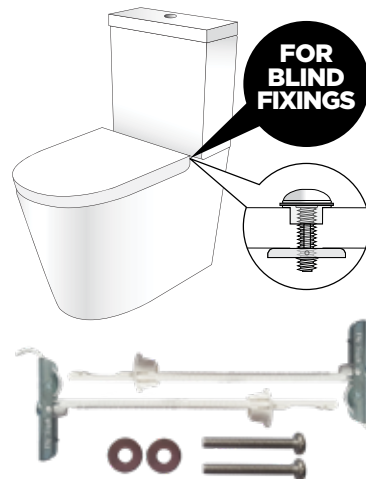

Toilet Seat Fixing TST6

- Top/Blind fixing toilet seat anchor kit
- Easy to fit
- Includes stainless steel bolts and washers

Code: 6169



Most Powerful Flush System

- Low Level Flush Pipe
- 4.5/3L Dual Flush Technology
- Simple Flush Volume Conversion to 6/3L or 9/4.5L
- UV Resistant - Certified
- Plastic Cistern with Bottom Inlet
- Saves Water
- Cistern - 391mm H x 420mm D x 133mm W

PRO SERIES® CISTERN with Link and Seat

\$114.55

INC GST | **CODE 2089**



CODE: 2099

Pro Series Cistern Inlet Valve

- Ultra quiet
- Fast refill
- Reduces water hammer
- Genuine Fluidmaster product
- Beware of imitations
- 5 Year Warranty



CODE: 2040

Brass Stem Cistern Inlet Valve

- Heavy duty brass thread will not cross thread
- Ultra quiet
- Fast refill
- Reduces water hammer
- Genuine Fluidmaster product
- Beware of imitations

WOMBAT

Australian Designed

Brass Shroud prevents spreading and splitting

Tough NP3 compound which is heat resistant and hard wearing

Passes 100,000 cycle test

Complies with AS3718

Protective
Brass Shroud

Unique NP3
Compound

10 Pack
Code: 8810

100 Pack
Code: 8811



**PATENT
PENDING**



PLUMTOOL FRANZ NUT SPINDLE CLEANER

- For cleaning threads on standard tap spindles
- Much cleaner and easier to use than a wire brush

\$44.99
INC. GST

Code: 9854



PLUMTOOL FRANZ BONNET CLEANER T HANDLE

- For cleaning and straightening the internal thread of tap spindles

\$36.66
INC. GST

Code: 2006



RED BACK TAP LUBRICANT

- Lubrication of standard jumper valve taps and gate valves
- Approved for potable water
- Working range of between -10°C & 150°C

\$18.08
INC. GST

Code: 9996



TAP RESEATER - FACE & EDGE CUTTER

- Removes sharp edges on seats so valves will not stick or tear
- Can be used by hand or with battery drill

\$91.81
INC. GST

Code: 2359



PLUMTOOL BREECH STRAIGHTENER

- For straightening tap breeches prior to fit off
- Reverse tool to straighten 1/2 B.S.P. lugged elbows
- Patented

Code: 2395

\$63.07
INC. GST



PLUMTOOL TAP FLANGE REMOVER

- Use with your hand to increase grip x 3
- Grips any shaped flange
- Use very carefully with round jaw multi-grips to remove stubborn flanges

Code: 8539

\$18.47
INC. GST



PLUMTOOL LONG NOSE PLIERS

- 270mm long, twice the reach of standard pliers
- Will remove tap washers from even the deepest breeches
- Thin profile to fit into tap bodies

Code: 1667

\$45.05
INC. GST



PLUMTOOL SPINDLE ACCESS DRILL

- Cuts tiles to allow access to tap body
- Diamond core drill will cut even the hardest of porcelain tiles
- Nylon bush prevents damage to the spindle

Code: 1916

\$193.45
INC. GST



PLUMTOOL TUBE SPANNER KIT

- Will not round out under stress
- **Kit Contains:** Hex 20mm x 21mm, Hex 22mm x 23mm, Hex 29mm x Square 24mm, Hex 25mm & Hex 28mm, Turning Bar 230mm

Code: 2513

\$191.44
INC. GST

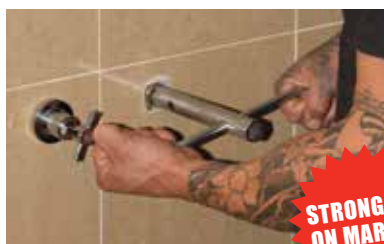

**STRONGEST
ON MARKET**



PLUMTOOL TAP HANDLE PULLER

- Unique shroud stops slipping
- Holes in arms allow for removal of ezy clean handles
- A must for maintenance plumbers

Code: 1758

\$72.44
INC. GST



BODY WASHERS RED FIBRE EZ CLEAN

- For standard taps
- Thin washer for installation of bells
- 23mm ID x 28 OD

Bag of 50

\$15.44
INC. GST

Code: 9449



O RINGS NO.8.5

- For standard tap repairs
- Number 8.5

Bag of 100

\$15.15
INC. GST

Code: 9164



BLACK ROCKET[®]
NITRILE GLOVES

Value & incredible toughness working together

BLACK ROCKET[®] NITRILE DISPOSABLE GLOVES

The toughest, cost effective trade based black disposable gloves you will experience. Ultimate value and incredible toughness.



- 100% Nitrile
- Cost Effective
- Fully Textured
- Tough Durability
- Mobile Phone Compatible
- Latex Free & Powder Free
- Box of 100



BULK PRICE

10 BOXES

\$209

\$20.90 ea

\$29.15 per box

MED | CODE: 5510

LRG | CODE: 5511

X-LRG | CODE: 5512

CARBON MONOXIDE ANALYSER

with PROBE



FREE
PLUMTEST
SMOKE
PEN

WITH EVERY
CARBON
MONOXIDE
ANALYSER
#8020

- Ambient CO testing
- Measures 0-10,000 ppm CO
- Pump driven
- 1 PPM sensitivity
- Auto zero
- Audible alarm
- Save and recall readings with time and date stamp
- Infrared port for use with optional A740 IR printer
- Testing from high heat/high heat sources with sampling

\$1210.00

Code: 8020

Comes in
sturdy carry
case

Code: 9837

\$86.26

**DETECTS SLIGHTEST
AIR MOVEMENT &
GAS SPILLAGE**

plumtest

SMOKE PEN
inc 6 Wicks

As seen on
VBA Training video

vba.vic.gov.au/carbon-monoxide-safety-program

- Specified for carbon monoxide testing
- HVAC air movement or leakage checks
- Comes with 6 smoke wicks
- Ideal for testing smoke alarms
- Refill packs of wicks available
- Non toxic, slow burning, smoke emitter

WONDER JUICE



UNLIKE OTHERS
WONDER
JUICE LID
WON'T
POP OFF

New generation product for sealing and locking brass and steel threads.

Wonder Juice can be used as a replacement for teflon and hemp.

- No more leaks
- Rated up to 3000kpa
- Sets hard, so it will never work loose
- Heat range -50C to 150C
- Environmentally friendly/non-flammable
- SGS approved for drinking water and air lines
- AGA approved for use on NG, LPG, TG & LLPG

Code: 9234

\$17.86 per tube



**SCREW
CAP**

Box of 10
\$110

\$11 per tube

INC GST



RED BACK



Quickie Kit



Connections to unit allow for height adjustment

Universal swivel fittings for sideways adjustment

Gas valve included 20mm

Kit comes complete with high performance tempering valve



24 Month warranty



Insulation & cable ties provided to comply with AS3500

Fit-off a hot water service in minutes!
Suits all instantaneous hot water services.

15mm outlet & tempering valve Code: 8300 | 20mm outlet & tempering valve Code: 8301

Andrew from AMT Plumbing in Bayswater said:

I recently tried the Quickie Kit on an install. I reckon it saved me at least 30-45 minutes. The insulation and cable ties included in the kit made for a nice neat finish. Everything I needed was there.

PRESS UNION BALL VALVE KIT

- A complete kit to suit your specific combination of gas and water connection
- Rubber Gaskets - Easy No Leak Sealing
- Gas Safety Certified



PRESS UNION BALL VALVE KIT
20mm GAS X 15mm WATER



\$88.33
INC. GST
Code: 8551

PRESS UNION BALL VALVE KIT
20mm GAS & WATER



\$88.33
INC. GST
Code: 8552

EXTENDO

GAS CONNECTOR



EXTENDABLE FROM 650mm - 1200mm

**Saves Space,
ONE Connector
does it all!**



APPROVED TO

AS/NZS 5601.1:2022



HANDY TIP:
Attach a brass
tee to either
end to create
a handle

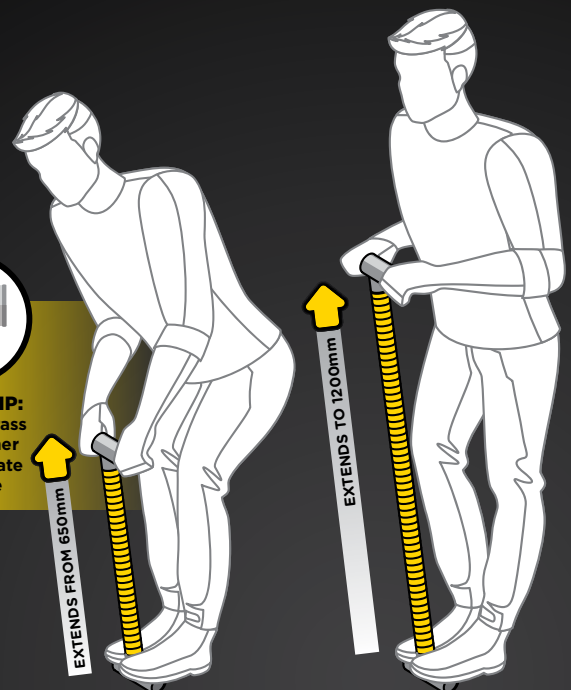

SPECIAL



**EXTENDO GAS
CONNECTOR**
650mm to 1200mm

1/2" M+F

\$19.80

Code: 6175



**EXTENDO GAS
CONNECTOR**
650mm to 1200mm

1/2" F+F

\$19.80

Code: 6177

- ✓ 12mm internal bore for better gas flow
- ✓ Flame resistant stainless steel
- ✓ 1/2" M+F & 1/2" F+F



AGA Approved 8633G

Valid until
31st August 2023

Also available in a box of 10

water TESTING

Flow Rate Cup Tester

- Scale measures flow rates of 0 to 17 litres per minute
- Measure water flow rates to determine if suitable flow is available prior to plumbing installation



\$38.67
INC. GST

Code 7276

Plumtest Thermometer Digital

- Measures temperatures from -50 degrees to 200 degrees Centigrade.
- It is perfect for checking the out flow temperature of hot water units, thermostatic mixers and tempering valves.
- Includes battery



\$43.67
INC. GST

Code 1324

Plumtest Test Bucket

- For pressure testing water systems are sealed and free from leaks
- Reliable and accurate test results
- Suitable for residential or commercial use



- 12L Solid Steel Bucket
- Quality 2 valve system

Kit includes:

- 1.5m long hose
- 4 spare washers

Code 9866



\$547.03
INC. GST



Plumtest Water Pressure Tester on Hose 2500 Kpa

- Universal brass connector will fit to 1 inch or 3/4 inch BSP thread
- Glycerin filled gauge protects workings
- High pressure hose allows flexibility to make reading gauge easier
- Dual scale reads in both KPa and PSI



Code 1119

\$98.24
INC. GST

INFLATABLE TEST PLUG 50mm

- To suit 50mm PVC
- 1.5m hose w/
Schroeder Valve
- Inflate with car pump

Note: Internal Pipe Size 45mm
to 60mm, Max Inflation 10psi,
(68kpa) with Schroeder Valve

Code: 9006

\$107.80



INFLATABLE TEST PLUG 150mm

- To suit 150mm PVC
- 1.5m hose w/
Schroeder Valve
- Inflate with car pump

Note: Internal Pipe Size 140mm
to 160mm, Max Inflation 10psi,
(48kpa) with Schroeder Valve

Code: 9007

\$176.00



TEST PLUG RIGHT ANGLED WITH HANDLES 100mm

- Keeps hands out of the drain
- A breeze to install
- Cannot be lost down drain
- The only plug to use when testing
at a right angled junction
- Cast Aluminium
- Patented

Code: 2004

\$153.16



plumtest

CHS CHRIS HUNTER
SALES



**EQUIPPED WITH
2.5m HOSE**

TEST PLUG ALUMINIUM

- A breeze to install
- 2 convenient tie-off points



90mm
Code: 8765

\$52.84



100mm
Code: 2149

\$52.84

plumtest

INFLATABLE TEST PLUG 100mm

- Equipped with 2.5m hose
- To suit 100mm PVC
- Inflate with car pump
- Can be used down an
inspection shaft

Code: 2009

\$105.67

plumtest



PRESS GAS FITTINGS



PRESS GAS COUPLING

CODE	SIZE	PRICE
8639	15mm	\$6.26
8640	20mm	\$8.04
8641	25mm	\$13.75



PRESS GAS SLIP REPAIR COUPLING

CODE	SIZE	PRICE
8642	15mm	\$6.00
8643	20mm	\$7.54
8644	25mm	\$11.69



PRESS GAS ELBOW F/F 90°

CODE	SIZE	PRICE
8645	15mm x 90	\$7.44
8646	20mm x 90	\$9.72
8647	25mm x 90	\$17.86



PRESS GAS ELBOW F/F 45°

CODE	SIZE	PRICE
8697	15mm x 45	\$8.50
8648	20mm x 45	\$11.60
8649	25mm x 45	\$15.46



PRESS GAS REDUCING COUPLING F/F

CODE	SIZE	PRICE
8650	20mm x 15mm	\$11.11
8651	25mm x 20mm	\$13.70



PRESS GAS REDUCER M/F

CODE	SIZE	PRICE
8652	20mm x 15mm	\$9.71
8653	25mm x 20mm	\$13.12



PRESS GAS TEE

CODE	SIZE	PRICE
8654	15mm	\$8.59
8655	20mm	\$14.81
8656	25mm	\$23.15



PRESS GAS TEE REDUCING

CODE	SIZE	PRICE
8657	20 x 20 x 15	\$15.29
8658	25 x 25 x 15	\$23.52
8659	25 x 25 x 20	\$26.00



PRESS GAS END CAP

CODE	SIZE	PRICE
8660	15mm	\$8.10
8661	20mm	\$9.13
8662	25mm	\$16.08



PRESS GAS ELBOW LUGGED

CODE	SIZE	PRICE
8663	15mm x 15FI	\$18.40
8664	20mm x 20FI	\$20.12



BLOCKHEAD PRESS GAS ELBOW LUGGED (90MM)

CODE	SIZE	PRICE
8698	15mm x 15MI	\$18.40



PRESS GAS ADAPTOR MI

CODE	SIZE	PRICE
8666	15mm x 15MI	\$5.51
8667	20mm x 20MI	\$13.59
8668	25mm x 25MI	\$21.39



PRESS GAS ADAPTOR FI

CODE	SIZE	PRICE
8669	15mm x 15FI	\$7.44
8670	20mm x 20FI	\$11.32
8671	25mm x 25FI	\$15.43



PRESS GAS SLIP TEE

CODE	SIZE	PRICE
8693	20mm	\$17.85

25 YEAR WARRANTY*

Brasshards is proud to offer a 25 year warranty against defects and manufacturing faults in CuPress fittings (when installed in accordance with national, state and local plumbing codes by a licensed plumber). Issues arising from incorrect installation, misuse or environmental elements are not covered by this warranty. Please contact Brasshards for a copy of our full warranty document.

PRESS WATER FITTINGS

- Flame-free
- Permanent V-Profile press join
- All fittings comply with Australian Standards AS3688



PRESS WATER COUPLING

CODE	SIZE	PRICE
8601	15mm	\$4.24
8602	20mm	\$6.28
8603	25mm	\$8.92



PRESS WATER SLIP REPAIR COUPLING

CODE	SIZE	PRICE
8604	15mm	\$4.81
8605	20mm	\$7.12
8606	25mm	\$10.78



PRESS WATER ELBOW F/F 90°

CODE	SIZE	PRICE
8607	15mm x 90	\$4.81
8608	20mm x 90	\$7.36
8609	25mm x 90	\$13.57



PRESS WATER ELBOW F/F 45°

CODE	SIZE	PRICE
8610	15mm x 45	\$6.01
8611	20mm x 45	\$8.28
8612	25mm x 45	\$15.24



PRESS WATER ELBOW M/F 90°

CODE	SIZE	PRICE
8681	15mm	\$5.55
8682	20mm	\$7.29



PRESS WATER REDUCING COUPLING F/F

CODE	SIZE	PRICE
8613	20mm x 15mm	\$9.61
8614	25mm x 20mm	\$16.39
8542	18mm x 15mm	\$21.89
8543	20mm x 18mm	\$24.22



PRESS WATER REDUCER M/F

CODE	SIZE	PRICE
8615	20mm x 15mm	\$8.62
8616	25mm x 20mm	\$12.24



PRESS WATER END CAP

CODE	SIZE	PRICE
8623	15mm	\$7.62
8624	20mm	\$9.23
8625	25mm	\$18.07



PRESS WATER TEE

CODE	SIZE	PRICE
8617	15mm	\$7.41
8618	20mm	\$11.17
8619	25mm	\$20.72



PRESS WATER TEE REDUCING

CODE	SIZE	PRICE
8620	20 x 20 x 15	\$13.85
8621	25 x 25 x 15	\$19.60
8622	25 x 25 x 20	\$23.53
8683	20 x 15 x 15	\$18.29
8684	20 x 15 x 20	\$19.24



PRESS WATER SLIP TEE

CODE	SIZE	PRICE
8692	15mm	\$11.96
8690	20mm	\$13.41
8694	20x20x15	\$16.84



PRESS WATER ELBOW LUGGED

CODE	SIZE	PRICE
8626	15mm x 15FI	\$13.69
8598	20mm x 15FI	\$16.71
8627	20mm x 20FI	\$19.53



BLOCKHEAD PRESS WATER ELBOW LUGGED (90MM)

CODE	SIZE	PRICE
8699	15mm x 15MI	\$16.76



PRESS WATER ELBOW FI

CODE	SIZE	PRICE
8629	15mm x 15FI	\$15.14
8630	20mm x 20FI	\$18.33



PRESS WATER ELBOW MI

CODE	SIZE	PRICE
8631	15mm x 15MI	\$14.59
8632	20mm x 20MI	\$18.34



PRESS WATER ELBOW UNION

CODE	SIZE	PRICE
8687	15mm x 1/2"	\$9.26
8688	20mm x 3/4"	\$13.98



PRESS WATER ADAPTOR MI

CODE	SIZE	PRICE
8633	15mm x 15MI	\$7.11
8680	15mm x 20MI	\$10.87
8691	20mm x 15MI	\$12.99
8634	20mm x 20MI	\$11.76
8635	25mm x 25MI	\$21.03



PRESS WATER ADAPTOR FI

CODE	SIZE	PRICE
8636	15mm x 15FI	\$6.75
8637	20mm x 20FI	\$8.62
8638	25mm x 25FI	\$15.36



PRESS UNION

CODE	SIZE	PRICE
8685	Loose Nut 15mm x 15mm Press (Flat Seat)	\$11.90
8679	Loose Nut 20mm x 20mm Press (Flat Seat)	\$13.38



PRESS UNION

CODE	SIZE	PRICE
8696	Loose Nut Compression 15mm x 15mm Press	\$10.47
8689	Loose Nut Compression 20mm x 20mm Press	\$10.80

BLOCK HEAD

**SAME PRICE AS A
TRADITIONAL LUGGIE!**

- Reduce the number of noggins required
- Can press it while in place
- Lead free brass
- 25 year warranty
- Fix it from any direction



WaterMark
TM

BRASSHARDS
EST. 1967
[PLUMBING SUPPLIES SPECIALIST]

PATENTED

**Blockhead Press
Water Elbow Lugged
15mm x 15MI (90mm)
CODE: 8699**

**Blockhead Press
Gas Elbow Lugged
15mm x 15MI (90mm)
CODE: 8698**



**PRESS WATER
ELBOW
LUGGED**

15mm x 15FI
CODE 8626 \$13.69

20mm x 15FI
CODE 8598 \$16.71

20mm x 20FI
CODE 8627 \$19.53



**PRESS WATER
ELBOW
LUGGED 90mm**

15mm x 15MI

\$16.75
INC. GST
CODE 8628



**PRESS GAS
ELBOW
LUGGED**

15mm x 15FI
CODE 8663 \$18.40

20mm x 20FI
CODE 8664 \$20.12



**NYLON
COMP ELBOW
LUGGED**

15MI x 15C

\$8.22
INC. GST
CODE AW1170



**NYLON
COMP ELBOW
LUGGED**

20FI x 20C

\$10.58
INC. GST
CODE AW1161



**COPPER
COMP ELBOW
LUGGED**

15FI x 15C

\$8.02
INC. GST
CODE AW2160



**COMP ELBOW
LUGGED**

15FI x 15C

\$7.85
INC. GST
CODE AW305



**COMP ELBOW
LUGGED
REDUCING**

15FI x 20C

\$13.18
INC. GST
CODE AW307



**COMP ELBOW
LUGGED**

15MI x 15C

\$9.41
INC. GST
CODE AW311



**NYLON
COMP ELBOW
LUGGED**

15FI x 15C

\$7.18
INC. GST
CODE AW1160



CYLINDER LIFTING STRAP

CODE: 5087

- 2.4m Length
- Australian Design
- Assists in moving a cylinder in tight/ difficult spots



New!

plumtool™

Innovative tools for PLUMBERS

CHROME PLATED BRASS

Chrome plated All brassware complies with AS3688

ALL PRICES INCLUDE GST

MUST HAVE!



LOOSE NUT EXTENSION
15mm X 50mm C/P
CODE: 6582 | \$7.40



KINKO NUTS CONE
15mm C/P
CODE: AW277 | \$3.03



ELBOW FI
15mm C/P
CODE: AW549 | \$6.05



ELBOW M X F
15mm C/P
CODE: AW563 | \$5.28



HEX NIPPLE
15mm C/P
CODE: AW665 | \$3.85



SOCKET HEX
15mm C/P
CODE: AW518 | \$4.90



TEE FI
15mm C/P
CODE: AW405 | \$9.24



HEX CAP SCREWED
15mm C/P
CODE: AW536 | \$2.86

We have an extensive range of standard line fittings, available in screwed or compression designs. Other non-standard fittings may be supplied on request.



All Brassware complies with AS3688



Jacko's Review

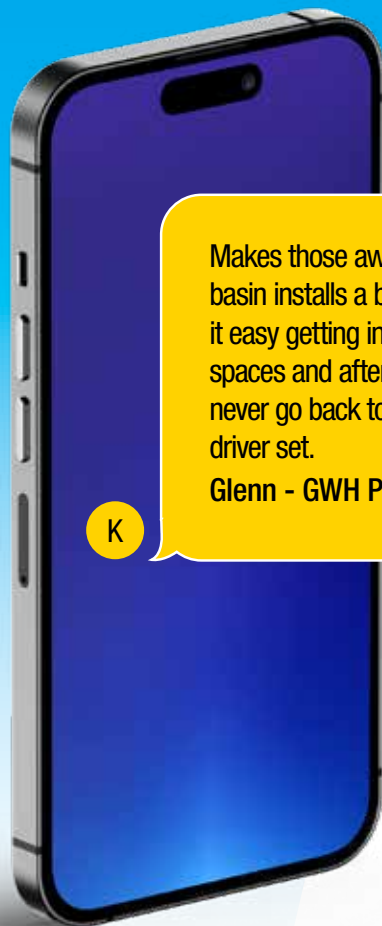

Makes those awkward under basin installs a breeze, makes it easy getting into those tight spaces and after using this I'd never go back to a rigid shaft driver set.

Glenn - GWH Plumbing & Gas

K

Valid until 31st August 2023

NOW
\$95.36

SAVE \$24.84

CODE: 9828



plumtool™

FLEXIBLE MIXER TAP DRIVER KIT

- Flexible shaft for tight spaces
- Extra long sockets (120mm)

Kit Contains:

- 3/8 Flexible Drive (200mm long)
- 3/8 Hex Adaptor (40mm long)
- 3/8 Drive Socket Set: 9mm x 120mm, 10mm x 120mm, 11mm x 120mm, 12mm x 120mm, 13mm x 120mm

**IDEAL
FOR TIGHT
SPACES**





down pipe
fixing can
be tricky,
**but we
have the
answers**

Hebel Anchor

Spiral-shaped
ribs cut a positive
fit in the hebel

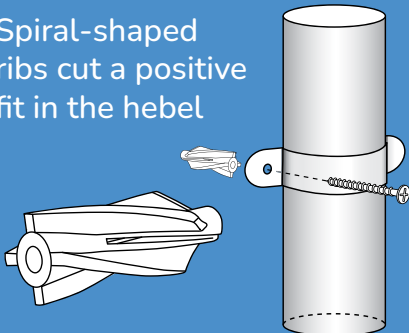

*Spiral shaped
ribs lock into
Hebel*

8mm

\$71.50
INC. GST

CODE 1295

BAG QTY: 50

Styroscrew

A screw type
fastening for
polystyrene walls

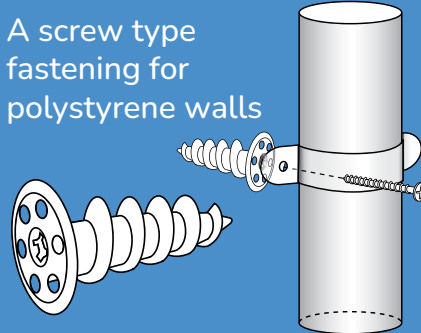

*Great for fixing
downpipes
to foam walls*

\$70.29
INC. GST

CODE 1223

BAG QTY: 50

Wall Plugs

Tapered end
Green



35mm x 6.5mm

\$12.55
INC. GST

CODE 9934

BOX QTY: 50

35mm x 6.5mm

\$63.62
INC. GST

CODE 9168

BOX QTY: 500

Black Nylon Tap Ins



UV stabilised for outdoor use
Galvanized nail will not rust

5mm x 40mm

\$114.41
INC. GST

CODE 1187

BOX QTY: 500

5mm x 25mm

\$81.76
INC. GST

CODE 9524

BOX QTY: 500

Styrowedge

Great for fixing
downpipes to
foam walls

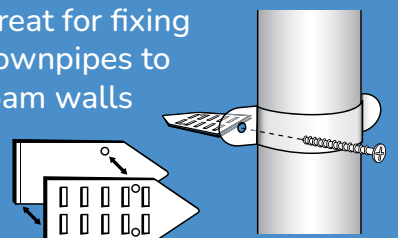

\$58.42
INC. GST

CODE 1222

BAG QTY: 50



**ONE KIT DOES
TWO JOBS**

COMBO DIGITAL GAS MANOMETER

Code: 1826

- Operating Range 0 kPa to 10 kPa
- Accuracy 0.5% over Operating Range
- Operating Temperature -10°C to 95°C

Kit contains:

- Digital Gauge with click on connection
- 700mm Rubber Hose with click on connection
- Testing Tee with click on connection
- Hand Bellows

**GAS LINE
TESTING**

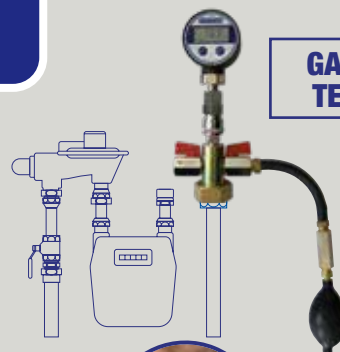

**APPLIANCE
TESTING**

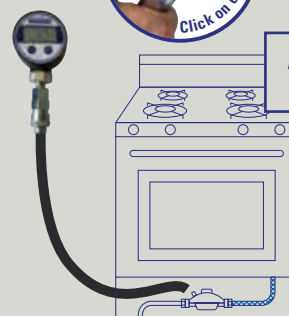

BACK IN STOCK

**AVOID A
SHOCKING
EXPERIENCE!**



BONDING STRAP

Code: 1527



- Always use when disconnecting or cutting a gas or water pipe
- Industrial Plumtest quality cable and clamps
- Clamp Capacity - 8mm to 32mm
- Cable 1400mm long x 16mm
- Rated to 200AMPS
- Comply with AS3500.1 2003