

SEE INSIDE
FOR YOUR
CHANCE TO
WIN



WHERE'S JACKO?

plumbers
choice **TRADE ONLY**

489 Mountain Highway, Bayswater, VIC 3153
Email: info@plumberschoice.com.au • Ph: (03) 9720 8274

www.plumberschoice.com.au



Luke's Editorial



Plumbers Choice was the first Trade Only Plumbing Supplier in the country, it's something to this day we are very proud of. Since then we are just as proud of the other suppliers who have followed suit in trying to change our industry for the better and have now become Trade Only also.

We still have to ask, Where are the industry's biggest players? And why won't they support a Trade Only industry?

Jacko has been a regular in our Magazines since day dot, he has been a symbol for a Trade Only Plumbing Industry. While the major suppliers are nowhere to be found, our friend Jacko is.

So in support of creating a stronger Plumbing Industry we are **giving away a \$500 Plumbers Choice Gift Voucher** to the first Plumber to correctly identify **how many Jacko's are hidden throughout this edition of the magazine.**

Simply email **marketing@plumberschoice.com.au** with your guess of how many times Jacko features in this edition of the magazine; The first plumber to submit the correct answer WINS!*

**Entries only open to Plumbers Choice customers*

LUKE BOLTON
DIRECTOR, PLUMBERS CHOICE

plumbers choice
TRADE ONLY



HOW TO ORDER



Online - 24 hours
www.plumberschoice.com.au



Email - 24 hours
sales@plumberschoice.com.au



Phone - Business Hours
(03) 9720 8274
Our knowledgeable staff will take your order.



At our Trade Outlets
Monday - Friday
489 Mountain Highway, Bayswater, VIC 3153
4/200 Woodpark Road, Smithfield, NSW 2164



Personal Sales Rep
Your personal Sales Representative is able to tailor our service to suit your needs.



Shop Trade Only from the palm of your hand!

SPECIAL

TEMPERING VALVES

ONLY
\$44.00
INC. GST



15mm

YELLOW CAP 15mm

- Suitable for storage hot water systems
- Insulation included
- 2 year warranty
- Conforms AS4032.2 LIC No. 20137

Code: 6810

ONLY
\$66.00
INC. GST



15mm

ORANGE CAP 15mm

- Suitable for solar and instantaneous hot water systems
- Insulation included
- High performance
- 2 year warranty
- Conforms AS4032.2 LIC No. 20137

Code: 6811

Valid until 30th June 2022

AVG
Australian Valve Group

W
WaterMark

Same day delivery for Sydney and Melbourne Metro



PLUMTEST MANOMETER

Designed to meet all requirements of the professional plumber

- Aluminium case
- Durable cover protects calibrations
- 300mm manometer for appliance testing
- 800mm manometer for line testing
- Magnet is riveted to the back of the 300mm manometer case to allow the manometer to be attached to an appliance
- Comes with rubber connecting hose

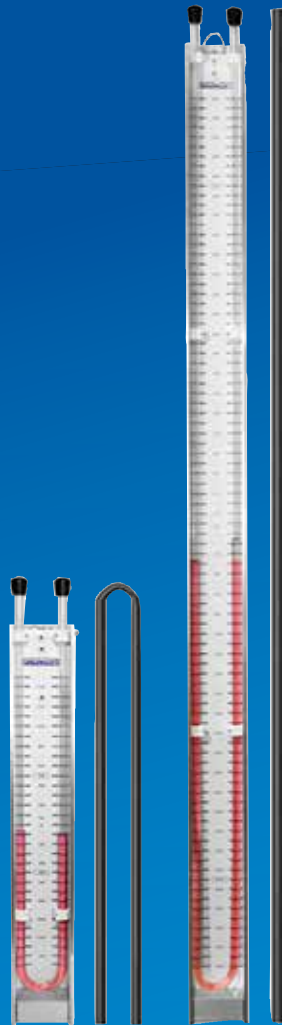

300mm

\$128.82

Code: 1870

800mm

\$160.53

Code: 1743



PLUMTEST HAND BELLOWS WITH BRASS VALVE

- Used to inflate gas lines
- Complete with brass check valve
- Fast & accurate way to pressurise gas lines

\$76.32

Code: 1437

TURNING UP THE HEAT THIS WINTER



PLUMTEST MANOMETER TEST TEE

- Used in conjunction with standard manometers to pressure test gas fitting lines
- Italian made ball valves

\$92.25

Code: 1744



**AVOID A
SHOCKING
EXPERIENCE!**

PLUMTEST BONDING STRAP

- Always use a bonding strap when disconnecting or cutting a gas or water pipe
- Industrial Plumtest quality cable and clamps
- Clamp Capacity - 8mm to 32mm
- Cable 1400mm long x 16mm
- Rated to 200AMPS
- Comply with AS3500.1 2003

\$115.76

Code: 1527

Jacko's Review



Combo Digital Gas Manometer

1 kit does 2 jobs

- Operating Range 0 kPa to 10 kPa
- Accuracy 0.5% over operating range
- Operating Temperature -10°C to 95°C

SPECIAL

ONLY \$473.00

INC. GST

Code: 1826

SAVE \$138.78

Great product, easy to use.
Precise with no fluctuation of pressure.
Does exactly what you want.
Matt Lovric

Bought 3 for my guys. They have
been great and easy to use.
Take up no space.
Brendan Urban Tide Plumbing

Makes testing quicker.
Easy to adapt from
appliances to lines.
Grant Prowater Plumbing



Gas Line
& Appliance
Testing

**GAS LINE
TESTING**

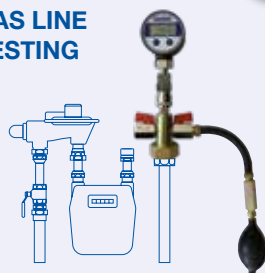

**APPLIANCE
TESTING**

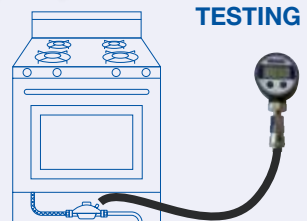

Valid until 30th June 2022

CARBON MONOXIDE ANALYSER

NEW

- Suitable for testing as per VBA Carbon Monoxide Safety Program
- Measures carbon monoxide in ambient applications as well as high heat flue situations
- Measures 0 ~ 10,000 ppm CO
- Save and recall readings with time and date stamp
- Pump driven
- 1 PPM sensitivity
- Infrared port for use with optional A740 IR printer



COMES IN STURDY CARRY CASE

Code: 8020

FREE SMOKE PEN WITH ANALYSER
Valid until June 30th 2022



SMOKE PEN

NEW



\$86.26 INC. GST
Code: 9837



- Specified for carbon monoxide testing
- Ideal for testing the slightest air movement & gas spillage
- HVAC air movement or leakage checks
- Comes with 6 smoke wicks
- Refill packs of wicks available
- Non-toxic

As seen on VBA Training video www.vba.vic.gov.au/carbon-monoxide-safety-program

CHS CHRIS HUNTER SALES

THERMOCOUPLE TESTING AND TOOL KIT



Testing and replacement made easy



1
Unscrew the existing thermocouple from the control unit of the appliance.



2
Fit the end of the thermocouple into the tester. (If you need to, use the universal bush provided, you may need to gently flatten a section of the thermocouple tube to slip the bush on)



3
Light the pilot using the normal method for the appliance.



4
Whilst continuing to hold down the button on the appliance for 20 seconds, depress the spring on the testing device at the same time.



5
Release pressure on the thermocouple testing device spring only.

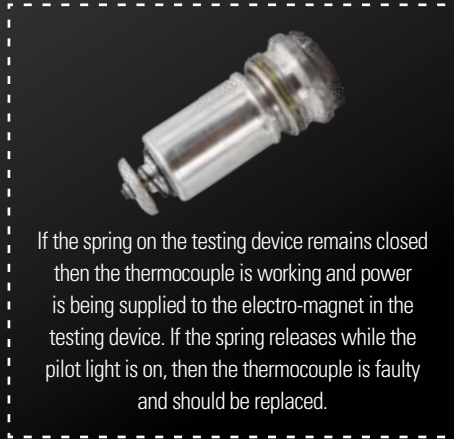

If the spring on the testing device remains closed then the thermocouple is working and power is being supplied to the electro-magnet in the testing device. If the spring releases while the pilot light is on, then the thermocouple is faulty and should be replaced.

plumtool™

- This kit includes spanners to suit any thermocouple and also includes a testing device to determine if the existing thermocouple is still working.

\$227⁶⁹
INC. GST
Code: 5301

A simple lifting strap

Developed by an
EXPERIENCED PLUMBER



**CYLINDER
STRAP**

\$121 INC. GST

CODE 5087

- Australian Made & Designed
- Cylinder Lifting Aid
- 2.4m Length
- Assists in moving a cylinder in tight/difficult spots
- Put handles on your HWS for easy lifting



Hanging Clips

Pipes will hold tightly and securely.
These pipe supports are **built to last.**



powder coated

Adjustable PVC Pipe Hanging Clip

Galvanised/Powder
Coated White
Easy Installation

100 mm
Suits 100mm
DWV Pipe

Code: 9060
\$5.36 INC. GST

90 mm
Suits 90mm
DWV Pipe

Code: 9061
\$5.19 INC. GST

65 mm
Suits 65mm
DWV Pipe

Code: 9062
\$4.98 INC. GST

50 mm
Suits 50mm
DWV Pipe

Code: 9063
\$4.83 INC. GST

40 mm
Suits 40mm
DWV Pipe

Code: 9064
\$4.68 INC. GST

*450mm
hanger*



PVC Pipe Hanging Clip

Galvanised/Powder
Coated White
450mm Hanger
Easy Installation

100 mm
Suits 100mm
DWV Pipe

Code: 9065
\$5.80 INC. GST

90 mm
Suits 90mm
DWV Pipe

Code: 9066
\$5.59 INC. GST

65 mm
Suits 65mm
DWV Pipe

Code: 9067
\$5.46 INC. GST

50 mm
Suits 50mm
DWV Pipe

Code: 9068
\$5.26 INC. GST

40 mm
Suits 40mm
DWV Pipe

Code: 9069
\$5.10 INC. GST



BAL RATED DRAINAGE VENT & FLASHING KIT

Kit includes:

- Steel vent and cowl
- BAL rated flashing to suit steel roof
- Steel to PVC insulated adaptor

BAL12.5
Black Flashing Kit

Code: **8876**



BAL29
Red Silicone Kit

Code: **8877**

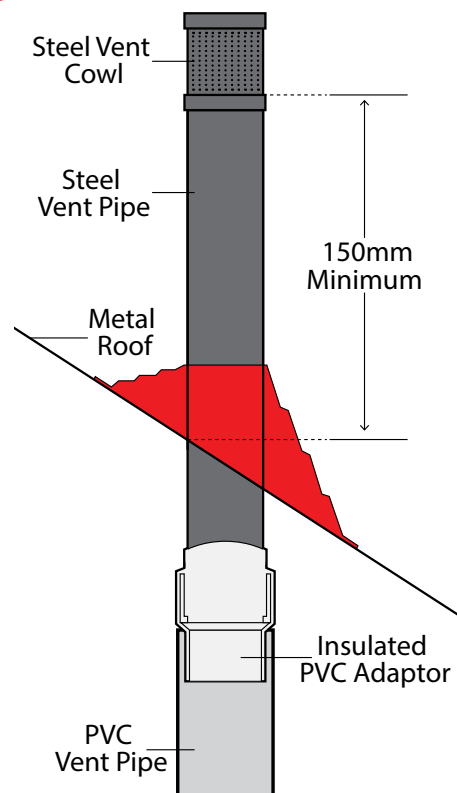

NEW MAGNETIC BUCKET

- Lightweight
- 5 built in magnets
- Non slip up to 40° pitch
- Use on corrugated sheets

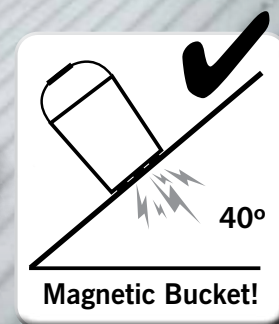
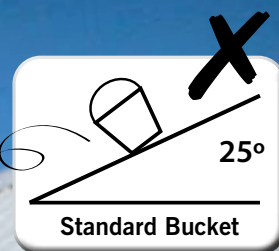



PLUMTOOL

EOFY SPECIALS



**JUNE
30**

Valid until
30th June 2022

**GULLY
GRABBER**

\$200 INC. GST

CODE 2610

SAVE \$78.26



**TUBE
SPANNER
KIT**





WIDE OPENING SHIFTER SET

\$135

INC. GST

CODE 5012

SAVE \$52.42

TRAP DRILL



\$50

INC. GST

CODE 2601

SAVE \$18.93

7 PIECE TURN UP TOOL



\$200

INC. GST

CODE 1754

SAVE \$80.60

\$135

INC. GST

CODE 2513

SAVE \$56.43



\$126.50

INC. GST

CODE 9885

DELUXE MIXER TAP SOCKET SET

SAVE \$48.27

RECYCLED WATER KITS

NOW AVAILABLE IN SEPERATE ROUGH-IN AND FIT OFF KITS

RECYCLED WATER ROUGH-IN KIT

FOR EASE AT ROUGH-IN STAGE

KIT INCLUDES:

- 5/8" Male 180mm x 3/4" BSP Female Extended Lugged Elbow
- 5/8" Male x 3/4" BSP Female 19BP Lugged Elbow 90mm Long
- 2 x 5/8" Brass Cap
- Commonly installed within Victoria

CODE: 4911



RECYCLED WATER FIT OFF KIT

KIT INCLUDES:

- 5/8" Female Hose Bib Anti-Vandal
- Anti-Vandal Key
- Cover Plate & Sign
- 5/8" Female X 3/4" Male Washing Machine Stop
- Cover plate
- 3/4" Plastic Cap With Washer To Suit Washing Machine Stop
- Commonly installed within Victoria

CODE: 4912



LOOK
FAMILIAR?
HERE'S THE
SOLUTION



RECYCLED WATER KIT

HOSE TAP WITH ELBOW 18mm

- 5/8" Female Hose Bib Anti-Vandal
- 5/8" Male 180mm x 3/4" BSP Female Extended Lugged Elbow
- Includes: 5/8" Brass Cap, Anti-Vandal Key, Cover plate & Sign
- L/H Thread
- Commonly installed within Victoria

CODE: 4915



RECYCLED WATER DO NOT DRINK METAL SIGN

LILAC ON WHITE 100x75mm



- Commonly Used NSW, VIC
- Metal 100mm x 75mm
- Recycled Do Not Drink

CODE: 2522

RECYCLED HOSE COCK KIT

WITH HOSE ADAPTOR, KEY & SIGN

- 3/4" Male Hose Bib Anti-Vandal
- Includes: Hose Adaptor, Anti-Vandal Key & Sign
- Commonly installed within NSW

CODE: 4914



RECYCLED WASHING MACHINE KIT

- 5/8" Female X 3/4" Male Washing Machine Stop
- 5/8" Male x 3/4" BSP Female 19BP Lugged Elbow 90mm Long
- Includes: 5/8" Brass Cap, Cover plate

CODE: 4916



RECYCLED LOOSE NUT WASHING MACHINE KIT

With Lugged Elbow 90mm



- 5/8" Female X 3/4" Male Loose Nut Washing Machine Stop
- 5/8" Male x 3/4" BSP Female 19BP Lugged Elbow 90mm Long
- Includes: 5/8" Brass Cap, Cover plate

CODE: 4917



Quickie Kit



Connections to unit allow for height adjustment

Universal swivel fittings for sideways adjustment

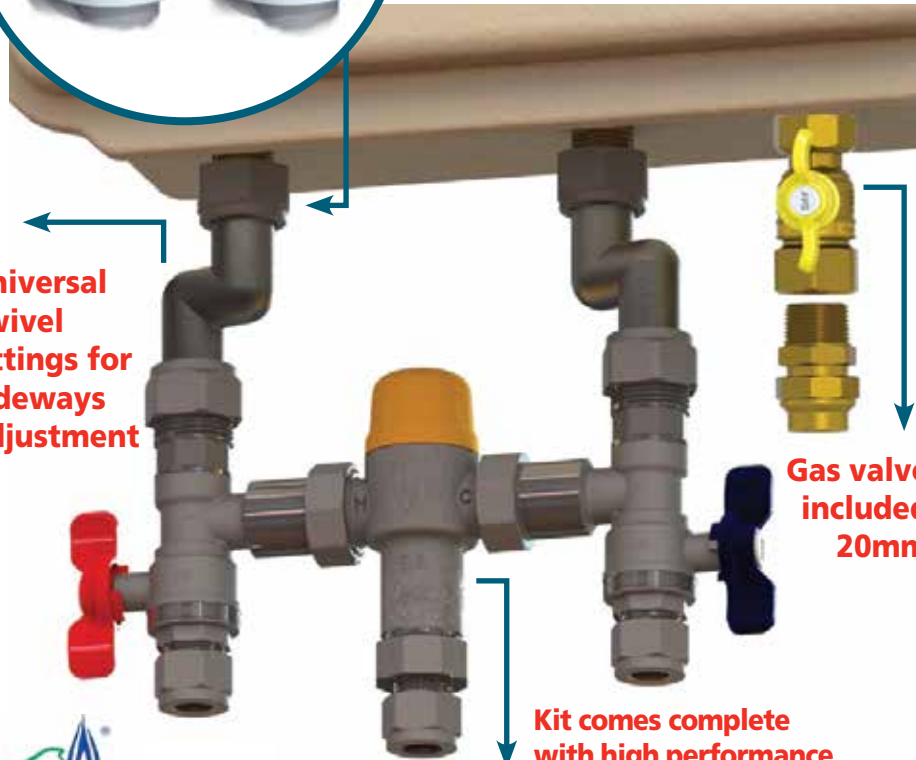

Gas valve included 20mm

Kit comes complete with high performance tempering valve



24 Month warranty



Insulation & cable ties provided to comply with AS3500



Fit-off a hot water service in minutes!
Suits all instantaneous hot water services.

15mm outlet & tempering valve Code: 8300 | 20mm outlet & tempering valve Code: 8301

Andrew from AMT Plumbing in Bayswater said:

I recently tried the Quickie Kit on an install. I reckon it saved me at least 30-45 minutes. The insulation and cable ties included in the kit made for a nice neat finish. Everything I needed was there.

PRESS UNION BALL VALVE KIT

- A complete kit to suit your specific combination of gas and water connection
- Rubber Gaskets - Easy No Leak Sealing
- Gas Safety Certified



PRESS UNION BALL VALVE KIT
20mm GAS X 15mm WATER



\$88.33
INC. GST
Code: 8551

PRESS UNION BALL VALVE KIT
20mm GAS & WATER



\$88.33
INC. GST
Code: 8552



MONACO™

Universal Cistern with Link and Seat

Code: 2090

**Upgrade to the Brand
Trusted by Professionals and
Toilet Manufacturers Worldwide**

- Extra Easy Install Features Built-in
- 4.5/3L Dual Flush Technology
- Simple Flush Volume Conversion to 6/3L or 9/4.5L
- Plastic Cistern with Bottom Inlet
- UV Resistant - Certified
- Saves Water



EQUIPPED WITH FLUIDMASTER TECHNOLOGY



Inlet Valve
400UK063



Outlet Valve
560AU02



FLUIDMASTER PRO CISTERN

Most Powerful Flush System
Adjustable up to 9/4.5L PRO Cistern
with Link and Seat



- 4.5/3L Dual Flush Technology
- Simple Flush Volume Conversion to 6/3L or 9/4.5L
- UV Resistant - Certified
- Plastic Cistern with Bottom Inlet
- Saves Water
- **INSTALL WITH CONFIDENCE**

\$109¹⁰
INC. GST

Code: 2089



DISHWASHER COVER PLATES

- Leave a neat finish in the cupboard
- Keeps pests out
- Fits over the solenoid valve

Code: 1792



MULTI PURPOSE COVER PLATE

Suitable for Washing Machines & Dishwashers

- Leave a neat finish in the cupboard
- Covers a hole in the cupboard up to 120mm x 115mm
- Keeps pests out
- Fits hot & cold hoses, power cord, Optional outlet hose cap

Code: 1796

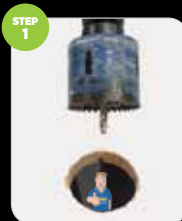

- For a professional finish inside the cupboard.
- Flexy Flange cupboard plate fits tight to pipe which makes it ant-proof.

1 Flexy Flange Fits 4 Sizes!



80mm

Suits 9-22mm pipe

Small

Pack Qty 10

\$22.64 INC. GST

Code: 8250

PATENTED



90mm

Suits 22-44mm pipe

Medium

Pack Qty 5

\$15.04 INC. GST

Code: 8252

PATENTED

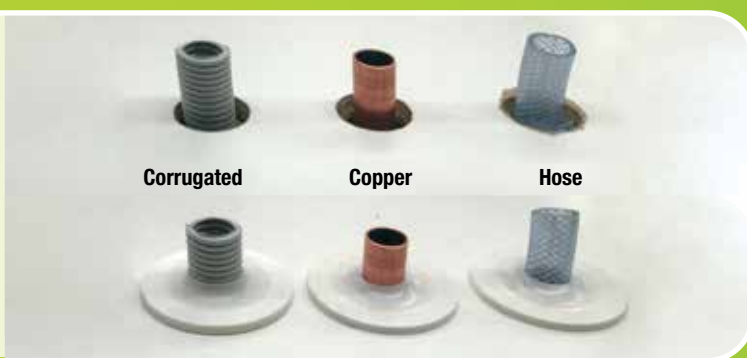

105mm

Suits 40-60mm pipe

Large

Pack Qty 5

\$16.74 INC. GST

Code: 9968

PATENTED



115mm

170mm

Suits 40-60mm pipe

Rectangle

Pack Qty 5

\$22.26 INC. GST

Code: 2202

PATENTED





DOUBLE BOWL CONNECTOR

CODE	SIZE	PRICE
2804	50mm x 350mm	\$12.50
2839	50mm x 600mm	\$27.04



P-TRAP

CODE	SIZE	PRICE
2799	40mm	\$11.21
2798	50mm	\$11.21



COMBO S&P TRAP

CODE	SIZE	PRICE
2802	40mm	\$10.88
2803	50mm	\$12.35



P-TRAP SHORT LEG

CODE	SIZE	PRICE
2796	40mm	\$15.69
2797	50mm	\$15.69



COUPLING PVC THREADED MI

CODE	SIZE	PRICE
2823	40mm	\$2.17
2825	50mm	\$2.17



COUPLING PVC THREADED FI

CODE	SIZE	PRICE
2822	40mm	\$2.17
2824	50mm	\$2.17



SPIGOT ADAPTOR MI

CODE	SIZE	PRICE
2631	40mm	\$4.51
2629	50mm	\$5.07



SPIGOT ADAPTER FI

CODE	SIZE	PRICE
2632	40mm	\$4.51
2630	50mm	\$5.07



SLAB REPAIR COUPLING

CODE	SIZE	PRICE
2623	40mm	\$7.61
2624	50mm	\$6.89



M/F IN PIPE BENDS 88°

CODE	SIZE	PRICE
2626	40mm x 88 Degree	\$5.07
2625	50mm x 88 Degree	\$5.45



BENDS 88° PLAIN F/F DWV

CODE	SIZE	PRICE
2808	40mm x 88 Degree	\$1.95
2809	50mm x 88 Degree	\$2.26



BENDS 88° M/F DWV

CODE	SIZE	PRICE
2816	40mm x 88 Degree	\$4.98
2818	50mm x 88 Degree	\$4.98



BEND 45° PLAIN F/F DWV

CODE	SIZE	PRICE
2806	40mm x 45 Degree	\$1.95
2807	50mm x 45 Degree	\$2.26



M/F BENDS 45° DWV

CODE	SIZE	PRICE
2815	40mm x 45 Degree	\$3.17
2817	50mm x 45 Degree	\$3.73



JUNCTION PLAIN 88°

CODE	SIZE	PRICE
2837	40mm x 88 Degree	\$7.98
2836	50mm x 88 Degree	\$7.98



JUNCTION PLAIN 45°

CODE	SIZE	PRICE
2628	40mm	\$7.98
2627	50mm	\$7.98

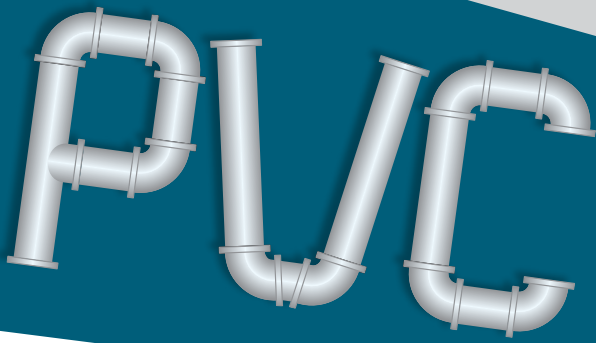

ALL PVC
COMPLIES
WITH
ASNZ1260

WE HAVE A GREAT
RANGE OF DWV
FITTINGS TO COVER ALL
YOUR FIT OFF NEEDS

*ALL PRICES INCLUDE GST

FITTINGS



VENT COWL

CODE	SIZE	PRICE
2829	50mm	\$3.16



WEATHERING APRON

CODE	SIZE	PRICE
2633	50mm	\$2.45



AIR ADMITTANCE VALVE

CODE	SIZE	PRICE
2465	32mm, 40mm, 50mm	\$47.32



LEVEL INLET TAPER

CODE	SIZE	PRICE
2622	40mm x 50mm	\$4.50



SOCKET REDUCER

CODE	SIZE	PRICE
2620	40mm x 50mm	\$4.51



PIPE REDUCER

CODE	SIZE	PRICE
2621	40mm x 50mm	\$6.34
2618	100mm x 40mm	\$5.12
2619	100mm x 50mm	\$5.12



TRAP ADAPTOR

CODE	SIZE	PRICE
2795	32-40mm	\$2.53



TRAP EXTENSION WITH OVERFLOW

CODE	SIZE	PRICE
2784	50mm x 60mm	\$14.37



TRAP EXTENSION

CODE	SIZE	PRICE
2780	40mm x 25mm	\$9.61
2781	50mm x 25mm	\$9.61



TRAP EXTENSION SOLVENT WELD

CODE	SIZE	PRICE
2782	40mm x 200mm	\$27.43
2783	50mm x 200mm	\$27.43



PAN COLLAR 100MM

CODE	SIZE	PRICE
2800	Standard	\$10.25
2801	20mm Offset	\$10.25



FLEXI FIN PAN COLLAR

CODE	SIZE	PRICE
2821	100mm	\$17.78
2820	20mm Offset	\$18.48
2634	40mm Offset	\$24.52

YOU SHOULD ALWAYS USE A DINGER



\$34.80
Code: 2730

FLEXIDINGER BATH BRASS/CHROME 40mm x 350mm

- Ideal for varying angles and gradients where space below taps & baths is limited
- Flexible tube is suitable for solvent welding
- Tube can be cut to required length



\$29.49
Code: 2733

FLEXIDINGER CAP LINING ELBOW

- Ideal for varying angles and gradients where space below taps & baths is limited
- Flexible tube is suitable for solvent welding
- Tube can be cut to required length



\$30.15
Code: 2732

PLUMBDINGER BATH CONNECTOR CHROME PLATED 40mm

- Adjustable inlet setout
- Suitable for 40mm & 50mm outlet pipe
- PVC plug



\$28.51
Code: 2731

HUMDINGER CHROME PLATED BRASS 40mm

- Cut 40mm DWV Pipe to desired length and push into Humdinger Elbow
- Chrome Waste

MONUMENT PVC CUTTERS



QUICK & CLEAN CUT!



**PIPE CUTTER
AUTOCUT MONUMENT
50MM PVC**

\$53⁰²

INC. GST
Code: 2645



**PIPE CUTTER
AUTOCUT MONUMENT
40MM PVC**

\$49⁷²

INC. GST
Code: 2644

**GREAT
FOR 40MM
& 50MM
POLY**

- Quality UK designed and made
- Quick and clean cut
- Light weight
- Ideal for confined spaces
- Spare blades available



PIPE CUTTER SPARE BLADES
For Monument PVC Autocutters Per 5

- Spare blade suits both 40 & 50mm cutters

\$17⁰⁵

INC. GST
Code: 2646

MONUMENT TOOLS

BULK SPECIAL

EZY FIT CONNECTORS PEX LINED BURST PROOF



EZY FIT WATER CONNECTOR

- Burst Proof Inner Core
- 1/2"Female x 1/2"Female Connection
- Premium 8mm Straight Water Hose

225mm QTY 25 Code: 5100
300mm QTY 25 Code: 5101
450mm QTY 25 Code: 5102



\$88.00
INC. GST

**BURST
PROOF
10 YEAR
WARRANTY**



EZY FIT WATER CONNECTOR M & F EXTENSIONS

- Burst Proof Inner Core
- 1/2"Male x 1/2"Female Connection
- Ideal for extending mixer tails that are too short

150mm QTY 20 Code: 5009 \$88.00
225mm QTY 20 Code: 9155 \$99.00



10 Pairs

225mm
\$99.00
INC. GST

150mm
\$88.00
INC. GST

Valid until 30th June 2022



NEW!

WOMBAT



- Australian Designed
- Brass Shroud prevents spreading and splitting
- Tough NP3 compound which is heat resistant and hardwearing
- Passes 100,000 cycle test
- Complies with AS3718

10 Pack
Code: 8810

100 Pack
Code: 8811

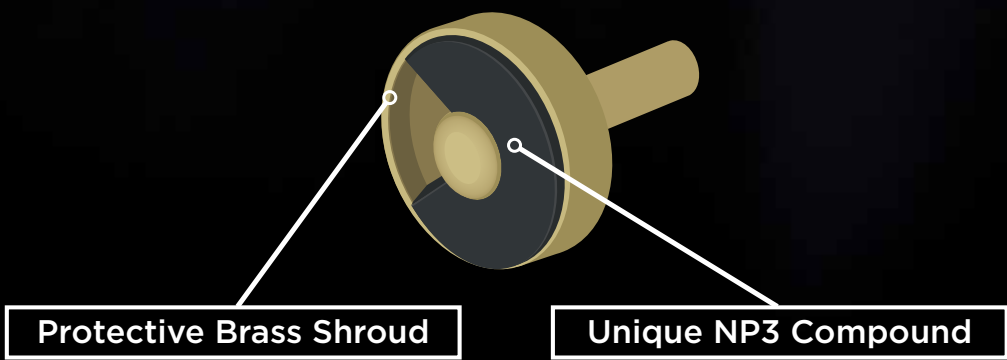

Protective Brass Shroud

Unique NP3 Compound



SPECIFICALLY DESIGNED FOR CUTTING PVC



**30% MORE
EFFICIENT THAN
STANDARD BLADES**

**CUTS STRAIGHT
EVERYTIME**

**BATTERIES
LAST LONGER**

**CUT IS FREE
OF BURRS**



SAMURAI RECIPROCATING SAW BLADE PVC

• 210mm • 16TPI • Made in Japan

**AVAILABLE IN A
BOX of 10**

\$19⁵¹ EACH
INC. GST

Code: 9632

COPPER ROUNDING TOOL

NEW

3/4" \$55.⁶⁴
INC. GST

Code: 9898

Suitable for 3/4" copper tube

1/2" \$52.⁸⁸
INC. GST

Code: 9988

Suitable for 1/2" copper tube



**ROUNDS
OUT
COPPER IN
SECONDS!**



- Saves time
- Nuts slide on easily
- Great frustration saver
- Lightweight and compact

plumtool™

Innovative tools for **PLUMBERS**

EXTENDO

GAS CONNECTOR

F + F NOW AVAILABLE



BROMIC
PLUMBING & GAS

Extendable
from **650mm**
to **1200mm**

- ✓ Saves Space, **ONE Connector does it all!**
- ✓ 12mm internal bore for better gas flow
- ✓ Flame resistant stainless steel
- ✓ AGA Approved 8633G
- ✓ 1/2" M+F
- ✓ 1/2" F+F

HANDY TIP:
Attach a brass tee to either end
to create a handle

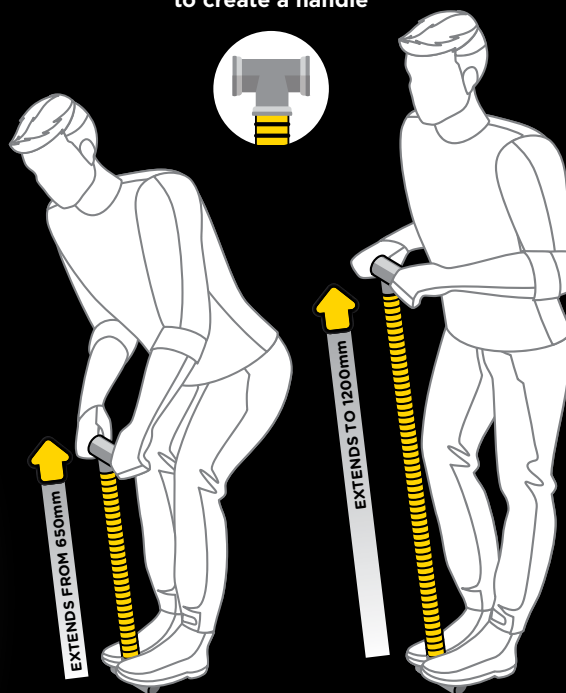

BOX
10

\$246.⁷⁸
INC. GST

M+F Code: 6176
F+F Code: 6178

FASTANOG BLOCK

4x FASTER

- Pre-loaded with bugle screws
- Set back measurer
- Fits small spaces
- Strong and versatile

CODE: 1475

AVAILABLE IN A
BOX OF 10



FASTANOG

PRELOADED WITH HEX SD SCREW

Extends 330mm – 600mm



Drill



Hex SD Screw



CODE: 1471



PRELOADED WITH BUGLE SCREW

Extends 330mm – 600mm



Drill



Bugle Screw

CODE: 1464



MINI PRELOADED WITH BUGLE SCREW

Extends 190mm – 330mm



Drill



Bugle Screw

CODE: 1474



SAY GOODBYE TO TIMBER NOGGINS

PATENTED

YOU SPOKE, WE LISTENED!

To continue to make things easier for you to support Trade Only, we've made a few additions to www.plumberschoice.com.au



ORDER TEMPLATES

Save Order Templates

You can now save custom Order Templates.

With just one click, add all the items from your Order Template to your shopping cart. Perfect for fit off packs, hottie kits or end of month stock top ups.



FAVOURITES

Favourite Items

Access to your favourite and most used items on the one page.

No more scrolling through to add the same items you buy every order. Now add them all from the convenience of one page.



QUOTES

Request a Quote

Want some gear quoted?

Haven't had some items priced up by your Sales Rep yet? Well, from the cart page you can now order or request a quote on the gear in your shopping cart.

Don't have an online account yet?

Head to www.plumberschoice.com.au/register/ and sign up today. Order any time from the convenience of your phone or laptop.



TIP OF
THE
MONTH

We'll tip
YOU
when you tip
US!



Every featured story receives a
\$200 Store Credit

Instead of getting down on your hands and knees to pickup rivets and off cuts of flashing, duct tape a magnet to a pole and pick it all up in seconds without bending over.

Courtesy;
Belvedere Air
and Plumbing



Thanks to - Belvedere Air and Plumbing
\$200 store credit is coming your way

To get involved send us an email info@plumberschoice.com.au

REPAIR CLAMPS

FOR PEX PIPE

REPAIR CLAMP FOR PEX PIPE 16mm

- Suits 16mm PEX
- Solid brass
- 4 bolts easy installation
- Full circle nitrile rubber gasket
- Pressure rating to 1600kpa
- Approved for use on potable water
- Fits all PEX systems currently being sold



Code: 5058 **\$42.65** inc. GST

REPAIR CLAMP FOR PEX PIPE 20mm

- Suits 20mm PEX
- Solid brass
- 4 bolts easy installation
- Full circle nitrile rubber gasket
- Pressure rating to 1600kpa
- Approved for use on potable water
- Fits all PEX systems currently being sold



Code: 5059 **\$47.60** inc. GST

FOR COPPER

REPAIR CLAMP FOR COPPER 15mm

- Stainless Steel Band Simple to install
- Suits 1/2 inch copper
- Made from 316 stainless steel
- Full circle nitrile rubber gasket
- Pressure rating of 1600kPa
- Approved for use in potable water supply



Code: 5060 **\$42.52** inc. GST

REPAIR CLAMP FOR COPPER 20mm

- Stainless Steel Band Simple to install
- Suits 3/4 inch copper
- Made from 316 stainless steel
- Full circle nitrile rubber gasket
- Pressure rating of 1600kPa
- Approved for use in potable water supply



Code: 5061 **\$46.92** inc. GST

REPAIR CLAMP FOR COPPER 25mm

- Stainless Steel Band Simple to install
- Suits 1 inch copper
- Made from 316 stainless steel
- Full circle nitrile rubber gasket
- Pressure rating of 1600kPa
- Approved for use in potable water supply



Code: 5062 **\$49.34** inc. GST

REPAIR CLAMP FOR COPPER 32mm

- Stainless Steel Band Simple to install
- Suit 1 1/4 inch copper
- Made from 316 stainless steel
- Full circle nitrile rubber gasket
- Pressure rating of 1600kPa
- Approved for use in potable water supply



Code: 5063 **\$53.74** inc. GST

FOR GAL PIPE

REPAIR CLAMP FOR GAL PIPE 20mm

- Stainless Steel Band simple to install
- Suits 3/4 inch galvanised pipe
- Made from 316 stainless steel
- Full circle nitrile rubber gasket
- Pressure rating of 1600kPa
- Approved for use in potable water supply



Code: 5064 **\$50.70** inc. GST

REPAIR CLAMP FOR GAL PIPE 25mm

- Stainless Steel Band simple to install
- Suits 1 inch galvanised pipe
- Made from 316 stainless steel
- Full circle nitrile rubber gasket
- Pressure rating of 1600kPa
- Approved for use in potable water supply



Code: 5065 **\$54.82** inc. GST

NEW

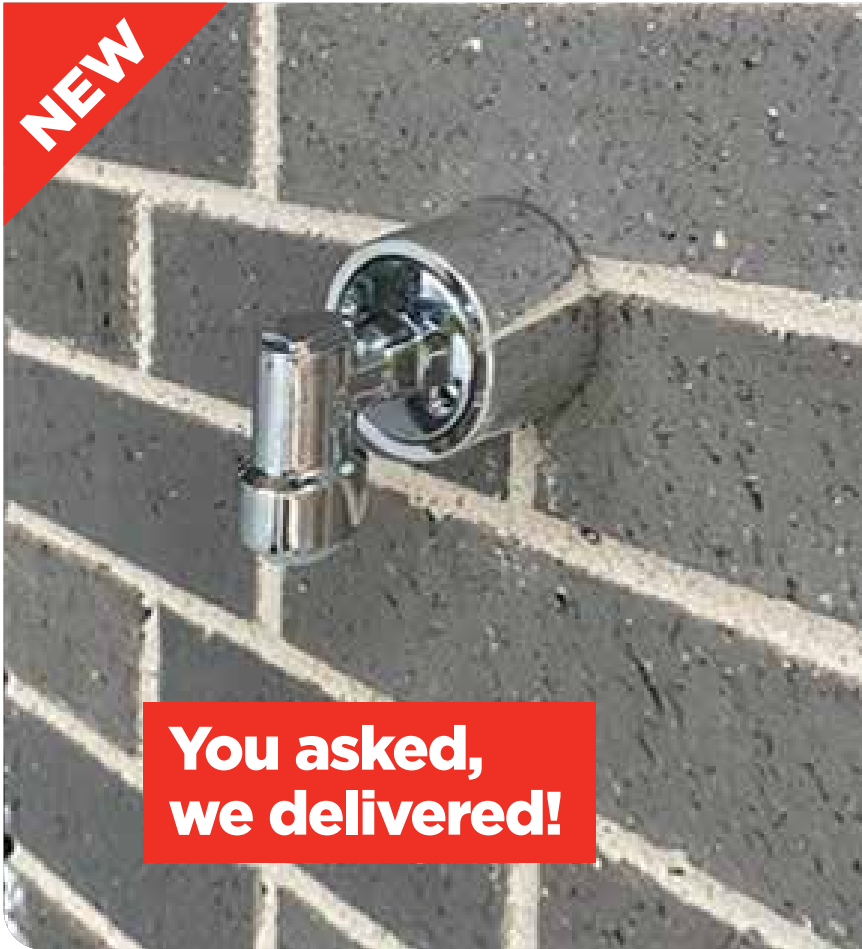

**You asked,
we delivered!**

Cover Plate for Bayonet Fitting

Code 6599

- The largest rise cover plate on the market.
- 39mm rise
- 1/2 inch BSP
- Ideal for bayonet gas fittings
- Fixing holes line up with bayonet



NEW



Rough Brass for Corrugated 1/2" BSP

Code 4005

- Foam backing moulds to any position on corrugate, Keeps bugs out
- Rough brass cover plate matches the hose bib to leave a professional finish
- Will not rust outdoors



SPECIAL

PRESS FITTINGS

PRESS WATER COUPLING

\$2.20
INC. GST

15mm Code: 8601

\$3.52
INC. GST

20mm Code: 8602



**BLOCKHEAD
PRESS WATER
ELBOW LUGGED
(90MM)**

\$11.00
INC. GST

15mm x 15M Code: 8699



PRESS WATER TEE

\$3.96
INC. GST

15mm Code: 8617

\$7.37
INC. GST

20mm Code: 8618



**PRESS WATER
ELBOW F/F**

\$2.53
INC. GST

15mm Code: 8607

\$4.29
INC. GST

20mm Code: 8608



**PRESS WATER SLIP
REPAIR COUPLING**

\$2.75
INC. GST

15mm Code: 8604

\$4.40
INC. GST

20mm Code: 8605



**PRESS WATER
MI ADAPTER**

\$3.85
INC. GST

15mm Code: 8633

\$7.26
INC. GST

20mm Code: 8634



Valid until 30th June 2022

COPPER & BRASS LARGE PRESS FITTINGS

32-50mm



ALWAYS
IN STOCK



PRESS GAS FITTINGS

CODE	SIZE
Press Gas Coupling	
7952	Press Gas Coupling 32mm
7953	Press Gas Coupling 40mm
7954	Press Gas Coupling 50mm
Press Gas Slip Repair Coupling	
7955	Press Gas Slip Repair Coupling 32mm
7956	Press Gas Slip Repair Coupling 40mm
7957	Press Gas Slip Repair Coupling 50mm
Press Gas Reducing Coupling F/F	
7958	Press Gas Reducing Coupling 32 x 20mm F/F
7959	Press Gas Reducing Coupling 32 x 25mm F/F
7960	Press Gas Reducing Coupling 40 x 25mm F/F
7961	Press Gas Reducing Coupling 40 x 32mm F/F
7962	Press Gas Reducing Coupling 50 x 25mm F/F
7963	Press Gas Reducing Coupling 50 x 32mm F/F
7964	Press Gas Reducing Coupling 50 x 40mm F/F
Press Gas Reducer M/F	
7965	Press Gas Reducer 32 x 20mm M/F
7966	Press Gas Reducer 32 x 25mm M/F
7967	Press Gas Reducer 40 x 25mm M/F
7968	Press Gas Reducer 40 x 32mm M/F
7969	Press Gas Reducer 50 x 25mm M/F
7970	Press Gas Reducer 50 x 32mm M/F
7971	Press Gas Reducer 50 x 40mm M/F
Press Gas Elbow F/F 90°	
7972	Press Gas Elbow 32mm x 90 F/F
7973	Press Gas Elbow 40mm x 90 F/F
7974	Press Gas Elbow 50mm x 90 F/F
Press Gas Elbow F/F 45°	
7975	Press Gas Elbow 32mm x 45 F/F
7976	Press Gas Elbow 40mm x 45 F/F
7977	Press Gas Elbow 50mm x 45 F/F
Press Gas Tee	
7978	Press Gas Tee 32mm
7979	Press Gas Tee 40mm
7980	Press Gas Tee 50mm
Press Gas Tee Reducing	
7981	Press Gas Tee 32 x 32 x 20
7982	Press Gas Tee 32 x 32 x 25
7983	Press Gas Tee 40 x 40 x 20
7984	Press Gas Tee 40 x 40 x 25
7985	Press Gas Tee 40 x 40 x 32
7986	Press Gas Tee 50 x 50 x 25
7987	Press Gas Tee 50 x 50 x 32
7988	Press Gas Tee 50 x 50 x 40
Press Gas End Cap	
7989	Press Gas End Cap 32mm
7990	Press Gas End Cap 40mm
7991	Press Gas End Cap 50mm
Press Gas Adaptor MI	
7992	Press Gas Adaptor 32mm x 32MI
7993	Press Gas Adaptor 40mm x 40MI
7994	Press Gas Adaptor 50mm x 50MI
Press Gas Adaptor FI	
7995	Press Gas Adaptor 32mm x 32FI
7996	Press Gas Adaptor 40mm x 40FI
7997	Press Gas Adaptor 50mm x 50FI

PRESS WATER FITTINGS

CODE	SIZE	CODE	SIZE
Press Water Coupling		Press Water Elbow M/F 90°	
7901	Press Water Coupling 32mm	7927	Press Water Elbow 32mm x 90 M/F
7902	Press Water Coupling 40mm	7928	Press Water Elbow 40mm x 90 M/F
7903	Press Water Coupling 50mm	7929	Press Water Elbow 50mm x 90 M/F
Press Water Slip Repair Coupling		Press Water Elbow F/F 45°	
7904	Press Water Slip Repair Coupling 32mm	7930	Press Water Elbow 32mm x 45 F/F
7905	Press Water Slip Repair Coupling 40mm	7931	Press Water Elbow 40mm x 45 F/F
7906	Press Water Slip Repair Coupling 50mm	7932	Press Water Elbow 50mm x 45 F/F
Press Water Reducing Coupling F/F		Press Water Tee	
7907	Press Water Reducing Coupling 32 x 20mm F/F	7933	Press Water Tee 32mm
7908	Press Water Reducing Coupling 32 x 25mm F/F	7934	Press Water Tee 40mm
7909	Press Water Reducing Coupling 40 x 20mm F/F	7935	Press Water Tee 50mm
7910	Press Water Reducing Coupling 40 x 25mm F/F	Press Water Tee Reducing	
7911	Press Water Reducing Coupling 40 x 32mm F/F	7936	Press Water Tee 32 x 32 x 20
7912	Press Water Reducing Coupling 50 x 20mm F/F	7937	Press Water Tee 32 x 32 x 25
7913	Press Water Reducing Coupling 50 x 25mm F/F	7938	Press Water Tee 40 x 40 x 25
7914	Press Water Reducing Coupling 50 x 32mm F/F	7939	Press Water Tee 40 x 40 x 32
7915	Press Water Reducing Coupling 50 x 40mm F/F	7940	Press Water Tee 50 x 50 x 25
Press Water Reducer M/F		7941	Press Water Tee 50 x 50 x 32
7916	Press Water Reducer 32 x 20mm M/F	7942	Press Water Tee 50 x 50 x 40
7917	Press Water Reducer 32 x 25mm M/F	Press Water End Cap	
7918	Press Water Reducer 40 x 20mm M/F	7943	Press Water End Cap 32mm
7919	Press Water Reducer 40 x 25mm M/F	7944	Press Water End Cap 40mm
7920	Press Water Reducer 40 x 32mm M/F	7945	Press Water End Cap 50mm
7921	Press Water Reducer 50 x 25mm M/F	Press Water Adaptor MI	
7922	Press Water Reducer 50 x 32mm M/F	7946	Press Water Adaptor 32mm x 32MI
7923	Press Water Reducer 50 x 40mm M/F	7947	Press Water Adaptor 40mm x 40MI
Press Water Elbow F/F 90°		7948	Press Water Adaptor 50mm x 50MI
7924	Press Water Elbow 32mm x 90 F/F	Press Water Adaptor FI	
7925	Press Water Elbow 40mm x 90 F/F	7949	Press Water Adaptor 32mm x 32FI
7926	Press Water Elbow 50mm x 90 F/F	7950	Press Water Adaptor 40mm x 40FI
		7951	Press Water Adaptor 50mm x 50FI



PRESS GAS FITTINGS



PRESS GAS COUPLING

CODE	SIZE	PRICE
8639	15mm	\$6.26
8640	20mm	\$8.04
8641	25mm	\$13.75



PRESS GAS SLIP REPAIR COUPLING

CODE	SIZE	PRICE
8642	15mm	\$6.00
8643	20mm	\$7.54
8644	25mm	\$11.69



PRESS GAS ELBOW F/F 90°

CODE	SIZE	PRICE
8645	15mm x 90	\$7.44
8646	20mm x 90	\$9.72
8647	25mm x 90	\$17.86



PRESS GAS ELBOW F/F 45°

CODE	SIZE	PRICE
8648	20mm x 45	\$11.60
8649	25mm x 45	\$15.46



PRESS GAS REDUCING COUPLING F/F

CODE	SIZE	PRICE
8650	20mm x 15mm	\$11.11
8651	25mm x 20mm	\$13.70



PRESS GAS REDUCER M/F

CODE	SIZE	PRICE
8652	20mm x 15mm	\$9.71
8653	25mm x 20mm	\$13.12



PRESS GAS TEE

CODE	SIZE	PRICE
8654	15mm	\$8.59
8655	20mm	\$14.81
8656	25mm	\$23.15



PRESS GAS TEE REDUCING

CODE	SIZE	PRICE
8657	20 x 20 x 15	\$15.29
8658	25 x 25 x 15	\$23.52
8659	25 x 25 x 20	\$26.00



PRESS GAS END CAP

CODE	SIZE	PRICE
8660	15mm	\$8.10
8661	20mm	\$9.13
8662	25mm	\$16.08



PRESS GAS ELBOW LUGGED

CODE	SIZE	PRICE
8663	15mm x 15FI	\$18.40
8664	20mm x 20FI	\$20.12



BLOCKHEAD PRESS GAS ELBOW LUGGED (90MM)

CODE	SIZE	PRICE
8698	15mm x 15MI	\$18.40



PRESS GAS ADAPTOR MI

CODE	SIZE	PRICE
8666	15mm x 15MI	\$5.51
8667	20mm x 20MI	\$13.59
8668	25mm x 25MI	\$21.39



PRESS GAS ADAPTOR FI

CODE	SIZE	PRICE
8669	15mm x 15FI	\$7.44
8670	20mm x 20FI	\$11.32
8671	25mm x 25FI	\$15.43

25 YEAR WARRANTY*

Brasshards is proud to offer a 25 year warranty against defects and manufacturing faults in CuPress fittings (when installed in accordance with national, state and local plumbing codes by a licensed plumber). Issues arising from incorrect installation, misuse or environmental elements are not covered by this warranty. Please contact Brasshards for a copy of our full warranty document.

PRESS WATER FITTINGS



PRESS WATER COUPLING

CODE	SIZE	PRICE
8601	15mm	\$4.14 <small>SPECIAL</small>
8602	20mm	\$6.13 <small>SPECIAL</small>
8603	25mm	\$8.70



PRESS WATER SLIP REPAIR COUPLING

CODE	SIZE	PRICE
8604	15mm	\$4.69 <small>SPECIAL</small>
8605	20mm	\$6.95 <small>SPECIAL</small>
8606	25mm	\$10.52



PRESS WATER ELBOW F/F 90°

CODE	SIZE	PRICE
8607	15mm x 90	\$4.69 <small>SPECIAL</small>
8608	20mm x 90	\$7.18 <small>SPECIAL</small>
8609	25mm x 90	\$13.24



PRESS WATER ELBOW F/F 45°

CODE	SIZE	PRICE
8610	15mm x 45	\$5.86
8611	20mm x 45	\$8.08
8612	25mm x 45	\$14.87



PRESS WATER ELBOW M/F 90°

CODE	SIZE	PRICE
8681	15mm	\$5.41
8682	20mm	\$7.11



PRESS WATER REDUCING COUPLING F/F

CODE	SIZE	PRICE
8613	20mm x 15mm	\$9.38
8614	25mm x 20mm	\$15.99



PRESS WATER REDUCER M/F

CODE	SIZE	PRICE
8615	20mm x 15mm	\$8.41
8616	25mm x 20mm	\$11.94



PRESS WATER END CAP

CODE	SIZE	PRICE
8623	15mm	\$7.43
8624	20mm	\$9.00
8625	25mm	\$17.63



PRESS WATER TEE

CODE	SIZE	PRICE
8617	15mm	\$7.23 <small>SPECIAL</small>
8618	20mm	\$10.90 <small>SPECIAL</small>
8619	25mm	\$20.21



PRESS WATER TEE REDUCING

CODE	SIZE	PRICE
8620	20 x 20 x 15	\$13.51
8621	25 x 25 x 15	\$19.12
8622	25 x 25 x 20	\$22.96
8683	20 x 15 x 15	\$17.84
8684	20 x 15 x 20	\$18.77

NEW



PRESS WATER SLIP TEE

CODE	SIZE	PRICE
8690	20mm	\$13.08



PRESS WATER ELBOW LUGGED

CODE	SIZE	PRICE
8626	15mm x 15FI	\$13.36
8627	20mm x 20FI	\$19.05



BLOCKHEAD PRESS WATER ELBOW LUGGED (90MM)

CODE	SIZE	PRICE
8699	15mm x 15MI	\$16.35 <small>SPECIAL</small>



PRESS WATER ELBOW FI

CODE	SIZE	PRICE
8629	15mm x 15FI	\$14.77
8630	20mm x 20FI	\$17.88



PRESS WATER ELBOW MI

CODE	SIZE	PRICE
8631	15mm x 15MI	\$14.23
8632	20mm x 20MI	\$17.89



PRESS WATER ELBOW UNION

CODE	SIZE	PRICE
8687	15mm x 1/2"	\$9.03
8688	20mm x 3/4"	\$13.64



PRESS WATER ADAPTOR MI

CODE	SIZE	PRICE
8633	15mm x 15MI	\$6.94 <small>SPECIAL</small>
8680	15mm x 20MI	\$10.60
8691	20mm x 15MI	\$12.67
8634	20mm x 20MI	\$11.47 <small>SPECIAL</small>
8635	25mm x 25MI	\$20.52



PRESS WATER ADAPTOR FI

CODE	SIZE	PRICE
8636	15mm x 15FI	\$6.59
8637	20mm x 20FI	\$8.41
8638	25mm x 25FI	\$14.99



PRESS UNION

CODE	SIZE	PRICE
8685	Loose Nut 15mm x 15mm Press (Flat Seat)	\$11.61
8679	Loose Nut 20mm x 20mm Press (Flat Seat)	\$11.75
8689	Loose Nut Compression 20mm x 20mm Press	\$10.54

- Flame-free
- Permanent V-Profile press join
- All fittings comply with Australian Standards AS3688



PRESS WATER SLIP TEE

20mm

- 25 year warranty*
- Permanent V-Profile press join profile
- Leak detection o-ring
- Complies with Australian Standards AS3688



EXCLUSIVE TO PLUMBERS CHOICE

\$13.08
INC. GST

CODE 8690

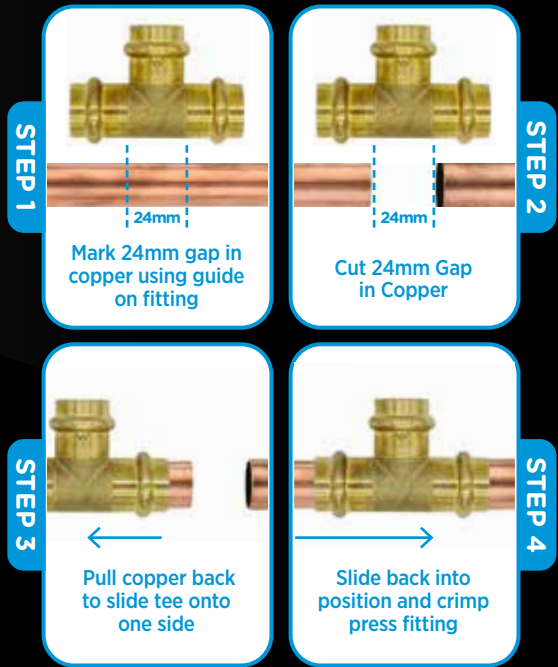

BLOCK HEAD

I HATE CUTTING NOGGINS, WHAT'S NOT TO LIKE?

Tim - Jonesy's Plumbing



SAME PRICE AS A TRADITIONAL LUGGIE!

- Reduce the number of noggins required
- Can press it while in place
- Fix it from any direction
- Lead free brass
- 25 year warranty

Blockhead Press Water Elbow Lugged
15mm x 15MI (90mm)
CODE: 8699

Blockhead Press Gas Elbow Lugged
15mm x 15MI (90mm)
CODE: 8698



TRADITIONAL FIX
PLUMBER'S NOGGIN



STUD FIX
FIX TO SIDE OF STUDS



EXISTING NOGGIN
FIX TO CARPENTER'S NOGGIN



PATENTED



| PLUMBING SUPPLIES SPECIALIST |